

Making Safety as Easy as 1, 2, 3...

1 HARNESS

What do I want?

Comfort. You want the perfect fit. To ensure a perfect fit, harnesses are available in different sizes. A standard size will fit most workers. See sizing selection chart to determine the best size for you.

Ease of Use. You want a harness that is easy for you to get into and adjust. Harnesses are available in primarily two styles:

- **Vestype (vest style).** A Vestype harness is put on like a jacket.
- **Pullover (cross-chest).** A pullover harness is put on over the head, similar to putting on a sweater.

The choice on style is a matter of personal preference.

There are also different types of **leg strap connections** available on a harness:

- **Qwik-Fit** (mating buckle)
- **Tongue Buckle**

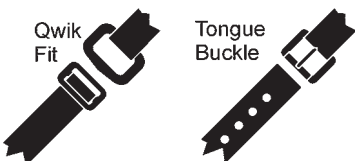

Both styles offer fast and easy connection and adjustment. *The choice of leg strap connections is a matter of personal preference.*

You also have a choice of **D-Ring configurations** on a harness: Back D-rings (required on every harness), hip (or side) D-rings, or chest D-rings. General D-ring usage is as follows:

- **Back D-Ring.** This is the attachment point for your lanyard. It can also be used as a rescue attachment.
- **Hip (or side) D-rings.** Typically used for workpositioning activities to allow the worker to have their hands free to perform work, or for travel restriction applications.
- **Chest D-ring.** Typically used for ladder climbing systems, rescue operations, or personnel riding applications.

2 LANYARD

How do I know which to choose?

There are two primary types of lanyards:

- **Shock-absorbing lanyards** used when the free fall distance (fall hazard) can exceed 2 feet
- **Restraint or positioning lanyards** used only when free fall distance (fall hazard) can be limited to 2 feet or less

In choosing the correct lanyard, you must **keep the application in mind.**

- Make certain the lanyard is the proper length to allow the necessary worker movement/positioning.
- Make certain that the right material type is chosen (depending on your work environment).
 - Cable works best in high heat environments or around sharp edges.
 - Webbing works best in most other applications.
- Make certain you have **calculated your total fall distance.** See diagram for more information.

You also need to consider the compatibility of the system components. Components produced by different manufacturers may not be interchangeable. The best way to ensure compatibility is to purchase all components from the same manufacturer.

3 CONNECTOR

How do I know which to choose?

Connector selection is **driven primarily by application.** You will need to carefully consider your work environment, in particular the type of structure where the connector will be attached.

Examples include:

- Roof
- Scaffold
- Steel Beam
- Concrete Column
- Rail

Weight should also be a consideration if a worker will need to carry the connector around during the work day.

You will also need to **consider the number of workers** required to attach to the connector. Most connectors are rated for 1 person with a 5,000 pound minimum breaking strength. Connectors are required, by OSHA, to have a minimum breaking strength of 5,000 pounds per person attached. For example, if you are going to attach 2 people to a connector, the connector must be rated to 10,000 pounds.

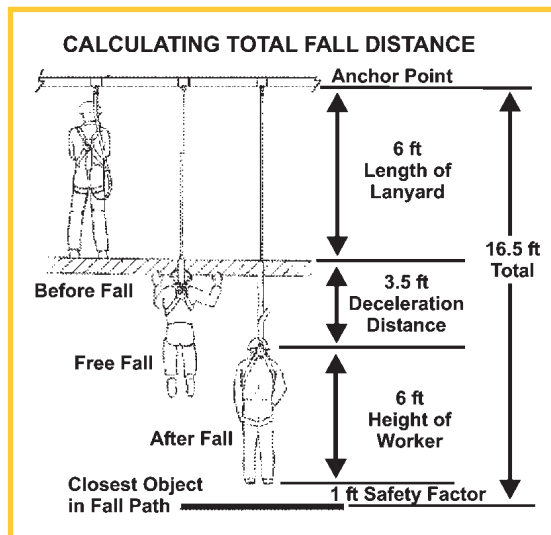

Fall Protection

Approvals and Standards

What is OSHA?

OSHA (Occupational Safety and Health Administration) rules and regulations are enforceable by law. Non-compliance with OSHA rules and regulations can result in stiff penalties and abatement periods.

What is ANSI?

ANSI (American National Standards Institute) is a voluntary standardization system and does not possess the ability to enforce its standards. ANSI facilitates development of national standards by establishing consensus among manufacturers and consumers. Many of OSHA's regulations are adopted from ANSI standards.

GENERAL FALL ARREST REQUIREMENTS

OSHA 29 CFR 1926.502 requires (but is not limited to):

- Body belts are not acceptable as part of a personal fall arrest system
- Only locking type snaphooks shall be used
- Anchorages used for attachment of personal fall arrest systems must be capable of supporting at least 5,000 lbs per employee attached
- Personal Fall Arrest systems shall be rigged such that an employee can neither free fall more than 6' nor contact any lower level

ANSI Z359.1 requires (but is not limited to):

- Snaphooks and carabiners shall be self-closing and self-locking
- Equipment shall be inspected by the user before each use and, additionally, by a competent person other than the user at intervals of no more than 1 year
- Prior to selecting a personal fall arrest system, the user shall make an assessment of workspace conditions where the equipment is required

Standards Update

STANDARDS UPDATE

Notice of Revision to the ANSI Z359 Standard for Personal Fall Arrest

New Standard to be Issued

The ANSI Z359 Accredited Standards Committee has completed work on a new series of fall protection standards to be published in August 2007, with an effective date of October 15, 2007. The new standards will replace the current ANSI Z359.1-1992(R1999). The current standard will be replaced by a series of five new standards:

- ANSI Z359.0-2007 Definitions
- ANSI Z359.1-2007 Fall Arrest Systems, Subsystems and Components
- ANSI Z359.2-2007 Minimum Requirements for a Comprehensive, Managed Fall Protection Program
- ANSI Z359.3-2007 Work Positioning and Travel Restriction Systems, Subsystems and Components
- ANSI Z359.4-2007 Assisted-Rescue and Self-Rescue Systems, Subsystems and Components

ANSI Z359.1-2007 includes two new requirements specific to lanyards:

- Snaphook and carabiner gate strength will increase to 3,600 pounds
- Twin-leg fall arrest lanyards will be tested to 5,000 pounds at the junction point where the lanyard legs come together.

The lanyards in this catalog on pages 157–162 comply with ANSI Z359.1-1992 (R1999). By the effective date of the new ANSI Z 359 family of standards MSA will have a new line of lanyards compliant to ANSI Z359.1-2007. Please check our website for a complete list of lanyards compliant to the new ANSI Z359.1-2007 standard and to learn more about the new ANSI Z359 family of standards.

1 HARNESS

OSHA 29 CFR 1926.502 requires (but is not limited to):

- D-Rings shall have a minimum breaking strength of 5,000 lbs
- D-Rings shall be proof tested to 3,600 lbs
- The attachment point of the harness shall be located in the center of the wearer's back near shoulder level
- Harnesses shall be used only for employee protection
- Harnesses subjected to impact loading must be removed from service

ANSI Z359.1 requires (but is not limited to):

- D-Rings, O-Rings, and oval rings shall be capable of withstanding a tensile load of 5,000 lbs
- Adjusters shall be capable of withstanding a tensile load of 4,000 lbs
- All D-Rings and O-Rings shall be subjected to proof load testing to 3,600 lbs
- The fall arrest attachment shall be located at the back (dorsal) position
- Harnesses subjected to impact loading must be removed from service

2 LANYARD

OSHA 29 CFR 1926.502 requires (but is not limited to):

- Lanyards shall have a minimum breaking strength of 5,000 lbs
- Snaphooks shall be sized to be compatible with the member to which they are connected to prevent unintentional disengagement of the snaphook
- Shock-Absorbing lanyards shall limit the maximum arresting force on an employee to 1,800 lbs when used with a body harness
- Shock-Absorbing Lanyards shall limit maximum deceleration distance to 3.5 feet.
- Lanyards subjected to impact loading must be removed from service

ANSI Z359.1 requires (but is not limited to):

- Lanyards shall have a minimum breaking strength of 5,000 lbs
- Snaphooks shall be sized to be compatible with the member to which they are connected to prevent unintentional disengagement of the snaphook
- Shock-Absorbing lanyards shall limit the maximum arresting force to 900 pounds
- Shock-Absorbing Lanyards shall limit maximum deceleration distance to 3.5 feet.
- Lanyards subjected to impact loading must be removed from service

3 CONNECTOR

OSHA 29 CFR 1926.502 requires (but is not limited to):

- D-Rings shall have a minimum breaking strength of 5,000 lbs
- D-Rings shall be proof tested to 3,600 lbs
- Connectors subjected to impact loading must be removed from service

ANSI Z359.1 requires (but is not limited to):

- Anchorage connectors shall be capable of withstanding a 5,000 lb load multiplied by the maximum number of personal fall arrest systems that may be attached to the anchorage connector
- An anchorage connector shall be attached to no more than one fall arrest system unless certified for such purpose.
- Connectors subjected to impact loading must be removed from service
- D-Rings, O-Rings, and oval rings shall be capable of withstanding a tensile load of 5,000 lbs

OSHA REGULATIONS UNDER TITLE 29 OF THE CODE OF FEDERAL REGULATIONS

OSHA's Occupational Safety and Health Standards for General Industry

Subpart D, Walking/Working Surfaces

- Fixed Ladders, Ladder Safety Devices _____ 1910.27 (d) (5)
- Safety Requirements for Scaffolding, Boatswain's Chairs _____ 1910.28 (j) (4)

Subpart F

- Powered Platforms and Building Maintenance _____ 1910.66
- Personal Fall Arrest Systems _____ 1910.66, Appendix C

Subpart R

- Agricultural Operations _____ 1910.267
- Telecommunications _____ 1910.268
- Electric Power Generation, Transmission and Distribution _____ 1910.269

OSHA's Safety and Health Standards for Construction

Subpart E, Personal Protective Equipment

- Safety Belts, Lifelines and Lanyards _____ 1926.104
- Safety Requirements for Scaffolding, Boatswain's Chairs _____ 1926.105

Subpart L, Scaffolding

- Boatswain's Chairs _____ 1926.450-454

Subpart M, Fall Protection

- Scope, Application and Definitions _____ 1926.500
- Duty to Have Fall Protection _____ 1926.501
- Scope, Application and Definitions _____ 1926.502
- Duty to Have Fall Protection _____ 1926.503

Subpart R, Scaffolding

- Fall Protection _____ 1926.750

- Subpart M, Ladders _____ 1926.1053

ANSI Voluntary Consensus Standards

Fall Protection Systems for Construction and Demolition Operations

Fall Protection Systems for Construction and Demolition Operations _____ A10.32-2004

General Industry

Minimum Safety Requirements for Personal Fall Arrest Systems, Subsystems and Components _____ Z359.1-1992 (R1999)
Ladders—Fixed—Safety Requirements _____ A14.3-1992

New ANSI Z Requirements go into effect October 15, 2007. Check www.MSAnet.com for updates and details.

Fall Protection

Harnesses

TechnaCurv™ Full Body Harness

The TechnaCurv Full Body Harness throws a curve to the ordinary harness with many new features never before seen in a full body harness:

- Curvilinear Comfort System
- Visco-Elastic Shoulder padding
- Innovative web design
- Secure-Fit buckles
- Sorbtek fabric on shoulder and sub-pelvic pads
- Meets ANSI Z359.1, A10.32, all applicable OSHA regulations, and is CSA certified



In addition to the features above, the TechnaCurv harness is designed with downward adjusting torso straps on most models to ease adjustment. This is also the first harness on the market that allows you to order exactly the options you want, and only the options you want, through our Assemble-to-Order process. All these features combine to provide you with the most comfortable, versatile, unique, and safe harness available today.

And now, we're making a great harness even better! You will notice a few changes on your TechnaCurv Harness that will improve the functionality and comfort of the harness. These improvements include:

- + Addition of two Lanyard Clips on every harness, at no additional cost.
- + Addition of webbing length to the torso and leg strap portions of the harness to give you a wider range of adjustment. These additions will provide you with the perfect, most comfortable fit every time you put on your harness.

the CURVILINEAR COMFORT SYSTEM features:

Curvilinear Torso Webbing

- This patent-pending process curves the webbing around the neck area to help prevent chafing and discomfort on the neck that can be caused by some standard harnesses.

COMBINED WITH

Adjustable Y Back D-Locator Pad

- Allows complete adjustment of the back D-ring to provide proper harness fit
- Assists in moving the shoulder webbing away from the neck, providing additional comfort to the user.
- Ribbed web slots in back pad allow for easy back D Ring adjustment.
- A special polymer blend allows for optimal strength and minimal weight, giving you a lighter, more durable harness.

TO PROVIDE YOU WITH TOTAL COMFORT!



Webbing

- Soft, Flexible webbing allows the harness to move with you as you work for increased comfort.
- An innovative pattern design offers a cool, sporty appearance.



Shoulder Pads & Sub-pelvic Pad

Sorbtek™ Fabric:

- A highly breathable, lightweight material designed to wick moisture away from the body.

Visco-Elastic Shoulder Padding:

- Developed by NASA, Visco-elastic padding is more comfortable than traditional foam padding.
- Does not have memory and will not break down over time, offering superior comfort throughout the life of the harness.
- Automatically adjusts to every curve of your body

Secure-Fit™ Buckle

- Designed to ease donning, doffing, and adjustment.
- Single hand operation.
- Buckle release tabs move in opposite directions and are recessed inside the outer buckle dimensions to prevent accidental disengagement.
- Positive engagement windows allow you to see that the buckle is properly engaged. No need to try and listen for a "click" on a noisy job site.



Positive Engagement Window

Variable Width Webbing

- Width varies from 1-5/8" to 2-5/8".
- Distributes weight over a wider surface area to increase comfort during suspension/work positioning.

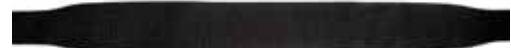

TechnaCurv Full Body Harnesses

Part No.	STYLE		PADDING		CHEST BUCKLE		LEG BUCKLES			D-RINGS		
	Pullover	Vesttype	Shoulder	Sub-Pelvic	Secure-Fit	Qwik-Fit	Secure-Fit	Tongue	Qwik-Fit	Back	Chest	Hip
10041517		X				X			X	1	0	0
10041518	X								X	1	0	0
10041591		X				X		X		1	0	0
10041595		X				X		X		1	0	2
10041597	X							X		1	0	2
10041599		X	X			X		X		1	0	0
10041601	X		X					X		1	0	0
10041603		X	X			X		X		1	0	2
10041607		X				X		X		1	1	2
10041609	X							X		1	1	2
10041611		X	X			X		X		1	1	2
10041613	X		X					X		1	1	2
10041615		X	X	X		X	X			1	1	2
10041617	X		X	X			X			1	1	2
10052991		X	X			X			X	1	0	0
10052992		X	X		X				X	1	0	0
10052993		X	X			X		X		1	0	0
10052994		X	X		X			X		1	0	0
10052995		X	X		X		X			1	0	0
10052996		X	X			X			X	1	0	2
10052997		X	X		X				X	1	0	2
10052998		X	X			X		X		1	0	2
10052999		X	X		X			X		1	0	2
10053000		X	X		X		X			1	0	2

All harnesses listed here are Standard (STD) size. Other sizes are available.

TechnaCurv Tower Harness

In addition to the exciting features of the TechnaCurv Harness, the TechnaCurv Tower Harness:

- Utilizes variable width webbing in the sub-pelvic area to increase comfort and support when work positioning
- Incorporates an integral body belt and a removable saddle
 - Body Belt and saddle are constructed using a dual durometer pad and Sorbtek fabric for ultimate comfort
 - Body Belt includes two side D-rings and two accessory rings
 - Removable Saddle includes two side D-rings
 - ❖ Saddle height is adjustable
- D-ring position is adjustable



TechnaCurv Tower Harnesses include body belt and saddle.

Part No.	STYLE		PADDING		CHEST BUCKLE		LEG BUCKLES			D-RINGS		
	Vesttype	Shoulder	Sub-Pelvic	Qwik-Fit	Secure-Fit	Tongue	Back	Chest	Hip			
10048344	X	X	X	X	X	X		1	1	2		
10048348	X	X		X	X		X	1	1	2		

All harnesses listed here are Standard (STD) size. Other sizes are available.

Fall Protection



TechnaCurv Construction Harness with Belt Loops
Part No. 10053004

Belt Loops



TechnaCurv Construction Harnesses

TechnaCurv Construction Harnesses offer all of the exciting features of the TechnaCurv Harness with the added flexibility of incorporating a tool belt. There are two construction harnesses to choose from:

- With integral belt that includes a Dual Durometer back pad for superior comfort
- With Belt Loops for total flexibility of adding any belt of your choice



TechnaCurv Construction Harness with Belt
Part No. 10054403

TechnaCurv Construction Harnesses include integral belt loops.

Part No.	STYLE	PADDING	CHEST BUCKLE		LEG BUCKLES			BELT LOOPS		D-RINGS	
	Vesttype	Shoulder	Secure-Fit	Qwik-Fit	Secure-Fit	Tongue	Qwik-Fit	w/o belt	w/integral belt	Back	Hip
10053001	X	X		X			X	X		1	0
10053002	X	X	X				X	X		1	0
10053003	X	X		X		X		X		1	0
10053004	X	X	X			X		X		1	0
10053005	X	X	X		X			X		1	0
10053006	X	X		X			X	X		1	2
10053007	X	X	X				X	X		1	2
10053008	X	X		X		X		X		1	2
10053009	X	X	X			X		X		1	2
10053010	X	X	X		X			X		1	2
10054402	X	X		X		X			X	1	2
10054403	X	X	X			X			X	1	2
10054719	X	X	X		X				X	1	2

All harnesses listed here are Standard (STD) size. Other sizes are available.

TechnaCurv “No Metal Above the Waist” Harnesses

This harness was designed to keep all metal below the waist to reduce the potential for arc flashes. This potential is further reduced by adding the plastic covers over the metal components of the harness. In addition to the many features of the TechnaCurv Full Body Harness, the No Metal Above the Waist TechnaCurv Harness adds the following features:

- Fabric dorsal connector
- Fabric positioning loops
- Hardware covers on metal components
- Approximate weight is just 3.5 lbs
- Meets or exceeds OSHA, ANSI Z359.1, and is CSA certified



“No Metal Above the Waist”
TechnaCurv Harness
Part No. 10050125

TechnaCurv “No Metal Above the Waist” Harnesses

Part No.	STYLE	LEG BUCKLES			ATTACHMENT POINT
	Pullover	Secure-Fit	Tongue	Qwik-Fit	Back
10050125	X	X			1
10053251	X			X	1
10059270	X		X		1

Technacurv® Hi-Viz Construction Harness

This harness features:

- Curvilinear Comfort System combines curvilinear torso webbing with an adjustable Y back D-locator pad to keep the shoulder webbing away from the neck to prevent chaffing and to provide greater comfort
- Bright green webbing for greater visibility
- Visco Elastic Shoulder Padding automatically adjusts to every curve of your body, offering superior comfort throughout the life of the harness
- Sorbtek fabric on the shoulder padding wicks moisture away from the body
- Integral belt with Dual-Durometer back pad for superior comfort and back support
- Designed with downward adjusting torso straps to ease adjustments
- Soft, flexible webbing allows the harness to move with you as you work for increased comfort
- Utilizes variable-width webbing in the sub-pelvic area to increase comfort and support during suspension/work positioning
- Additional webbing length to the torso and leg straps provides a wider range of adjustments for the perfect fit
- Two integral Lanyard Clips
- Meets or exceeds OSHA regulations, ANSI Z359.1 and is CSA certified.



TechnaCurv Hi-Viz Construction Harness
Part No. 10063654

*Webbing does not meet the requirements for high-visibility clothing as defined in OSHA and ANSI.

Part No.	SIZE		STYLE	PADDING	CHEST BUCKLE	LEG BUCKLES	D-RINGS	
	STD	XLG	Vestype	Shoulder	Qwik-Fit	Tongue	Back	Hip
10063654	X		X	X	X	X	1	2
10063656		X	X	X	X	X	1	2

Technacurv® Picker's Harness

Available with all the exciting features of the TechnaCurv Harness, plus:

- 18" Integral Dorsal D-Extension with velcro closure provides easy access to the Back D-ring
- Dorsal D-Extension available as option 3 under the Dorsal D-option of the Assemble-to-Order Matrix

Part No.	Description
ANGHN151221331002	TechnaCurv Picker's Harness



TechnaCurv Picker's Harness
Part No. ANGHN151221331002

Fall Protection

Workman™ Harness

The Workman Harness provides comfortable protection, due to its lightweight components and durable webbing. The vest-style harness, with optional hip D-Rings for work positioning, fits a wide range of body types and sizes. Color-contrasting thigh and torso straps simplify donning.

- Optimum quality at an economical price
- Comfortable
- Abrasion-resistant, strong, durable webbing
- Yellow polyester webbing for high visibility
- Web retainer collars to keep excess webbing neat
- Easy to don and adjust
- Choice of Qwik-Fit™ or Tongue-Buckle leg straps for easy adjustment
- Instructions in English, Spanish, and French
- Meets OSHA regulations, ANSI A10.32 & ANSI Z359.1, and is certified to CSA Z259.10-M90



Workman Harness
Part No. 10072479



Stand-Up
Back
D-Ring



Workman Harness
Part No. 10072491

Part No.	SIZE				CHEST STRAP	LEG BUCKLES		ATTACHMENT POINTS		INTEGRAL BACK PAD & TOOL BELT	SHOULDER PADS
	XSM	STD	XLG	SLX	Qwik-Fit	Tongue	Qwik-Fit	Back	Hip		
10072479		X			X	X		X			
10072480			X		X	X		X			
10072483		X			X	X		X	X		
10072484			X		X	X		X	X		
10072487		X			X		X	X			
10072488			X		X		X	X			
10072491		X			X		X	X	X		
10072492			X		X		X	X	X		
10072494	X				X		X	X	X	X	
10072495		X			X		X	X	X	X	
10072496			X		X		X	X	X	X	
10072497				X	X		X	X	X	X	
10077490	X				X		X	X	X	X	X
10077571		X			X		X	X	X	X	X
10077572			X		X		X	X	X	X	X
10077573				X	X		X	X	X	X	X

Workman™ Construction Harness

The Workman Construction Harness also offers shoulder pads and an integral backpad for added comfort during work positioning and a removable, tongue-buckle tool belt. Meets applicable OSHA regulations, ANSI A10.32 and ANSI Z359.1 requirements.

New!



Workman
Construction
Harness
Part No. 10077571

FP Pro® Harness

The FP Pro Harness provides comfortable protection even after long hours of use in extreme conditions due to its super lightweight features and durable webbing. The harness is available in cross-chest and vest styles, with optional hip D-rings for work positioning, and fits a wide range of body types and sizes. Color-contrasting thigh and torso straps simplify donning. The FP Pro Harness has the following features :

- Bright red polyester webbing for high visibility
- Meets all applicable OSHA standards, ANSI A10.32, and ANSI Z359.1
- Lightweight design for increased comfort



Part No.	STYLE		SIZE		LEG BUCKLES		INTEGRAL BELT & BACK PAD	D-RINGS	
	Cross-Chest	Vest Style	STD	XLG	Tongue	Qwik-Fit		Back	Hip
415842	X		X			X		1	0
415844	X			X		X		1	0
415944	X		X			X		1	2
415946	X			X		X		1	2
415947		X	X			X		1	0
415949		X		X		X		1	0
415950		X	X			X		1	2
415952		X		X		X		1	2
10033830	X		X		X			1	0
10033831	X			X	X			1	0
10033833	X		X		X			1	2
10033834	X			X	X			1	2
10033836		X	X		X			1	0
10033837		X		X	X			1	0
10033839		X	X		X			1	2
10033840		X		X	X			1	2
10043033		X	X		X		X	1	2
10057087		X		X	X		X	1	2

Additional sizes available.

Fall Protection



Gravity Vest Style
Harness
Part No. SSH30420060

Gravity™ Vest Style Harness

The Gravity Vest Style Harness design is the traditional choice for confined space rescue and fall arrest. The back D-ring ensures the user is in an up-right position, eliminating the need for shoulder D-rings and a spreader bar for confined space applications. Available in nylon, polyester, and reflective nylon. Tongue buckle leg straps available upon request. Meets ANSI Z 359.1 and OSHA standards, and is CSA certified.



Gravity Harness with
Reflective Nylon
Part No. SSH80920006

Gravity™ Cross-Over Harness

The Gravity Cross-Over Harness is a multi-purpose full body harness. The unique cross-over design allows for adjustment of both the back and chest D-rings. The harness is suitable for controlled descent, positioning, ladder climbing, rescue, and fall arrest. Available in nylon, polyester, and reflective nylon. Meets ANSI Z 359.1 and OSHA standards, and is CSA certified.



Reflective Orange
Nylon

Part No.	STYLE		WEBBING		LEG BUCKLES		REFLECTIVE		D-RINGS		
	Vesttype	Cross-Chest	Nylon	Polyester	Tongue	Qwik-Fit	Orange	Yellow	Back	Chest	Hip
SSH30420060	X		X			X			1	0	0
SSH30425060	X		X		X				1	0	0
SSH30430064	X			X		X			1	0	0
SSH30435064	X			X	X				1	0	0
SSH70920006		X	X			X		X	1	0	0
SSH70920008		X	X			X	X		1	0	0
SSH80920000		X	X			X			1	1	2
SSH80925000		X	X		X				1	1	2

Nylon Harnesses are constructed with red/blue webbing, and polyester harnesses are constructed with red/black webbing. All harnesses listed above are Standard (STD) size. Additional sizes available. All harnesses listed above have Qwik-Fit chest straps.

Derrick™ Harness

The Derrick harness was created with the derrick worker in mind. This harness incorporates an integral shock absorber that also serves as a back D-ring extension to allow for easy lanyard connection. The integral belt consists of a 4" wide web support strap and a rear D-ring for positioning/restraint applications. The harness also includes a comfortable saddle for positioning and climb assist. Meets ANSI Z359.1, ANSI A10.14, and OSHA standards, and is CSA certified.



Derrick Harness
Part No. SSH31535C

Part No.	Description	Waist
SSH31535D364	Derrick Harness, Vest Style, tongue buckle leg straps, red/black polyester webbing, large belt	40"-48"

All harnesses listed above are Standard (STD) size. Additional sizes available.

BUCKLE INFORMATION



Friction Buckle



Tongue Buckle



Qwik-Fit™ (Mating) Buckle

ArcSafe™ Harness

The ArcSafe harness is SEI-certified to the requirements of the ASTM F887-05 standard for arc flash protection up to 40 cal/cm² and is designed to meet the needs of utility and maintenance workers.

Additional features

For safety:

- Nylon web loop attachment points
- Reduce overall harness weight
- Reduce metallic components
- Meets all applicable OSHA regulations and ANSI Z359.1 & A10.32 standards
- Certified to CSA Z259.10-M90 classes A, D, L, P

For versatility & comfort:

- Y-shaped back web loop locator pad
- Allows for effortless adjustment of the back web loop
- Provides comfort by moving the webbing away from the wearer's neck
- Color-coded torso straps to simplify donning
- Downward-adjusting torso straps to ease adjustment
- Optional integral shock-absorber
- Choice of Vest or Cross-Chest harness style
- Choice of Qwik-Fit or Tongue Buckle leg straps
- Optional front attachment loops for climbing, personnel riding, or rescue applications

Optional Integral Shock-Absorber



ArcSafe Cross-Chest Harness

ArcSafe Vest-Style Harness

ArcSafe Chest-Style Harnesses

All styles include Back Web Loops

Part No.	SIZE		LEG BUCKLES		ATTACHMENT POINTS		INTEGRAL SHOCK ABSORBER	BELT LOOPS
	STD	XLG	Qwik-Fit	Tongue	Hip	Front		
10070459	X			X	X			X
10070460		X		X	X			X
10070463	X			X	X	X		
10070464		X		X	X	X		
10070467	X			X	X		X	
10070468		X		X	X		X	
10070471	X		X		X	X		
10070472		X	X		X	X		
10070475	X			X				
10070476		X		X				
10070479	X			X			X	X
10070480		X		X			X	X
10060114	X		X			X	X	
10060115		X	X			X	X	
10060110	X		X			X		
10060111		X	X			X		
10060105	X		X				X	
10060106		X	X				X	
10060101	X		X					
10060102		X	X					
10074530	X		X		X			
10074561		X	X		X			
10074564	X		X		X		X	
10074565		X	X		X		X	

ArcSafe Vest-Style Harnesses

All styles include Back Web Loops and Qwik-Fit Chest Strap

Part No.	SIZE		LEG BUCKLES		ATTACHMENT POINTS		INTEGRAL SHOCK ABSORBER	BELT LOOPS
	STD	XLG	Qwik-Fit	Tongue	Hip	Front		
10070423	X			X	X	X		
10070424		X		X	X	X		
10070427	X			X				
10070428		X		X				
10070431	X		X					
10070432		X	X					
10070435	X		X				X	
10070436		X	X				X	
10070439	X		X		X	X		
10070440		X	X		X	X		
10070443	X		X		X			
10070444		X		X	X			
10070447	X			X		X	X	X
10070448		X		X		X	X	X
10070451	X			X	X			X
10040425		X		X	X			X

Fall Protection

Thermatek™ Harness

The Thermatek Harness is a Vest Style harness with many features, including:

- High visibility green webbing
- Kevlar (60%) / Nomex (40%) blend webbing that is resistant to chemicals, weld splatter, and other high heat applications
- Bright, contrasting colors of webbing and stitching allows for easier inspection
- Qwik-Fit Leg Straps for easy connection
- Meets ANSI A10.14 and OSHA standards
- CSA certified
- SEI certified



Part No.	CSA Part No.	Description	Back	Hip
10020062	10020068	Standard size, Qwik-Fit (mating) leg straps	1	2
10020066	10020070	X-Large size, Qwik-Fit (mating) leg straps	1	2



Thermatek Harness
Part No. 10020062

“No Metal Above the Waist” Harness

The “No Metal Above the Waist” Harness is a pullover style harness specifically designed with the utility industry worker in mind. This comfortable pullover style harness provides easy donning and doffing and one-point adjustment. In order to maintain a “No Metal Above the Waist” configuration, this harness has the adjustment point below the waist and an Integral Dyna-Brake Shock Absorber at the back D-ring location eliminating metal at the dorsal connection point.

“No Metal Above the Waist” Harness is available with side positioning loops for work positioning and travel restriction applications. All variations of the “No Metal Above the Waist” Harness meet ANSI Z359.1, ANSI A10.14, and OSHA regulations.

Part No.	Description	Back	Hip
501390	Standard size, nylon, Integral Dyna-Brake Shock Absorber, tongue buckle leg straps	1	2
415211	X-Large size, nylon, Integral Dyna-Brake Shock Absorber, tongue buckle leg straps	1	2



“No Metal Above the Waist”
Harness
Part No. 501390

Additional sizes available.

Harness Accessories

Miscellaneous Harness Accessories

A Back Pad (P/N 507144) snaps into the hip D-rings of Pullover and Vesttype Harnesses and adds additional lower lumbar support while work positioning. Shoulder pad (P/N 10028444) may be snapped around the shoulder straps and under the back D-ring pad of the harness to add comfort.



Double D-ring Extension
Part No. 10043147

Back Pad
Part No. 507144



Lanyard Connector Adapter
Part No. 505318



Shoulder Pad
Part No. 10028444

Part No.	Description
505318	Lanyard Connector Adapter, nylon, 1 D-ring, 18” (Back D-Ring Extension)
507144	Economic Back Support Pad, nylon
10028444	Shoulder pad
10043147	Double D-ring Extension

Body Belts

MSA lightweight body belts are used for travel restriction or work positioning. Body belts are available in nylon or polyester webbing. Unique single pass friction buckles allow for a wide range of waist adjustment while tongue buckles adjust to a specific waist size. A 3 or 4 inch wide body pad is available on most models for additional comfort while work positioning. D-rings are available on the back of the belt for travel restriction and on the hips for work positioning. Multi-purpose body belts include a 3-inch wide body pad and seat strap which provides for additional comfort while work positioning for long periods of time.

Part No.	Size	Description
415275	Large	Nylon, tongue buckle, 3” body pad, 2 fixed D-rings
415276	Medium	Nylon, tongue buckle, 3” body pad, 2 fixed D-rings
415289	Large	Nylon, tongue buckle, 3” body pad, 1 fixed D-ring
415290	Medium	Nylon, tongue buckle, 3” body pad, 1 fixed D-ring

Part No. 415276

- Tongue buckle nylon belt
- 2 fixed D-rings
- 3” body pad



Shock-Absorbing Lanyards

Energy absorbing lanyards are a component of a personal fall arrest system. They provide a means of connection between the back (dorsal) D-ring of MSA full body harnesses and a qualified anchorage and anchorage connector. The energy absorber keeps fall arrest forces below ANSI and OSHA limits and deceleration distance is controlled to a maximum of 42 inches. The lanyard is available in strap, rope, and wire rope configurations with a variety of snaphooks.

Workman™ Energy-Absorbing Lanyards

Workman energy-absorbing lanyards are lightweight with a low-profile body. The shock absorber includes a clear, durable protective cover over the labels to increase service life and allow for easy inspection.

Features

- Tear-tape design to keep fall arrest forces below 900 lbf.
- Choice of single or twin-leg configurations
- Choice of adjustable or tie-back configurations
- Meets ANSI Z359.1-1992 (R1999), ANSI A10.32, applicable OSHA regulations, and is certified to CSA Z259.11-05 E4



Workman Energy-Absorbing Lanyard
Part No. 10072472



Workman Energy-Absorbing Lanyard
Part No. 10072474



Workman Energy-Absorbing Lanyard
Part No. 10076124



Workman Energy-Absorbing Lanyard
Part No. 10072473



Workman Energy-Absorbing Lanyard
Part No. 10073708



Workman Energy-Absorbing Lanyard
Part No. 10072475

Workman Shock-Absorbing Lanyards

Part No.	Harness Connection	Anchorage Connection	Twin	Single	Tie-Back
10072472	LC	LC		X	X
10072473	LC	(2) LC	X		X
10072474	LC	LC		X	
10073708	LC	(2) LC	X		
10072475	LC	(2) GL3100	X		
10076124	LC	GL3100		X	

ArcSafe™ Shock-Absorbing Lanyard

The ArcSafe shock-absorbing lanyard is SEI-certified to the requirements of the ASTM F887-05 standard for electrical arc flash protection up to 40 cal/cm².

- Limits fall arrest forces to 900 lbf or less
- Constructed of nylon webbing
- Includes sewn loop on shock-absorber end, and LS snaphook on lanyard leg
- Incorporates a protective cover over the shock-absorber
- Adjustable in length
- Choice of single- or twin-leg versions



ArcSafe Single-Leg Shock-Absorbing Lanyard



ArcSafe Twin-Leg Shock-Absorbing Lanyard

Part No.	Harness Connection	Anchorage Connection	Twin	Single
10060139	Sewn Loop	LS Snap		X
10060140	Sewn Loop	(2) LS Snap	X	

Fall Protection

FP5K™ Tie-Back Shock-Absorbing Lanyard

- Uses the FP5K Carabiner, a new Tie-back lanyard connector
 - 5000-pound gate strength in any direction allows the FP5K Carabiner to be tied back directly to the lanyard
 - Unique carabiner body shape helps avoid confusion with standard connectors not designed for tie-back applications
 - FP5K carabiner design allows for maximum clearance inside the body of the carabiner (1" Gate Opening)
- Available in web or cable version
- Web version utilizes Monster-Edge™ Webbing with 12,000-pound minimum breaking strength
 - Monster-Edge webbing is designed for increased abrasion resistance
 - Internal wear indicator consists of two yellow threads that, when visible, alert a user as to when the lanyard should be removed from service due to severe abrasion
- Utilizes the Sure-Stop Shock Absorber to keep fall arrest forces below 900 lbf
- Available in both single and twin-leg configurations
- Meets OSHA regulations, ANSI Z359.1-1992 (R1999), ANSI A10.32 and is CSA certified.



Section of Monster Edge Webbing

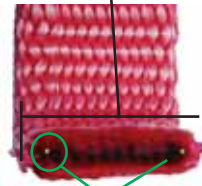

Internal wear indicator

Specially designed safety recess inside the body of the carabiner provides a place for the lanyard to rest when tied back.

5000-pound gate strength in any direction.

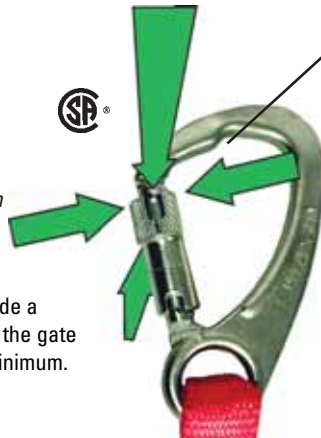

FP5K Carabiner

The outer side of the gate has a knurled surface to provide a secure grip on the gate when opening. The inner side of the gate has flattened edges to keep lanyard/gate contact at a minimum.



Part No. 10047084



Part No. 10047085



Part No. 10056762



Part No. 10056763

Part No.	Description
10047084	FP5K Tie-Back Lanyard, Nylon Web, 6' Adjustable Length, with HL2000 snaphook on one end and FP5K Carabiner on the other end
10047085	Twin-leg FP5K Tie-Back Lanyard, Nylon Web, 6' Adjustable Length, with HL2000 snaphook in center (attaches to back D-ring) and FP5K Carabiners on each leg.
10047086	FP5K Tie-Back Lanyard, Cable, 6' Fixed Length, with HL2000 snaphook on one end and FP5K Carabiner on the other end
10047087	Twin-leg FP5K Tie-Back Lanyard, Cable, 6' Fixed Length, with HL2000 snaphook in center (attaches to back D-ring) and FP5K Carabiners on each leg
10052549	FP5K Tie-Back Lanyard, Nylon Web, 6' Adjustable Length, with LS snaphook on one end and FP5K Carabiner on the other end
10052611	Twin-leg FP5K Tie-Back Lanyard, Nylon Web, 6' Adjustable Length, with LS snaphook in center (attaches to back D-ring) and FP5K Carabiners on each leg.
10056762	FP5K Tie-Back Restraint Lanyard, Nylon Web, 5' Adjustable Length, with LS snaphook on one end and FP5K Carabiner on other end
10056763	Twin-leg FP5K Tie-Back Restraint Lanyard, Nylon Web, 5' Fixed Length, with LS snaphook in center (attaches to back D-ring) and FP5K Carabiners on each leg

FP Diamond™ Shock-Absorbing Lanyard

The FP Diamond Shock-Absorbing Lanyard raises the standard for shock-absorbing lanyards with these exciting features:

- Durable polyester sheath for increased abrasion and UV resistance
- Keeps fall arrest forces below 900 lbf
- Available in a single or twin-leg configuration
- Highly visible deployment tag
- Pouchless design
 - More comfortable to wear
 - Lighter weight
- ATO ordering flexibility allows you to order the exact options, and only the options, you want
- Meets OSHA regulations, ANSI Z359.1-1992 (R1999), ANSI A10.32, and is CSA certified 

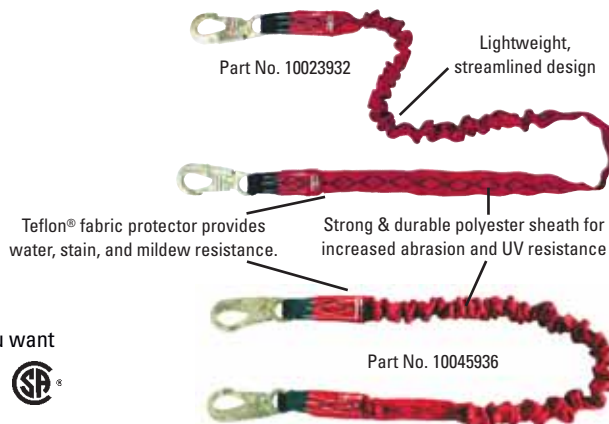

FP Diamond Expanyard

In addition to the exciting features of the FP Diamond Lanyard, the FP Diamond Expanyard features:

- Elastic design reduces trip hazards and snag hazards
- 6' Diamond Expanyard contracts to 4.5'

FP Diamond with Integral D-ring Extension

In addition to the exciting features of the FP Diamond Lanyard, the FP Diamond with Integral D-ring Extension features:

- 100% tie-off while transitioning from the use of the shock-absorbing lanyard to the use of a self-retracting lanyard and vice-versa
- 4-1/2' length
- GL3100 snaphooks on anchor end of the shock-absorbing legs are compatible with most concrete forms allowing for a variety of applications
- Dorsal D-ring attachment on short leg allows easy access to back D-ring when connecting to a self-retracting lanyard



Swivel Snaphook on the Twin-leg FP Diamond Lanyard prevents the lanyard from tangling during use.

Polyester, single piece construction, fixed length, Shock-Absorbing Lanyard

Part No.	Harness Connection	Anchorage Connection	Expanyard	Twin-Leg	D-ring Extension	4.5'	5'	6'
10023932	HL2000	HL2000						X
10023933	HL2000	HL64						X
10023970	Swivel HL2000	(2) HL2000		X				X
10023971	Swivel HL2000	(2) HL64		X				X
10023936	HL2000	HL2000					X	
10023937	Swivel HL2000	(2) HL2000		X			X	
10045936	HL2000	HL2000	X					X
10045938	Swivel HL2000	(2) HL64	X	X				X
10047290	Swivel HL2000	(2) GL3100	X	X				X
10053011	LS Snap	LS Snap						X
10053012	LS Snap	GL3100						X
10053013	LS Snap	(2) GL3100		X				X
10053014	LS Snap	LS Snap	X					X
10053015	LS Snap	GL3100	X					X
10053016	LS Snap	(2) GL3100	X	X				X
10059837	Swivel LS Snap	(2) GL3100		X	X	X		

The 6' Diamond Expanyard offers a full 6' range of motion when in use. It contracts to 4.5' when not in use to reduce trip and snag hazards.



TEFLON® is a registered trademark of DuPont is used under license by MSA.

Fall Protection

Sure-Stop Shock-Absorbing Lanyards

- Uses a tear tape design to keep fall arrest forces below 900 lbf
- Meets ANSI Z359.1-1992 (R1999), ANSI A10.32 and applicable OSHA regulations, and is CSA certified 
- Available in single or twin-leg configurations
- Clear shock-absorber cover protects labels



Part No. SNL4048406LS



Part No. SWL60645D



Part No. SCL4067304LS



Part No. SWL40400206LS



Part No. SWLP0635A

Shock-Absorbing Lanyards with 1/2-inch, nylon rope

Part No.	Shock Absorber	Harness Connection	Anchorage Connection	Length		Type	
				4'	6'	Adjustable	Fixed
SNL4048406LS*	Sure-Stop	LS Snap	LS Snap		X		X

*Not CSA certified

Shock-Absorbing Lanyards with 1/4-inch Wire Rope, Vinyl Coated

Part No.	Shock Absorber	Harness Connection	Anchorage Connection	Length		Type	
				4'	6'	Adjustable	Fixed
SCL4067306LS	Sure-Stop	LS Snap	LS Snap		X		X

Expanyard Shock-Absorbing Lanyards with 6-ft length, nylon strap

Part No.	Shock Absorber	Harness Connection	Anchorage Connection	Twin-Leg	1-3/4" Strap	1" Strap
SWL60645D*	Sure-Stop	Sewn Loop	(2) HL64	X	X	
SWL60645B*	Sure-Stop	Sewn Loop	(2) LI Snap	X		X

*Not CSA certified



Part No. 10056764

- Allows the user to use any style of approved carabiner for anchor connector end
- Uses a tear tape design to keep fall arrest forces below 900 lbf.
- Clear shock-absorber cover protects labels
- Meets ANSI Z359.1 and applicable OSHA regulations

Shock-Absorbing Lanyards with 1-inch strap

Part No.	Material		Shock Absorber	Harness Connection	Anchorage Connection	Length		Type		
	Nylon	Polyester				4'	6'	Twin-Leg	Adjustable	Fixed
10056764	X		Sure-Stop	RM Snap	(2) Sewn Loops	X		X		X
SWL4068704LS	X		Sure-Stop	LS Snap	LS Snap	X				X
SWLP0635A		X	Sure-Stop	Sewn Loop	(2) LS Snap		X	X		X
SWL40400206LS	X		Sure-Stop	LS Snap	(2) LS Snap		X	X		X
SWL40400206LSH	X		Sure-Stop	LS Snap	(2) HL64		X	X		X
SWL4068706LS	X		Sure-Stop	LS Snap	LS Snap		X			X

*Not CSA certified

Dyna-Brake® Shock-Absorbing Lanyards

- Strong and durable
- Uses rip-stitch technology to keep fall arrest forces below 900 lbf
- Available in single or twin-leg configurations and with a variety of snaphooks
- Meets ANSI Z359.1-1992 (R1999), ANSI A10.32, and OSHA standards



- Part No. 10015877
- 6' x adj. 1" wide nylon web twin lanyard
 - HL2000 self-locking snaphook on one end and 2 GL3100 self-locking snaphooks on other ends
 - Compatible with most concrete forms



- Part No. 10021663
- 6' x adj. 1" wide nylon webbing
 - HL2000 self-locking snaphooks



- Part No. 501563
- 6' x fixed 1" wide polyester web twin lanyard
 - RL20 self-locking snaphooks



- Part No. 501562
- 6' x adj. 1" wide nylon web twin lanyard
 - RL20 self-locking snaphooks

Shock-Absorbing Lanyards with 1-inch strap

Part No.	Material		Shock Absorber	Harness Connection	Anchorage Connection	Length		Type		
	Nylon	Polyester				4'	6'	Twin-Leg	Adjustable	Fixed
10021661*	X		Dyna-Brake	HL2000	(2) HL63		X	X	X	
10021663*	X		Dyna-Brake	HL2000	HL2000		X		X	
10021664*	X		Dyna-Brake	HL2000	HL2000		X			X
10021668*	X		Dyna-Brake	HL2000	(2) HL2000		X	X	X	
10021669*		X	Dyna-Brake	HL2000	(2) HL2000		X	X	X	
10015877*	X		Dyna-Brake	HL2000	(2) GL3100		X	X	X	
501222*+	X		Dyna-Brake	RL20	RL20		X		X	
501226*+	X		Dyna-Brake	RL20	RL20		X			X
501235*+		X	Dyna-Brake	RL20	RL20		X		X	
501322*	X		Dyna-Brake	HL2000	HL2000		X			X
501561*	X		Dyna-Brake	RL20	(2) RL20		X	X		X
501562*	X		Dyna-Brake	RL20	(2) RL20		X	X	X	
501563*		X	Dyna-Brake	RL20	(2) RL20		X	X		X
501564*		X	Dyna-Brake	RL20	(2) RL20		X	X	X	

*Not CSA certified + SEI Certified

Expanyard Shock-Absorbing Lanyards

The Expanyard Shock-Absorbing Lanyard is designed to stretch to a six-foot length. When relaxed, it stays close to the user's body, reducing the possibility of trips and snags.



Part No. 10015900



Part No. 10013456

Expanyard Shock-Absorbing Lanyards with 6-ft length, nylon strap

Part No.	Shock Absorber	Harness Connection	Anchorage Connection	Twin-Leg	1-3/4" Strap	1" Strap
501752	Dyna-Brake	RL20	RL20			X
501574	Dyna-Brake	RL20	(2) RL20	X		X
10015900*	Dyna-Brake	HL2000	HL2000			X
10013456*	Dyna-Brake	HL2000	(2) HL2000	X		X

*Not CSA certified

"No Metal Above The Waist" Shock-Absorbing Lanyard

The "No Metal Above the Waist" shock-absorbing lanyard was specifically designed to work in conjunction with the "No Metal Above the Waist" harness, which was designed for the utility industry worker. To maintain the "No Metal Above the Waist" configuration, this shock-absorbing lanyard has a 9" sewn loop on one end which attaches to the back (dorsal) attachment point on the "No Metal Above the Waist" harness.

"No Metal Above the Waist" Shock-Absorbing Lanyard, with Dyna-Brake, polyester 1" strap, fixed 6' length

Part No.	Harness Connection	Anchorage Connection
501580	Sewn Loop	RL20



Part No. 501580

Fall Protection

Shock-Absorbing Lanyards



- Part No. 10021656
- 6' x adj. 1/2" dia. nylon rope
 - HL2000 self-locking snaphooks



- Part No. 10021655
- 6' x 7/32" dia. vinyl-coated wire rope
 - HL2000 self-locking snaphooks



- Part No. 10021653
- 6' x 7/32" dia. wire rope twin-leg
 - HL2000 self-locking snaphooks

Shock-Absorbing Lanyards with 1/2-inch, nylon rope

Part No.	Shock Absorber	Harness Connection	Anchorage Connection	Length		
				6'	Adjustable	Fixed
501220	Dyna-Brake	RL20	RL20	X	X	
10021656*	Dyna-Brake	HL2000	HL2000	X	X	

Shock-Absorbing Lanyards with 1/4-inch Wire Rope, Vinyl Coated, Fixed Length

Part No.	Shock Absorber	Harness Connection	Anchorage Connection	Length	
				6'	Twin-Leg
501244	Dyna-Brake	RL20	RL20	X	
10021655*	Dyna-Brake	HL2000	HL2000	X	
10021653*	Dyna-Brake	HL2000	(2) HL2000	X	X

*Not CSA certified

Tie-Back™ Shock-Absorbing Lanyard

The integral adjustable D-ring of the MSA Tie-Back lanyard allows for a compatible means of connection, minimizes the potential for roll-out, and eliminates the necessity of a separate anchorage connector. The integral adjustable D-ring allows the MSA Tie-Back Lanyard to accommodate a wide variety of anchorage point shapes and sizes.

The MSA Tie-Back Lanyard features:

- Integral Dyna-Might shock absorber or Dyna-Brake shock absorber
- Available in Twin-Leg configuration for 100% tie-off
- Maximum arrest force of 900 lbf



Twin-Leg Tie-Back Shock-Absorbing Lanyard
Part No. 10021671

Tie-Back Shock-Absorbing Lanyard with 1" Strap, 6' Fixed Length, Nylon

Part No.	Material		Shock Absorber	Harness Connection	Anchorage Connection	Type	
	Nylon					Twin-Leg	
10021670	X		Dyna-Brake	HL2000	HL2000		
10021671	X		Dyna-Brake	HL2000	(2) HL2000	X	
10021673	X		Dyna-Brake	HL2000	(2) HL64	X	
10011792	X		Dyna-Might	HL2000	HL2000		
10011649	X		Dyna-Brake	RL20	(2) RL20	X	



Tie-Back Shock-Absorbing Lanyard
Part No. 10021670

Shock-Absorbing Sub-Assembly

The Shock-Absorbing Sub-Assembly may be connected to a compatible lanyard to create a non-integral lanyard connector subsystem for fall arrest.



- Part No. 10021654
- Nylon webbing (poly. P/N 10021658)



Part No. SSA4002LS

Shock-Absorbing Devices, Nylon

Part No.	Shock Absorber	Harness Connection	Anchorage Connection	Length
				6'
10021654*	Dyna-Brake	HL2000	D-ring	22"
SSA4002LS	Sure-Stop	LS Snap	D-ring	

*Not CSA certified

Restraint Lanyards

Restraint lanyards are primarily used for travel restriction and work positioning. Lanyards for travel restriction are used to restrain a worker from reaching a fall hazard. Lanyards for work positioning are used for stabilizing a worker at an elevation. They can be ordered in fixed or adjustable lengths. Each lanyard comes with a forged steel, zinc-plated self-locking snaphook attached to each end. Meets ANSI and OSHA standards. Models with CSA part numbers are CSA certified.



Part No. 505204



Part No. 505201



Part No. SWL3268704LS



Part No. 505166



Part No. SNL3248404LS

Restraint Lanyards with 1-inch, nylon strap

Part No.	CSA Part No.	Harness Connection	Anchorage Connection	Length		Type	
				4'	6'	Adjustable	Fixed
505088	—	HL2000		X	X		
505097	—	HL2000		X			X
505197	415715	RL20	RL20		X		X
505204	415719	RL20	RL20		X	X	
SWL3268704LS	SWL3268704LS	LS Snap	LS Snap	X			X
SWL3268706LS	SWL3268706LS	LS Snap	LS Snap		X		X

Restraint Lanyards with 5/8-inch, nylon rope, fixed length

Part No.	CSA Part No.	Harness Connection	Anchorage Connection	Length	
				4'	6'
415108	—	RL20	RL20	X	
505166	—	HL2000	HL2000		X
SNL3248406LS	SNL3248406LS	LS Snap	LS Snap		X

Restraint Lanyards with 1/2-inch, nylon rope, 6-ft length

Part No.	Harness Connection	Anchorage Connection	Type	
			Adjustable	Fixed
505002	HL2000	HL2000		X
505012	HL2000	HL2000	X	
505200	RL20	RL20		X
505201	RL20	RL20	X	



Fall Protection

Restraint Lanyard with 7/32-inch, cable, vinyl coated, fixed 6-ft length

Part No.	Harness Connection	Anchorage Connection
505063	HL2000	HL2000



Part No. 505063

- 5' x 7/32" vinyl-coated wire rope
- HL2000 self-locking snaphooks

Restraint Lanyards with Sewn Loop

Part No.	Description
505165	Lanyard, nylon, sewn loop one end, HL2000 snaphook on other end, 6-ft, fixed length
505217	Lanyard, nylon, sewn loop one end, RL20 snaphook on other end, 6-ft, adjustable length

Rebar Assembly

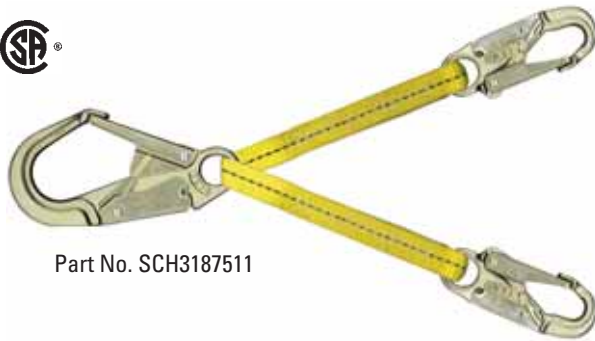

Part No. SCH3187511

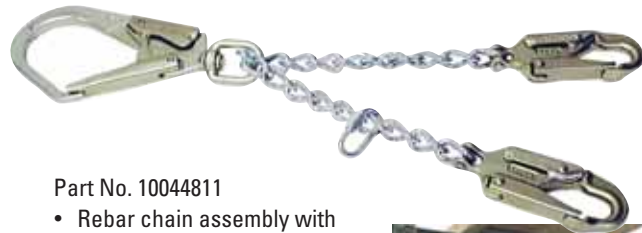

Part No. 10044811

- Rebar chain assembly with GL3100 self-locking snaphook
- Compatible with most concrete forms



Part No.	Description
415957	Rebar strap assembly, Large snaphook with 2.5" (64mm) gate
10044811*	Rebar chain assembly, GL3100 snaphook with 2.25" (57mm) gate
SCH3187511	Rebar web assembly, 18" legs, with sliding Large snaphook

*Not CSA certified

Lineman's Pole Strap

Part No.	Description
415834	Lineman's pole strap, nylon, adjustable, to maximum length of 70"

Lineman's Pole Strap
Part No. 415834



Sure-Grab™ Positioning Lanyard

Part No.	Description
SNYR537DH306	Sure-Grab positioning lanyard, manual, closed body, c/w 5/8" x 6' blue Static Kernmantle, chrome locking swivel snaphook, right-handed version

Sure-Grab Positioning Lanyard
Part No. SNYR537DH306

Anchorage Connectors

- Have a minimum breaking strength of 5,000 lb.
- Compatible for use with MSA fall arrest and confined space entry/retrieval components

Anchorage Connector Strap

- Standard 5-ft. length, custom lengths available
- D-ring on one end and a sewn loop on the other end

Anchorage Connector Strap Part No. 505282



Anchorage Connector Chain

- Temporary anchorage connector
- Useful near sharp edges or in high heat environments

Anchorage Connector Chain Part No. 10003206



Rail-Slider™

- Provides fall protection during horizontal movement on railway bridges
- Quick and easy installation
- 2 sizes available

Rail-Slider Part No. SFPRS6000



Suretyman Anchorage Sling Part No. SFP2267404

Suretyman™ Anchorage Sling

- 1" nylon tube webbing sewn into an endless loop
- Available in 2', 4', and 6' lengths
- Can be hitched to an anchorage point using various configurations

ManSafe Freestanding Constant Force Post

- Does not attach to the working surface
- Installer will never have to lift more than 55 lbs (25 kg) at any time
- Used on nominally flat roofs up to a maximum pitch of 5 degrees
- Tested and approved for use on concrete, single-ply membrane, asphalt-sanded, asphalt-stone chipped, and steel roof profiles
- Post is omni-directional



ManSafe Freestanding Post* Part No. 10055719

* Post D-ring (Part No. 10038363) must be purchased separately.

PointGuard™ Anchorage Connector Strap

The PointGuard Anchorage Connector provides a secure point of attachment for residential and concrete construction applications. When the anchorage connector is no longer needed a worker can simply cut the protruding strap and throw it away. The PointGuard Anchorage Connector is:

- Quick and easy to install
- Economical
- Available in 2 models -
 - Residential Construction
 - ❖ A standard length of 3'
 - ❖ Meets all applicable OSHA regulations as well as ANSI A10.14 and ANSI Z359.1
 - Concrete Construction
 - ❖ A standard length of 4'
 - ❖ Includes protective sheath
 - ❖ Meets all applicable OSHA regulations as well as ANSI A10.14
- Durable Polyester Webbing with 5,000-pound minimum breaking strength
- 400-pound (182 kg) capacity

PointGuard Residential Part No. 10042792



PointGuard Concrete Part No. 10042794



Anchorage Cable Sling

- Standard lengths of 2', 4', and 6', custom lengths available
- Vinyl Coated
- 1/4" Galvanized Cable

Anchorage Cable Sling Part No. SFP3267504



Part No.	Description
505282	Anchorage connector strap, nylon, 5'
505298	Anchorage connector strap, polyester, 5'
10003206	Anchorage connector chain
10023490	Double D-ring anchorage connector strap with D-ring on each end
10042792	PointGuard residential anchorage connector strap, 3' with D-ring
10042794	PointGuard concrete anchorage connector strap, 4' with D-ring
SFP2267404	Suretyman anchorage sling, 4' length
SFP2267503	Double D-ring Anchorage Connector Strap, 3' length
SFP2267506	Double D-ring Anchorage Connector Strap, 6' length
SFP3267504	Anchorage cable sling, 4' length
SFPRS6000	Rail-Slider, steel, galvanized, for 80 - 136 # rail, used on train/crane type rail, [carabiner required - sold separately (see page 167)]
10030608	Rail-Slider, steel, galvanized, for 141 # rail, used on train/crane type rail, [carabiner required - sold separately (see page 167)]
10055717	ManSafe Freestanding Constant Force Post, 440 lbs (200 kg)
10055718	ManSafe Freestanding Constant Force Post, 660 lbs (300 kg)
10055719	ManSafe Freestanding Constant Force Post, 880 lbs (400 kg)
10055716	220 lb (100 kg) Upgrade kit
10038363	Post D-ring
SFP3267506	Anchorage Cable Sling, 6' length

Fall Protection

BeamGrip™

- Attaches to I-beam flange - no tools required
- Optional D-ring insert (P/N 506643) and/or swivel D-ring (P/N 506673) can provide anchorage connection for one or two persons (D-rings sold separately)

BeamGrip
Part No. 506682



Pictured with Optional
D-ring insert and
Swivel D-ring



BeamGlide Trolley Removable Model
Part No. 506266

BeamGlide™ Trolley

- Provides horizontal mobility - keeps anchorage connector directly overhead
- Sizing to fit all beams



Anchorage Connector
Extension
Part No. 505233

Anchorage Connector Extension

- Vinyl coated
- 1/4" galvanized cable
- Standard 5' length



D-Plate
Part No. 506632

D-Plate Anchorage Connector

- Provides permanent anchorage point
- Bolts to beams or columns
- Also available with 8"x 8" back-plate made of black anodized aluminum, galvanized steel, or stainless steel for attachment to concrete walls

FP Stryder™ Anchorage Connector

- Easy, single-hand installation
- Low friction wear pads with Teflon allow the FP Stryder Anchorage Connector to glide effortlessly along the beam flange
- Lightweight - only 4.5 pounds!
- Integral load indicator alerts user if unit has been exposed to a fall
- Versatile design allows for mounting overhead or at worker's feet
- Vernier adjustability allows for a secure fit and 1/4" adjustment increments
- Easy to use, push button adjustment - No Pins to be lost!
- 2 models available to fit most beam sizes
 - Standard version fits beam flange widths from 4" to 14"
 - XL version fits beam flange widths from 14" to 24"
- 400-pound working capacity
- Field serviceable



FP Stryder
Part No. 10051455

Bolt D-ring with Hole
Part No. 10003213

Bolt D-ring with Hole

- Permanent anchorage connector
- Attaches to bottom of I-beam flange, user supplies bolt
- Designed for horizontal installation



Permanent Roof Anchor
Part No. 10016468

Permanent Roof Anchor

- All steel construction
- Fits all pitches of roof trusses or rafters
- Easy to install without special tools

Part No.	Description
505233	1/4" wire rope, vinyl coated, fixed length, 5', RL20 snaphook one end, 3" O-ring on other end
506632	D-plate anchorage connector, zinc-plated steel
10003213	Bolt D-ring with hole only
506682	BeamGrip for beams with flange width: 3.94" to 5.64" flange thickness: .205" to .659"
415171	flange width: 5.525" to 8.07" flange thickness: .36" to 1.09"
415173	flange width: 10.265" to 12.8" flange thickness: .605" to 1.25"
10003210	Adjustable beam grip
10016468	Permanent roof anchor - 2" x 4"
10051455	FP Stryder Anchorage Connector, Standard version, fits beam flange widths from 4" - 14"
10051456	FP Stryder XL Anchorage Connector, XL version, fits beam flange widths from 14" - 24"
10051457	FP Stryder Anchorage Connector Kit, containing one complete Standard version FP Stryder, one XL adjustment bar, one carrying case, and one adjuster button replacement kit
10081594	5K Removable Concrete Anchor
10081570	10K Removable Concrete Anchor

5K Removable Concrete Anchor
Part No. 10081594



10K Removable Concrete Anchor
Part No. 10081570



New!

Removable Concrete Anchors

- Quickly and easily removed and reinstalled in another location
- Compact and lightweight
- Durable stainless steel and aluminum construction
- 400 lb capacity
- 2 models: 5,000 lb version (5K) and 10,000 lb (10K) version

Carabiners

MSA offers a wide variety of carabiners for almost every application. All carabiners have a minimum breaking strength of 5,000 lbs.



- Part No. 506259
- 7/8" (22mm) gate opening
 - Autolocking
 - Aluminum



- Part No. 506572
- 7/8" (22mm) gate opening
 - Autolocking
 - Steel



- Part No. 506308
- 2" (50mm) gate opening
 - Autolocking
 - Steel



- Part No. SRCC642
- 1.2" (32mm) gate opening
 - Autolocking
 - Steel
 - NFPA Approved



- Part No. SRCC643
- 1" (25mm) gate opening
 - Autolocking
 - Steel



- Part No. SRCC734G
- 2.1" (52mm) gate opening
 - Autolocking
 - Steel

Locking and Unlocking Carabiners
ALWAYS CHECK THAT GATE IS SECURELY LOCKED BEFORE USE.

1. Rotate gate 90° to unlock
2. Depress gate to pivot open
3. Release gate to close and lock

Part No.	Description
506259	Carabiner, 7/8" (22 mm) gate, twist lock, aluminum
50657	Carabiner, 7/8" (22 mm) gate, twist lock, steel
506308	Carabiner, 2" (50 mm) gate, twist lock, steel, with captive eye
SRCC643	Carabiner, 1" (25 mm) gate (large), autolocking, steel, with captive eye
SRCC734G	Carabiner, 2.1" (52 mm) gate (extra large), autolocking, steel, with captive eye
SRCC642	Carabiner, large D design, 1.2" (32 mm) gate, auto-locking, steel

Fall Protection Kits

Thermatek™ Kit

Includes:

- Thermatek Harness, standard size, made of a Kevlar/Nomex blend webbing that is resistant to chemicals, weld splatter, and other high heat exposures.
- Thermatek Shock-Absorbing Lanyard features a burn-resistant Tuffweld protective cover that is superior to Nomex. The Thermatek 12 lanyard model is designed to arrest a freefall up to 12' and keep fall arrest forces below OSHA limits.
- Thermatek Anchorage Connector Strap with Kevlar webbing and stitching has a replaceable wear pad to protect webbing from abrasion.
- Carrying Bag for convenience.



Thermatek Kit in use



Part No.	Description
10026061	Thermatek Kit with Thermatek 6 lanyard (HL2000 Snaphooks)

Fall Protection

Anthron Descent Device System

The Anthron Descent Controller is a manually operated descent device. It is most commonly used for suspended work positioning, self evacuation, or rescue operations. Other features include:

- Proper roping/rigging diagrams on the side of the Anthron Descender
- Device can be installed/removed at any point on rope
- Working load of 300 lbs (136 kg)
- System consists of a 7/16" (11mm) rope, Anthron Descender, and two carabiners

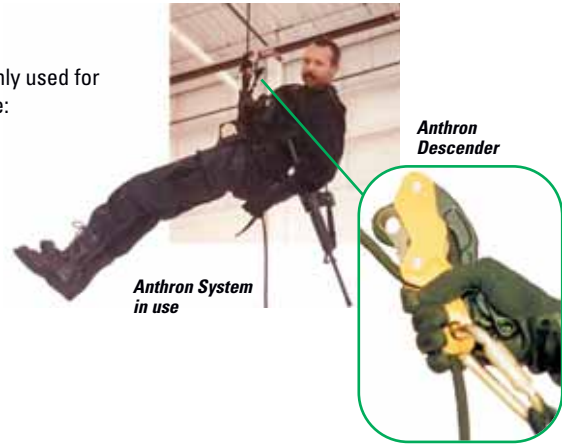

Part No.	Description
SDC726050	Anthron system includes: Anthron descender, 2 carabiners, 50 ft rope
SDC726100	Anthron system includes: Anthron descender, 2 carabiners, 100 ft rope
SDC726150	Anthron system includes: Anthron descender, 2 carabiners, 150 ft rope

Anthron systems and replacement ropes available in lengths of 25-ft increments from 50 ft up to 600 ft

Roofers' Kits

Includes:

- Vest-Style Harness -- a lightweight, durable, abrasion-resistant harness.
- Lifeline with Locking Carabiner or Snaphook permits safety and ease of mind while working.
- Rope Grab is a lightweight and affordable fall arrest device.
- Roof Anchors & Woodscrews (on some kits) are disposable Roof Anchors constructed from heavy-gauge steel with a galvanized finish. Each comes with 8 galvanized flathead woodscrews.

All FP Pro products are fully compliant with applicable OSHA regulations and ANSI A10.14.

Part No.	Description
416067	FP Pro Roofers' Kit including: FP Pro Vest-Style Harness, Lifeline with Locking Carabiner, Rope Grab fall arrester, roof anchors & woodscrews, and Tote Bag
10049751	Roofers' Kit including: FP Pro Vest-Style Harness, Shock-Absorber with LS Snaphook attached to 25' polysteel 5/8" rope, Rope Grab fall arrester (p/n 10054077), one disposable roof anchor, all packaged in a handy 6 gallon bucket.
10054971	Roofers' Kit including: FP Pro Vest-Style Harness, 50' Lifeline with Locking Carabiner, Rope Grab fall arrester (p/n 10054077), roof anchors & woodscrews, and Tote Bag
SVL1013050	Roofers' kit including: Gravity harness (p/n SSH304200), Shock-Absorber with LS Snaphook attached to 50' polyester 5/8" rope, Rope Grab fall arrester (p/n SVLR537R018LS), all packaged in a handy 6 gallon bucket.
10063412	Roofers' Kit, 50' lifeline with shock-absorber, FP Pro Harness, Rope Grab fall arrester (SVLR537R018LS), roof anchor and Storage Bag
10057104	Roofers' Kit, 50' lifeline, FP Pro Harness, Roof Anchor, 6-Gallon Bucket



FP Pro Harnesses/Diamond™ Lanyard Kits

Two great products in one easy to order kit! These kits are available with your choice of a Cross-Chest or Vest-Style FP Pro Harness with or without hip D-rings, and with a single or twin-leg FP Diamond Shock-Absorbing Lanyard. All kits include carrying bag.

Part No.	Description
10062329	FP Pro Cross-Chest Harness, STD size, Qwik-fit leg straps, back D-ring, Diamond Lanyard
10062316	FP Pro Vest-Style Harness, STD size, Qwik-fit leg straps, back D-ring, Diamond Lanyard
10062411	FP Pro Cross-Chest Harness, STD size, Tongue Buckle leg straps, back D-ring, Diamond Lanyard
10062405	FP Pro Vest-Style Harness, STD size, Qwik-fit chest strap and Tongue Buckle leg straps, back D-ring, Diamond Lanyard

Additional sizes available. Contact MSA Customer Service Center for details.

FP Pro Harness/Diamond Lanyard Kit
Part No. 10062316



Rope Grabs and Vertical Lifelines

FP Pro Rope Grab

Unique, versatile, lightweight and affordable, the FP Pro Rope Grab features:

- Hands-free operation while ascending or descending
- Ultra-smooth travel action
- Cam and hinge design allows for a quick, easy installation on the rope
- Available with either polyester or polyester/polypropylene blend rope



FP Pro Rope Grab with 3' Dyna-Brake Lanyard
Part No. 415940



Rope Grab Fall Arrester
Part No. 10054077



Rope Grab Kit
Part No. 415942



Part No.	Description
415940	FP Pro Rope Grab with 3' Dyna-Brake Lanyard
415942	Rope Grab kit with 50' - 5/8" rope, polyester, anchorage connector strap
10054077	Rope Grab fall arrester
415869	50 ft - 5/8" rope, polyester with RL20 snaphook on one end
415871	100 ft - 5/8" rope, polyester with RL20 snaphook on one end
415873	200 ft - 5/8" rope, polyester with RL20 snaphook on one end

Sure-Grab™ Rope Grab

The SVLR78 Sure-Grab device and lifeline is used to provide temporary fall protection on ladders or when climbing vertical structures. This system can also be used to provide a secondary lifeline for suspended positioning systems used by building/structure inspectors, window cleaners, and maintenance personnel. The Sure-Grab device moves freely up or down an approved 5/8" (16 mm) diameter lifeline. When sudden downward movement occurs, a camming lever is activated arresting the fall. The device can be installed or removed from the lifeline at any point along its length.

Sure-Grab rope grabs are CSA certified.



Part No.	Description
SVLR78LS	Rope grab fall arrester, automatic/manual, open body, c/w 1-3/4" x 12" web lanyard, LS snaphook
10030433	CSA rope grab kit #1. Includes: Sure-Grab (SVLR78LS) and 60' Vertical Lifeline (SLLPB672-060/LS)
SRIW1000	5/8" Termination Plate
SLLNL672060LS	Lifeline, nylon, white 3-strand, 5/8" x 60-ft (16mm x 20m) with LS snap on one end
SLLNL672100LS	Lifeline, nylon, white 3-strand, 5/8" x 100-ft (16mm x 30.5m) with LS snap on one end
SLLNL672200LS	Lifeline, nylon, white 3-strand, 5/8" x 200-ft (16mm x 61m) with LS snap on one end



Fall Protection

Self-Retracting Lanyards

Aptura® SRL

MSA has set a new standard in the mechanical fall protection market with the Aptura LT12 and Aptura LT30 Self-Retracting Lanyard (SRL). Never before has the market seen such a state-of-the-art device with so many standard features. With its solid design and fast-acting brake mechanism, you can be confident that the Aptura LT12 and the Aptura LT30 SRL will be there for you when you need it most. All Aptura SRL's feature:

- A durable, engineered thermoplastic housing to increase service life.
- Rugged, impact-absorbing protective bumpers for added durability.
- A field-replaceable lifeline option. In the event that the webbing should become damaged, this option provides a field-replaceable web lifeline, eliminating costly returns to the manufacturer. The Aptura is the first SRL to offer this feature.
- A 400-pound working capacity as a standard feature.
- No annual factory recertification required due to high-quality construction. This not only reduces the cost of ownership, but also eliminates down time.
- An integral load indicator lets you know when it is time to remove the product from service.
- SRL connector with integral swivel.
- Meets ANSI Z359.1-1992 (R1999), ANSI A10.32 and all applicable OSHA standards, and is CSA certified.
- ATO ordering flexibility allows you to order the exact options, and only the options you want.

All these features and more combine to deliver the most versatile SRL available on the market today, the APTURA self-retracting lanyard.

Restrictions from local governing authorities still apply. Consult with your Safety Director regarding applicable restrictions, regulations, and standards in your area.

Aptura® LT12 SRL

In addition to the exciting features of all Aptura SRL's, the Aptura LT12 SRL features:

- A lightweight design starting at 2.4 pounds
- A standard lifeline length of 12'. Available in lengths from 6' to 12'
- A constant lock-up rate to prevent the erratic, "jerky" lock-up (like a seat belt) found on some types of personal fall limiters.

Aptura® LT30 SRL

In addition to the exciting features of all Aptura SRL's, the Aptura LT30 SRL features:

- A lightweight design starting at 7.5 pounds
- A standard lifeline length of 30'. Available in lengths from 13' to 30' in 1 foot increments

SRL Connection Options



Back D Connector
Part No. SRCC413



1" Steel Carabiner
Part No. SRCC643



HL2000
Snap



LS Snap



LI Snap

Lifeline Connection Options



APTURA LT30
Part No. 10053558



APTURA LT12
Part No. 10042171

Part No.	Line Length	SRL Connection	Lifeline Connection	Field Replacement Line
10042171*	12 ft	None	LI Snap	Yes
10044228*	12 ft	Back D Connector	HL2000	Yes
10044229*	12 ft	None	HL2000	Yes
10044320*	12 ft	1" Steel Carabiner	HL2000	Yes
10050504	30 ft	None	LI Snap	Yes
10053558	30 ft	None	HL2000	Yes
10053559	30 ft	1" Steel Carabiner	LS Snap	Yes
10053560	30 ft	1" Steel Carabiner	HL2000	Yes

* Not CSA Certified

Dyna-Lock® SRL's

The MSA Dyna-Lock Self-Retracting Lanyards (SRL) are fast-acting fall arresters that limit free-fall distance, deceleration distance, and fall arrest forces while allowing user freedom of movement. The Dyna-Lock SRL is ideal for climbing applications where vertical mobility is needed.

The Dyna-Lock SRL has a 4.5-feet-per-second locking speed. A built-in shock absorber limits fall arrest forces to under 900 lbf. Three continuously moving independent braking mechanisms prevent freezing in icy or corrosive conditions. Available with 3/16-inch galvanized or stainless steel wire rope, or 1-inch wide nylon webbing. A forged steel, zinc-plated, self-locking swivel snaphook is present on each unit with a load indicator that activates and alerts the user when the Dyna-Lock SRL has been impact loaded. The Roughneck model incorporates a black corrosion-resistant coating designed for severe environmental conditions. Meets ANSI Z359.1-1992 (R1999), ANSI A10.32, and applicable OSHA standards. Models with CSA part numbers are CSA certified.

NOTE: This "no re-certification" policy does not mean that routine inspections do not need to be performed on MSA mechanical units. All users of MSA mechanical products are still required to perform a pre-use inspection and a formal inspection of each mechanical unit in accordance with the user instructions, and as outlined in OSHA regulations, ANSI standards, and CSA standards. CSA standards require an annual re-certification for mechanical products two years from date of manufacture.

Capacity (working load)

For 20' web, 30', 50', 70', and 95' cable Dyna-Lock Models:

- Maximum: 400 lbs (181 kg)
- Minimum: 75 lbs (34 kg)

Now rated to a capacity of 400 lbs

For 20' cable Dyna-Lock, Short-Stop, and Sure-Lock Models:

- Maximum: 310 lbs (140 kg)
- Minimum: 75 lbs (34 kg)

Arrest Force

- 75 - 310 lbs < 900 lbf (4 kN)
- 311 - 400 lbs < 1800 lbf (8 kN)

Arrest Distance

- 75 - 310 lbs < 40 in (101.6 cm)
- 311 - 400 lbs < 54 in (137 cm)

No factory re-certification required!

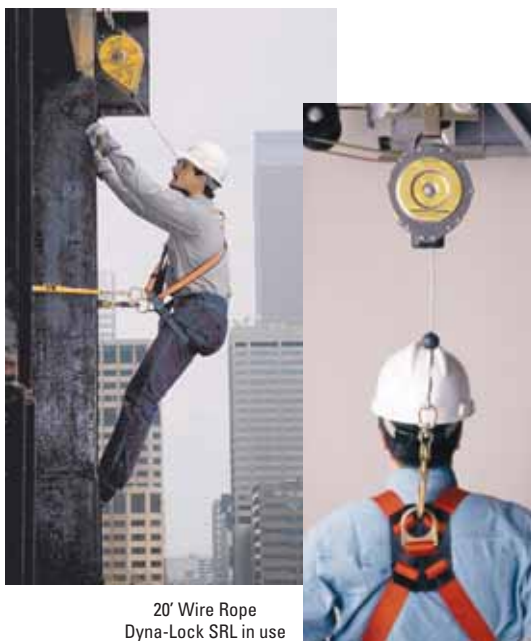

20' Wire Rope Dyna-Lock SRL in use



Dyna-Lock SRL Part No. 506204

Backpacker SRL Part No. 506619

20' Strap Dyna-Lock SRL Part No. 506615

20' Wire Rope Dyna-Lock SRL Part No. 10017931 (310 lbs Maximum Capacity)

Part No.	CSA Part No.	Description
506202	10006470	Dyna-Lock SRL, galvanized wire rope, HL2000S, 10M (30')
506204	10006468	16M (50')
506208	10006464	30M (95')
506615	10006447	20' web Dyna-Lock, nylon, HL2000S
10017931*	10017933*	20' Wire Rope Dyna-Lock, stainless steel, HL2000S
506619	10006446	Backpacker 20' web Dyna-Lock, nylon, RL20S

* 310 lbs maximum capacity

Fall Protection

Confined Space Equipment

MSA confined space entry/retrieval systems are designed for fall arrest, lifting and lowering, rescue, and work positioning applications. They incorporate an anchorage connector, fall arrest component (Dyna-Lock, Dynevac II, Lynx Rescuer), a personnel and materials handling hoist (Lynx Hoist), and associated hardware to rig the system for use. The systems can be used for leading edge work, maintenance and entry/retrieval from manholes, tank cars, silos, tanks, vaults, pits, vats, and other confined space applications.

Lynx® Rescuer, Field Resettable Model with Lockout

- Self-Retracting Lanyard with emergency retrieval capabilities
- User is able to reset device from retrieval mode to fall arrest mode
- The easiest, quickest field-reset mechanism on the market
- Same unit can be used in the field and for training situations
- Lock feature with key allows more control over who can reset unit to fall arrest mode
- Confined space entry provides fall arrest and emergency lifting and lowering
- Meets ANSI Z359.1-1992 (R1999), and all applicable OSHA standards, and is CSA certified

Part No.	CSA Part No.	Description
10011744	10023016	50-ft (16m) Self-Retracting Lanyard with Emergency Rescuer, 3/16" diameter stainless steel line. With proper inspection, system may be reused after fall arrest and/or retrieval.
10011745	10023017	95-ft (30m) Self-Retracting Lanyard with Emergency Rescuer, 3/16" diameter stainless steel line. With proper inspection, system may be reused after fall arrest and/or retrieval.



Lynx Rescuer
Part No. 10011744

Lynx® Personnel/Material Hoist

- Designed for lifting, lowering, and positioning of personnel and materials
- Maximum work load of 310 lbs for personnel and 620 lbs for materials
- Anti-backlash crank handle with a lifting/lowering speed of 25-ft per minute
- Integral shock absorber
- Load-limiting clutch prevents overloading of hoist
- Emergency drive allows manual bypass of load-limiting clutch for extra lifting capacity in an emergency
- Primary gear backed up by two independent secondary brakes
- Air drive adapter enables powered lifting/lowering with optional air-powered drive assembly
- Meets ANSI Z359.1-1992 (R1999), and all applicable OSHA standards

Part No.	Description
10016569	Side mount with emergency drive and air drive adapter, galvanized wire rope, 50'
10016568	Side mount with emergency drive and air drive adapter, galvanized wire rope, 105'
10016683	Boom mount with emergency drive and air drive adapter, galvanized wire rope, 50'
10016682	Boom mount with emergency drive and air drive adapter, galvanized wire rope, 105'



Lynx Hoist
Part No. 10016569



Lynx Boom Mount Hoist
Part No. 10016683

Lynx® Tripod

- Automatic hinge lock legs
- Constructed of three anodized aluminum legs and a zinc-plated carbon steel head
- Legs feature 1-1/4 in. incremental adjustment with positive locking pins
- Skid resistant feet with self-sharpening spikes

Part No.	Description
10022050	8' Lynx Tripod
10022051	10' Lynx Tripod



8' Lynx Tripod
Part No.
10022050

Confined Space Entry Kits

Confined Space Entry Kits make it easy for you to order the Confined Space System which best suits your needs.

The Confined Space Entry Kits feature:

- 3 Tripod Kits and 2 Folding Davit Kits
- Single part number for simplified ordering
- Confined Space Kits with Lynx Rescuer allow for non-entry rescue of a confined space entrant
- Tripod and Davit Kits allow for great portability
- Training Video and Tripod Carrying Strap included within each kit

Lynx® Tripod Confined Space Entry Kit #1

(P/N 10023966)

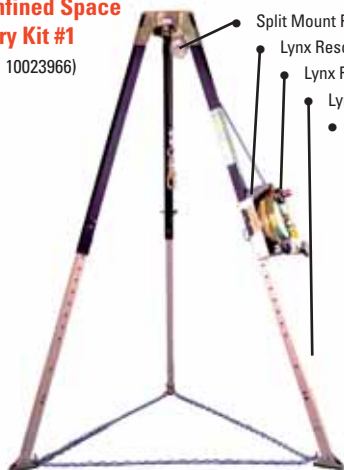

- Split Mount Pulley (P/N 506222)
- Lynx Rescuer Mounting Bracket for Tripod (P/N 506232)
- Lynx Rescuer 16 m (P/N 10011744)
- Lynx 8' Tripod (P/N 10022050)
- Includes Carry Bags for Tripod & Lynx Rescuer

Lynx® Tripod Confined Space Entry Kit #2

(P/N 10023967)

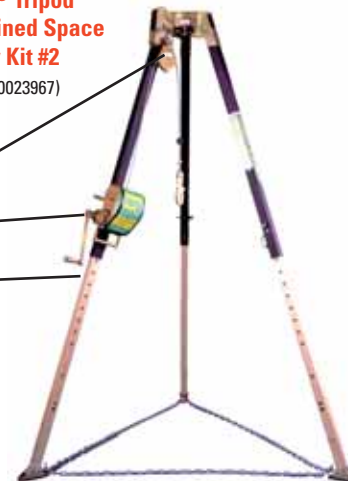

- Pulley/Bracket Assembly (P/N506473)
- Side Mount Lynx Hoist, with 50' galv. line (P/N 10016569)
- Lynx 8' Tripod (P/N 10022050)
- Includes Carry Bags for Tripod & Lynx Hoist

Lynx® Tripod Confined Space Entry Kit #3

(P/N 10023968)

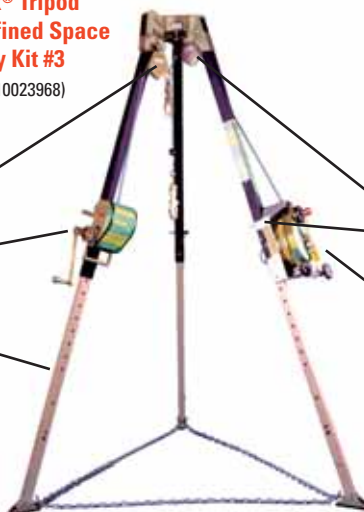

- Pulley/Bracket Assembly (P/N506473)
- Side Mount Lynx Hoist, with 50' galv. line (P/N 10016569)
- Lynx 8' Tripod (P/N 10022050)
- Includes Carry Bags for Tripod, Lynx Rescuer, & Lynx Hoist
- Split Mount Pulley (P/N 506222)
- Lynx Rescuer Mounting Bracket for Tripod (P/N 506232)
- Lynx Rescuer 16 m (P/N 10011744)

Part No.	CSA Part No.	Description
10023966	10048472	Lynx Tripod Confined Space Entry Kit #1
10023967	—	Lynx Tripod Confined Space Entry Kit #2
10023968	10048473	Lynx Tripod Confined Space Entry Kit #3

Fall Protection

Folding Davit and Base

The Folding Davit and Base is a portable and economical anchorage connector used where a tripod will not work. Available with a zinc-plated alloy-steel Davit Arm and your choice of zinc-plated carbon steel or stainless steel Davit Base. This lightweight device provides a 24-inch reach and 77-inches of head clearance. It pivots 360-degrees and can readily maneuver personnel and materials between spaces below the deck where it is mounted. The Folding Davit may be carried from base to base and installed in minutes. Meets or exceeds ANSI Z359.1, ANSI A10.32, and applicable OSHA requirements. Mounting brackets and pulleys sold separately.



Folding Davit arm -
Part No. 506613
Folding Davit base -
Part no. 506614

Column Davit and Base

The Column Davit and Base are used for more permanent conditions where a tripod will not work. Available with a zinc-plated alloy-steel Davit Arm and zinc-plated carbon steel or stainless steel bases. Provides a 30-inch reach and 77-inches of head clearance. May be mounted to horizontal, vertical, and subsurface appropriate anchor points. Pivots 360-degrees. Meets or exceeds applicable OSHA requirements. Mounting brackets and pulleys sold separately.



Column Davit arm -
Part No. 506568
Column Davit base -
Part No. 506492

Part No.	Description
506613	Folding davit arm, 24" reach, 77" working height, swivels to extend over work area, folds for ease of transport and storage
506614	Folding davit base
506622	Bracket for mounting 10m (30 ft)/ 16m (50 ft) Dyna-Lock, Dynevac, and Lynx Rescuer to Folding davit
506362	Bracket (same as above), except for 22m (70 ft)/ 30m (95 ft) Dyna-Lock
506568	Column davit arm, 30" reach, 77" working height, boom arm swivels to extend over work area
506492	Surface mounting receptacle for Column davit arm
506232	Bracket for mounting 10m (30 ft)/ 16m (50 ft) Dyna-Lock, Dynevac, and Lynx Rescuer to Column davit, aluminum (requires part no. 506590)
506216	Bracket (same as above), except for 22m (70 ft)/ 30m (95 ft) Dyna-Lock
506590	Bracket for mounting Dyna-Lock or Dynevac to Column davit (requires part no. 506216 or 506232)
506603	Holster to store Boom Mount Hoist when not in use
506668	Vertical davit arm - Ladder Mount
506667	Receptacle for Vertical davit arm - Ladder Mount (bolts to ladder)
415837	Push-Pull davit - Ladder Mount, bolts to ladder and retracts to allow hatch cover to close, extends 60" above hatch when extended

Vertical Davit -
Ladder Mount

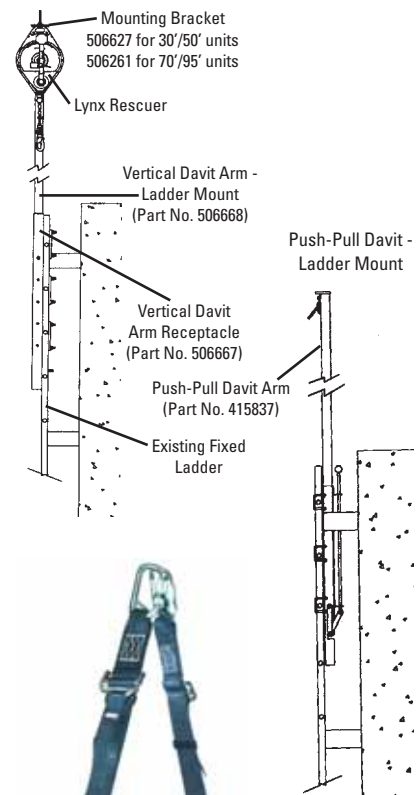

Mounting Bracket
506627 for 30'/50' units
506261 for 70'/95' units
Lynx Rescuer

Vertical Davit Arm -
Ladder Mount
(Part No. 506668)

Push-Pull Davit -
Ladder Mount

Vertical Davit
Arm Receptacle
(Part No. 506667)

Push-Pull Davit Arm
(Part No. 415837)

Existing Fixed
Ladder

Bosun Chair

The Bosun Chair is the best method to sit suspended for long durations. The padded seat ensures your comfort during use. The adjustable web assembly ensures security. Designed to be used in conjunction with our Full Body Harnesses, the Bosun Chair, attached to the chest D-ring, will keep the user in the upright position.

Part No.	Description
SSH3505017	Bosun Chair, 5" x 16-1/2" padded seat, black nylon straps, 2 carabiners



Bosun Chair
Part No. SSH3505017

Sure-Climb System with Integral Shock Absorber
Part No. SFPLS353050

Ladder Climbing Equipment

Sure-Climb™ Temporary Cable System

The Sure-Climb Temporary Ladder Cable System is designed to provide fall protection when climbing or descending ladders or vertical structures up to 300' in height. Applications include telecommunications towers, light poles, water towers, hydroelectric towers, stacks, and any other climbable structure. The Sure-Climb temporary system:

- Is available in 2 versions; with an integral shock absorber, or with an energy-absorbing top mounting bracket
- Allows for quick and easy attachment to approved ladder or structure
- Includes an integral, adjustable line weight
- Uses a stainless steel fall arrester (ordered separately)
- Uses a 5/16" galvanized steel cable
- Meets all applicable OSHA regulations and ANSI standards
- CSA certified

All Sure-Climb systems include: anchor bracket, anchor shackle, cable guides, wire rope clips, turnbuckle, and cable.

Fall Arrester must be ordered separately.



Part No.	Description
SFPLS353050	Sure-Climb System with integral shock absorber, 50 ft (16 m)
SFPLS353100	Sure-Climb System with integral shock absorber, 100 ft (30 m)
10040010	Sure-Climb Slider (fall arrester) with carabiner

Additional Lengths available from 50 ft. up to 200 ft. in fifty foot increments

Sure-Climb™ Permanent Cable System

The Sure-Climb Permanent Ladder Cable System is designed to provide fall protection when climbing or descending ladders or vertical structures up to 300' in height. Applications include telecommunications towers, light poles, water towers, hydroelectric towers, stacks, and any other climbable structure. The Sure-Climb permanent system:

- Includes energy-absorbing, galvanized steel top and bottom mounting brackets
- Uses a 5/16" galvanized steel cable
- Incorporates cable guides to minimize cable vibration and wear
- Uses a stainless steel fall arrester (ordered separately)
- Meets all applicable OSHA regulations and ANSI standards
- CSA certified



Part No.	Description
SFPLS350050	Sure-Climb System 50 ft (16 m)
SFPLS350100	Sure-Climb System 100 ft (30 m)
10040010	Sure-Climb Slider (fall arrester) with carabiner

Additional Lengths available from 20 ft. up to 300 ft. in 10 ft. increments



Sure-Climb Slider
Part No. 10040010

Sure-Climb Slider can be attached and removed anywhere along the length of cable

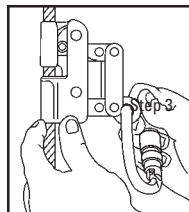
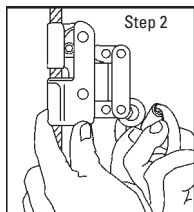
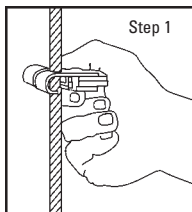

Fall Protection

Dyna-Glide® Climbing Protection System

The Dyna-Glide Climbing Protection Systems are used to prevent and/or arrest falls from heights and also enhance the way a climber is able to perform the necessary work. Our systems can be mounted to already-installed ladders, to corners of lattice towers, and to almost any other suitably strong structure your crew needs to climb.

Whatever configuration works for you, the Dyna-Glide System:

- Limits total fall distance to inches
- Offers components for complete rescue systems
- Allows for vertical and horizontal mobility
- Uses galvanized or stainless steel for corrosion resistance
- Offers your choice of Ladder Rail Combination (LRC) or Rail only
- Provides smooth travel – there's no binding of the fall arrester inside the rail
- Uses detachable, lightweight, stainless steel and aluminum mechanism for hands-free ascent and descent
- Is CSA certified

Taken together, the Dyna-Glide System is designed to be installed without modification to the structure and can be assembled with simple hand tools.



Dyna-Glide LRC in use.



LRC Combination
Part No. 506390

- Rungs incorporate skid resistant surface
- Can be curved or bent for your specific application
- Constructed of galvanized steel
- Standard length: 7' 4-3/16"
- Standard width: 18"



Fall Arrester
Part No. 506277

- Mechanical locking mechanism to reduce fall distance
- Permits hands-free ascent and descent
- Constructed of aluminum and stainless steel
- Carabiner not included

Part No.	CSA Part No.	Description
506270	—	Straight Notched Rail, galvanized, standard length 7' 4-3/16"
506273	—	Rung Mount Assembly, galvanized
506274	—	Gated top end stop, stainless steel
506275	—	Gated bottom end stop, stainless steel
506277	415752	Fall arrester
506282	—	Mounting base angle corner, galvanized
506283	—	Mounting angle corner, galvanized
506312	—	Ungated top end stop, stainless steel
506329	—	Rail connector, galvanized
506388	—	Ladder/Rail Combination (LRC) standoff bracket, galvanized, standard length 7' 4-3/16"
506389	—	LRC standoff bracket, bottom, galvanized
506390	10006461	LRC, galvanized
506391	—	LRC side rail connector, galvanized



For more complete information on the Dyna-Glide System, see the Dyna-Glide Catalog (Bulletin 2300-22-MC).

Temporary Horizontal Lifelines

Temporary Synthetic Horizontal Lifelines

Designed for easy installation and removal, these temporary horizontal lifeline systems were created for a wide range of applications. The system may be mounted to any suitable 5,000 lb-rated anchorage. Both systems can be rigged using many standard components, reducing the need for special or “engineered” equipment.

Dyna-Line® HLL

- Highly visible 12-strand red rope will not hackle and minimizes fall distance due to its low stretch properties.
- Available in a Single-Worker or Two-Worker system.
- Available in lengths up to 200 ft. System comes in a handy bucket for lengths up to 60 ft.
- Meets all OSHA requirements and ANSI A10.32 standards.

Sure-Line™ HLL

- Includes integral energy absorber
- 5/8” black nylon kernmantle rope
- Available in lengths up to 60 ft
- Rated for two workers
- Includes 2 cable anchor slings
- Includes storage bag



Dyna-Line Temporary Horizontal Lifeline for Two Workers Part No. 10013152

Part No.	Description
10013150	Dyna-Line Temporary Horizontal Lifeline for single worker, 30 ft rope
10013151	Dyna-Line Temporary Horizontal Lifeline for single worker, 60 ft rope
10013152	Dyna-Line Temporary Horizontal Lifeline for two workers, 30 ft rope*
10013153	Dyna-Line Temporary Horizontal Lifeline for two workers, 60 ft rope*
SHL1009035BLK	Sure-Line Temporary Horizontal Lifeline, 35 ft black rope
SHL1009060BLK	Sure-Line Temporary Horizontal Lifeline, 60 ft black rope

* Dyna-Line Two-Worker system includes 2 polyester anchorage straps.

Sure-Line Rope HLL Minimum Clearance

Line Length	1-Worker System		2-Worker System	
	6' Lanyard	SRL	6' Lanyard	SRL
10 ft	14'3"	12'5"	14'7"	13'2"
20 ft	15'6"	13'9"	17'	15'
30 ft	17'1"	15'2"	19'4"	16'7"
40 ft	18'6"	16'5"	21'8"	18'4"
50 ft	20'	17'8"	24'2"	20'3"
60 ft	21'5"	19'1"	26'	22'2"

Clearances based on Lifeline 4' above working surface



Sure-Line Temporary Horizontal Lifeline for Two Workers Part No. SHL1009060BLK

Dyna-Line Rope HLL Minimum Clearance

Line Length	1-Worker System		2-Worker System	
	6' Lanyard	SRL	6' Lanyard	SRL
10 ft	14'10"	12'5"	15'10"	13'2"
20 ft	15'9"	13'8"	17'2"	14'9"
30 ft	16'10"	15'1"	19'4"	16'6"
40 ft	18'0"	16'4"	21'4"	18'3"
50 ft	19'3"	17'6"	23'2"	20'1"
60 ft	20'6"	18'9"	25'1"	22'

Clearances based on Lifeline 4' above working surface

Temporary Cable Horizontal Lifeline

Sure-Line™ Temporary Horizontal Lifelines

The Sure-Line temporary Horizontal Lifeline is a lightweight cable system that is suspended between two approved anchor points to provide worker fall protection during horizontal movement. Designed for quick and easy installation at temporary work sites, the Sure-Line system:

- Includes an integral shock absorber
- Available in 20-ft, 40-ft, or 60-ft lengths
- Uses a 3/8", 6x36 galvanized cable
- Available in 2 models, with or without turnbuckle
- Rated for up to 2 people
- Incorporates a combination clamp/thimble that allows for effortless tensioning of lifeline

Part No.	Description
SHL2009040	Steel Cable Horizontal Lifeline System with turnbuckle, 40 ft (12 m)
SHL2009060	Steel Cable Horizontal Lifeline System with turnbuckle, 60 ft (18 m)
SHL2009040IW	Iron Worker Cable Horizontal Lifeline System without turnbuckle, 40 ft (12 m)
SHL2009060IW	Iron Worker Cable Horizontal Lifeline System without turnbuckle, 60 ft (18 m)



Sure-Line Steel Cable System Part No. SHL2009040



Sure-Line Iron Worker Cable System Part No. SHL2009040IW

Sure-Line Rope HLL Minimum Clearance

Line Length	1-Worker System		2-Worker System	
	6' Lanyard	SRL	6' Lanyard	SRL
10 ft	14'1"	12'2"	14'6"	13'2"
20 ft	15'1"	13'1"	16'7"	14'8"
30 ft	16'2"	14'	19'	16'4"
40 ft	17'3"	14'9"	21'	18'
50 ft	18'4"	15'7"	22'7"	19'6"
60 ft	19'5"	16'5"	24'3"	21'4"

Clearances based on Lifeline 4' above working surface

Fall Protection

Permanent Horizontal Lifelines

SkyLink™ HLL STANCHION

- Economical
- Accommodates two workers per system
- Lightweight - weighs only 21 pounds, making it easily installed, removed, and handled by 1 person
- Only a 24-hour cure time required for pour-in-place Pigtail anchor (min. 3,000 psi concrete), so you won't hold up a job or slow down your crew.
- No tools required for installation when using pour-in-place anchor, making it easy to install - sets up in minutes!
- Can be used as single point anchor attachment, providing fall protection for workers while installing horizontal lifelines
- Offers two installation methods to concrete, a pour-in-place anchor for new construction or concrete expansion bolts for existing construction, providing versatility to meet the requirements of your application
- Aluminum and steel construction increases durability to ensure long service life
- Folding leg stanchion design makes the stanchion easy to carry and convenient to store
- No tie-back line required reduces trip hazards
- Meets ANSI A10.32 and OSHA requirements

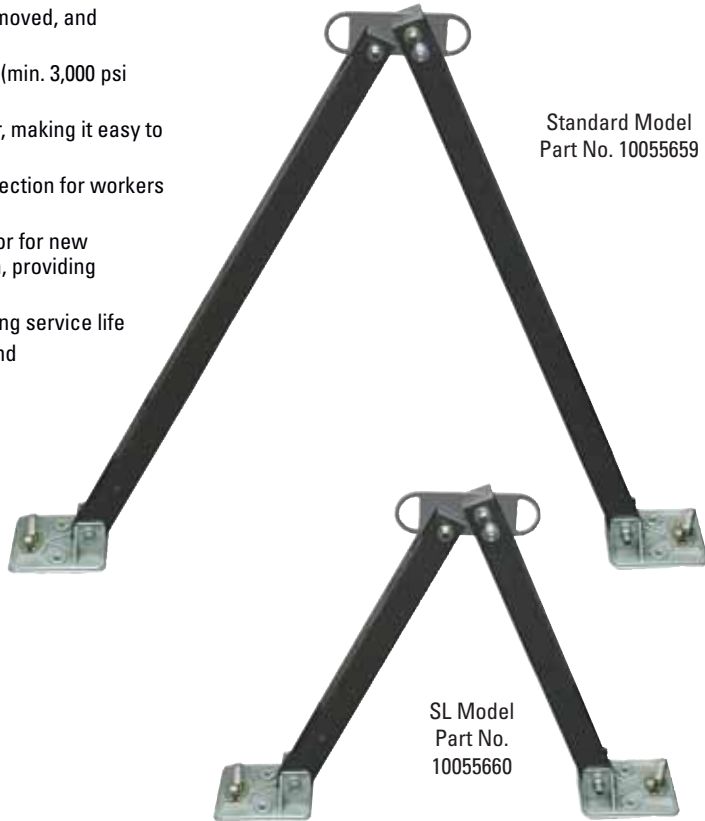

Designed to support horizontal lifelines in two directions (in-line with D-ring head)



Can be used as single point anchor while connecting lifeline

Two possible methods of securing stanchion feet to concrete

Can be attached to concrete using concrete expansion bolts



Can be attached to concrete using integral Speed Nut and Pig-tail anchor



Part No.	Description
10055659	Skylink Stanchion, Standard model - 44" height (pour-in-place Pigtail or concrete expansion anchors must be ordered separately)
10055660	Skylink Stanchion, SL model - 23" height (pour-in-place Pigtail or concrete expansion anchors must be ordered separately)
10055721	3.25" concrete expansion anchor with nut and washer
10059805	0.5" x 12" pour in place "Pigtail" anchor with washer and vinyl cap
10059806	Skylink Stanchion Kit including 2 - Standard stanchions with 60' 2- worker Dyna-Line 10013151 (without anchor straps) and 4 Pigtail anchors
10059807	Skylink Stanchion Kit including 2 - Standard stanchions with 60' Sure-Line for Iron Workers (p/n SHL2009060IW), and 4 Pigtail anchors
10059808	Skylink Stanchion Kit including 2 - SL stanchions with 60' 2- worker Dyna-Line (p/n 10013153 - without anchor straps) and 4 Pigtail anchors
10059809	Skylink Stanchion Kit including 2 - SL stanchions with 60' Sure-Line for Iron Workers (p/n SHL2009060IW), and 4 Pigtail anchors

D6 HLL STANCHION

The D6 HLL Stanchion is an anchorage connector used for the installation of horizontal lifeline systems. Designed with a jaw clamp screw, D6 HLL Stanchions are easily installed on steel girders or base plates fitted to bridge rail ties to provide a strong stable connection point for the approved horizontal lifeline system. The D6 HLL Stanchions can be used as the end or intermediate connection points for either a single or multi-span horizontal lifeline system.

Anchorage Bracket Also Features:

- Engineered A-frame design
- Constructed of galvanized steel
- Jaw clamp screw allows for quick & easy installation
- Collapsible A-frame for easy transport & storage
- Meets all applicable OSHA regulations & ANSI standards

D6 HLL Stanchion
for Horizontal Lifeline
Part No. SHLARD6A



HLL quickly connects to Stanchion



Jaw clamp screw easily attaches to I-beam flange

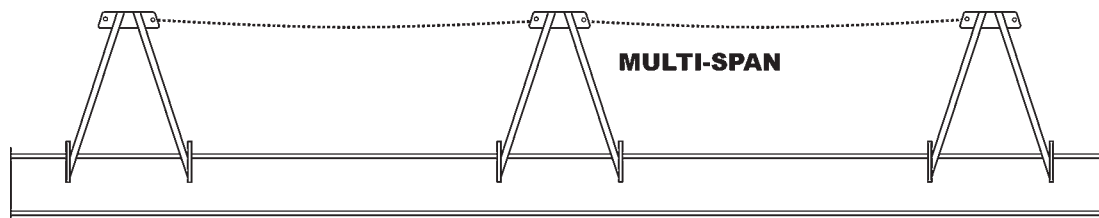
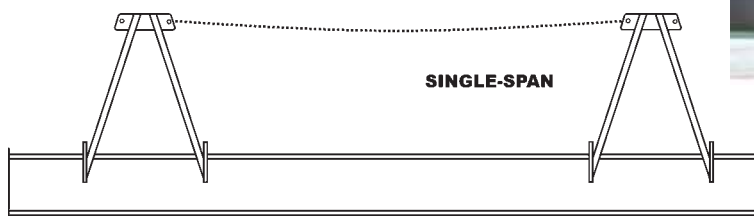

Part No.	Description
SHLARD6A	D6 HLL Stanchion A-frame design, galvanized steel

Horizon® Horizontal Lifeline

The MSA Horizon Horizontal Lifeline anchorage connecting system is designed for portability, versatility, ease of installation, and ease of use. The system may be mounted to existing overhead steel beams or to newly constructed steel structure where overhead anchorage points are not available. Horizontal travel through intermediate supports is achieved without disconnection of the worker's personal fall arrest system. The system may accommodate up to five persons. The unique shock absorber reduces dynamic forces transmitted to the anchorage points. Stanchion system may be installed on the top or bottom flange of an I-beam. Typical applications include new construction (steel erection), inspection and maintenance operations, loading bays, bridges, overpasses, aircraft hangars, manufacturing, petrochemical, chemical, and food processing plants. Meets OSHA requirements.

Basic Below Beam Mount Sub-System

Parts required for this system: 3 Beamgrips (Part No. depends on size of beam flange); 1 - 415836; 1 - 506648 (30'); 1 - 506636; 1 - 506563; 1 - 506662; 2 - 506637

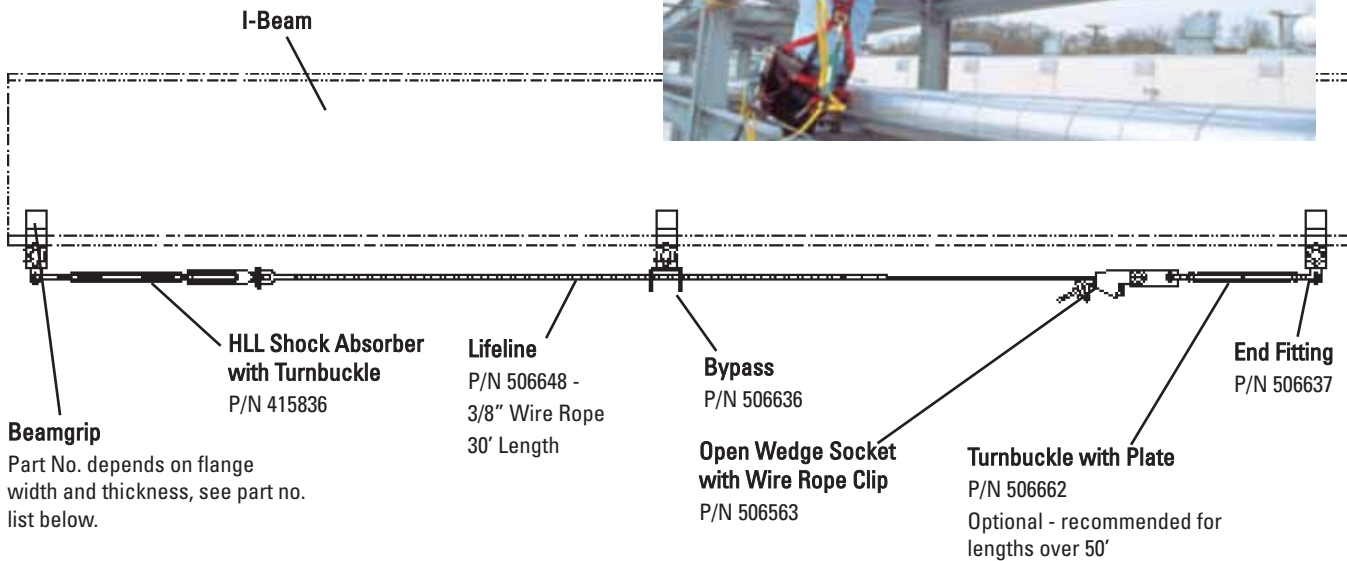

Part No.	Description
506682	Beamgrip for beams with flange width: 3.94" to 5.64", flange thickness: .205" to .659"
415171	Beamgrip for beams with flange width: 5.525" to 8.07", flange thickness: .36" to 1.09"
415172	Beamgrip for beams with flange width: 8.06" to 10.475", flange thickness: .56" to .935"
415173	Beamgrip for beams with flange width: 10.265" to 12.8", flange thickness: .605" to 1.25"
415836	Horizontal lifeline shock absorber
506563	3/8" open wedge socket
506636	Beamgrip bypass fitting
506637	Beamgrip end fitting
506648	3/8" wire rope, galvanized, length must be specified at the time of order
506662	12" turn buckle with plate
506663	Snatch block pulley for 3/8" wire rope
506254	for 1/2" wire rope
506255	for 5/8" wire rope

⚠ WARNING

OSHA regulations state "Horizontal Lifeline Systems shall be designed, installed and used under supervision of a qualified person, as part of a complete fall arrest system, which maintains a safety factor of at least two." A qualified person is defined as "one with a recognized degree or professional certificate and/or extensive knowledge and experience in the subject field, who is capable of design, analysis, evaluation and specifications in the subject work, project or product." MSA can provide a qualified person to design and install a Horizontal Lifeline System. Contact the MSA Engineering Service Department.

FP Rescue™ Pulleys & Components

Suretyman™ Pulleys

Designed to meet the rigorous standards of the professional rescuer. Built with high grade aluminum side plates and sheaves, oilite bearings, stainless steel bolts, washers, and lock nuts make these some of the best pulleys available. The aluminum side plates swivel and rotate to allow the pulley to be attached anywhere along the rope. The top holes of the side plates are large enough to accept three carabiners. Contain Prusik design (squared corners of the side plates) to provide rope security with a Prusik hitch. Pulleys accept 3/8" (1cm) to 1/2" (1.3 cm) static kernmantle ropes. Side plates are powder coated. Strength: 2" (5 cm) Double 8,100 lb (36 kN), 4" Double 11,200 lb (49 kN).

Suretyman™ Mini Knot Passing Pulley

The Suretyman Mini Knot Passing Pulley was designed for the professional rescue team concerned with size and weight. The Suretyman Mini Knot Passing Pulley features:

- Ample room for the passing of knots
- Size: 9-1/2" (24 cm) tall, 4" (10 cm) wide, 3" (7.6 cm) deep
- Aluminum sheave (that will not score like some of the plastic sheaves)
- Locking pin
- Weight: 1.9 lb (.89 kg)
- Half the size and weight of some of the larger, bulkier knot passing pulleys

Suretyman™ Edge Roller

The best way to protect your rope from sharp edges and reduce rope friction. High quality construction. The 6" x 10" (15.3 cm x 24.4 cm) base is rubber covered to reduce slippage. The bottom and side plate feature attachment holes for ease of security in any situation. Added slots in the base plate accept tube webbing for security. Two edge rollers are required (sold separately). Two quick links are required (sold separately). Edge roller is 4" (10 cm) tall. Weight: 2.8 lb (1.3 kg).

SuretyMan™ Q-Eight

- Ears/cleat are positioned to make tie off very easy and safe
- Ears/cleat still prevent larks footing (girth hitch)
- Designed for 7/16" (11 mm) diameter rope (will work with 1/2" (12 mm) diameter rope)
- Aluminum, anodized gold
- Strength 13,000 lbs (58 kN)
- Weight 8 oz (.24 kg)

SuretyMan™ Rescue Eight

- Designed for rope diameters from 7/16" (11 mm) to 5/8" (16 mm)
- Strength 6,720 lb (30 kN)
- Designed for the fire service, rescue, and police tactical operations
- Available in aluminum or steel
- Weight 1.5 lb (675 g)

Suretyman™ Rigging Plates

Stealth Rigging Plate: Anchor on the point and the wings will rotate toward the load for a straighter line of pull. Material aluminum. Weight: .46 lb (250g). Strength: 11,000 lb (48 kN). Color: Teal

Stretcher Rigging Plate: Designed to unclutter and organize litter rigging points, reducing the chance of error. Material aluminum. Weight: .74 lb (330g). Strength: 12,200 lb (54 kN). Color: Teal

Rescue Carabiner

- Traditional large "D" design
- Developed for fire and rescue communities
- Manual locking
- Certified to meet NFPA 1993-1995, Class "G"
- Carbon steel, zinc-plated
- Strength 12,364 lbs (55 kN)
- Weight 11 oz (311g)
- Gate opening 1.2" (32mm)

Part No.	Description
SPPPU8708	Suretyman Pulley, 2" (5 cm) double, Std/Prusik, orange, aluminum, weight: .83 lb (375 g)
SPPPU8717	Suretyman Pulley, 4" (10 cm) double, Std/Prusik, orange, aluminum, weight: 1.8 lb (840 g)
SPPPU8720	Suretyman Mini Knot Passing Pulley, yellow, weight: 1.9 lb (.89 kg)
SPPRL4000	Suretyman Edge Roller, aluminum, weight: 2.8 lb (1.3 kg) - [two required]
SMI420560	Quick Link 5/16" (8 mm) for use with Suretyman Edge Roller - [two required]
SRSF5077	Suretyman Rescue Eight, aluminum
SRSFFE2120	Suretyman Q-Eight
SRSPR5990	Suretyman Stealth Rigging Plate, aluminum, teal
SRSPR5980	Suretyman Stretcher Rigging Plate, aluminum, teal
SRCC641	Carabiner, 1.2" (32mm) gate, steel



Part No. SPPPU8708



Part No. SPPPU8720

Part No. SPPRL4000



Part No. SMI420560



Suretyman Q-Eight
Part No. SRSFFE2120



Suretyman Rescue Eight, Steel
Part No. SRSF5045



Stealth Rigging Plate
Part No. SRSPR5990



Stretcher Rigging Plate
Part No. SRSPR5980

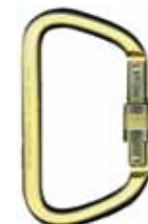

Rescue Carabiner
Part No. SRCC641

Fall Protection

FP Rescue Ropes

Static Kernmantle Ropes

These ropes are 100% permanent solution dyed color with contrasting marker stripe. Superior flexibility and knotability, provided by a unique double-twist cable core construction, gives superior resistance to abrasion that is up to four times greater than other static kernmantle ropes. These ropes are designed with load absorbing capabilities to provide additional safety in the event a dynamic force is applied.

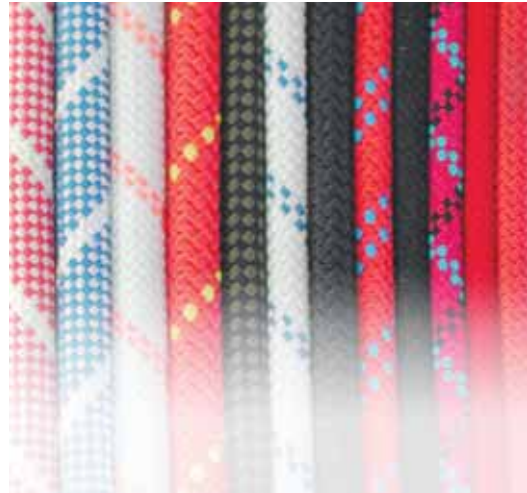

Part No.	Description
SRP508760	7/16" (11 mm), nylon, 6,500 lb (2,948 kg), black
SRP504860SL	1/2" (12 mm), nylon, 9,100 lb (4,128 kg), white/orange tracer
SRP508960	5/8" (16 mm), nylon, 11,400 lb (5,171 kg), black

All ropes are ordered by the foot.

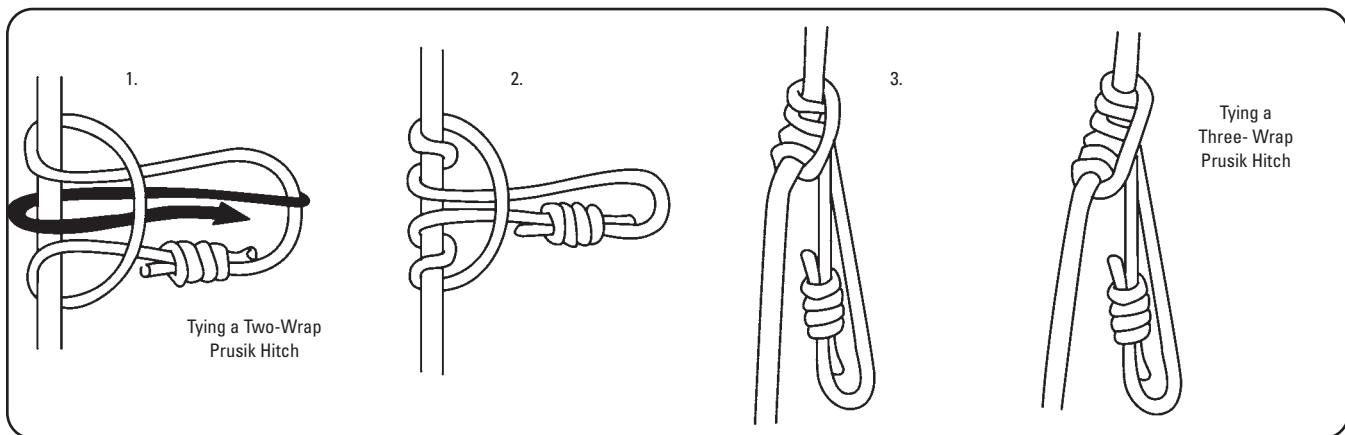

Prusik & Accessory Cords

Prusik cords have the same high quality and long wear design as rescue ropes. Size selection should be based upon diameter of the main line. The flexible cord is both strong and highly resistant to abrasion. Prusik cords and accessory cords are identical.

Part No.	Description
SRP500860	8 mm Accessory Cord, nylon. Use with 1/2"-5/8" (1.3cm-1.6cm) main line, black, 3,100 lb (1,406 kg)
SRP500900	9 mm Accessory Cord, nylon. Use with 1/2"-5/8" (1.3cm-1.6cm) main line, 3,600 lb (1,632 kg)

Rope Storage Bags

Rope Storage Bags are made of tough Cordura nylon fabric. Features include a drawstring top, handle/shoulder strap, and carabiner loops at top and bottom. In the bottom of the bag there is an inside loop for the end of the rope, or it can pass through the bottom grommet. Available in orange and black colors.

Part No.	Description
SRB430101	Rope Bag #1, orange, holds 120-ft / 1/2" (36.6m / 12 mm) rope
SRB430105	Rope Bag #1, black, holds 120-ft / 1/2" (36.6m / 12 mm) rope
SRB430201	Rope Bag #2, orange, holds 200-ft / 1/2" (60.1m / 12 mm) rope

Rope Bag #1
Part No. SRB430105



Rope Bag #2
Part No. SRB430201



FP Rescue TRIPOD

Sure-Strong™ Tripods

Sure-Strong Tripods feature:

- Adjustable aluminum legs
- Two forged steel anchor eyes in head assembly
- Head assembly prevents unintentional collapse of tripod
- Legs adjust and lock individually to accommodate variable anchor heights, uneven ground, and compact storage
- Leg security strap prevents legs from spreading in the event of excessive loading
- Available with a cordura nylon storage bag
- Rated for 2 people with a working load of 1,100 lbs

Part No.	Description
SCE107007	Sure-Strong 7-ft (2m) tripod, aluminum, 10,752 lb (48 kN)
SCE1074411200	Sure-Strong work winch, 200-ft (61m) galvanized wire rope, with bracket (compatible with Lynx Tripod and Sure-Strong Tripod)

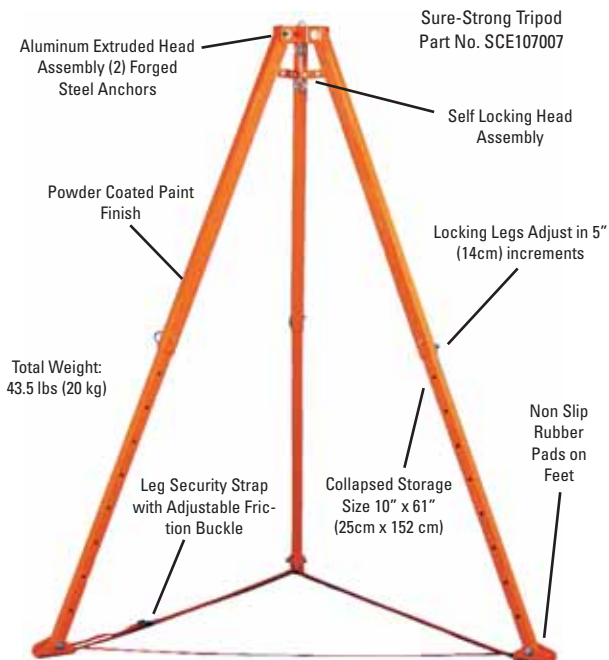

FP Rescue Kits

Bucket Truck Evacuation Kit

The Bucket Truck Evacuation Kit was created to provide all necessary equipment to allow a worker to safely evacuate an aerial bucket that has become inoperative. The kit includes:

- #2 Rope Bag (P/N - SRB430205)
- 10-ft Synthetic Ladder with Swivel Snaphook (P/N - SCE405010)
- Boom Anchor Strap (P/N - SSB22040)
- Anthon system (P/N - SDC726075) which includes Anthon device, Carabiners (2), 75-ft (22m) 7/16" rope

Part No.	Description
SKITSMT001	Bucket Truck Evacuation Kit



Fall Protection

Suretyman™ Rescue Utility System

The Suretyman Rescue Utility System incorporates all the features professionals have come to expect from a first class rescue system. The system is primarily used for raising and lowering people or equipment in rescue and industrial work access and is ideal for confined space applications.

The Suretyman Rescue Utility System features:

- Pulleys equipped with a built-in anti-reversing lock
- Only a 10 lb force is all that is required to hold a 220-lb (90 kg) load
- Suretyman ascender attached to both the operating rope and the user via a securing rope - if the operating rope accidentally releases, the ascender automatically stops the descent
- Rapid deployment
- Virtually maintenance free
- Rated for 2-person load
- Compact and light weight with a standard system weight of 17 lb (7.7 kg)
- Versatile for rescue & access
- Multi-purpose ascent or descent
- Rated capacity of 600 lb (272 kg) for personnel and materials
- Standard rope length of 200 ft (66m) with a maximum rope length of 800 ft (267m)

Part No.	Description
SRS15200	Suretyman Rescue Utility System (200' length)

PLEASE NOTE:

Due to a 4:1 mechanical advantage, the user should order the Rescue Utility System with 4 times the length of rope necessary for their application. For example, the 200' system listed above provides a 50' working length. A 800' system provides a 200' working length.

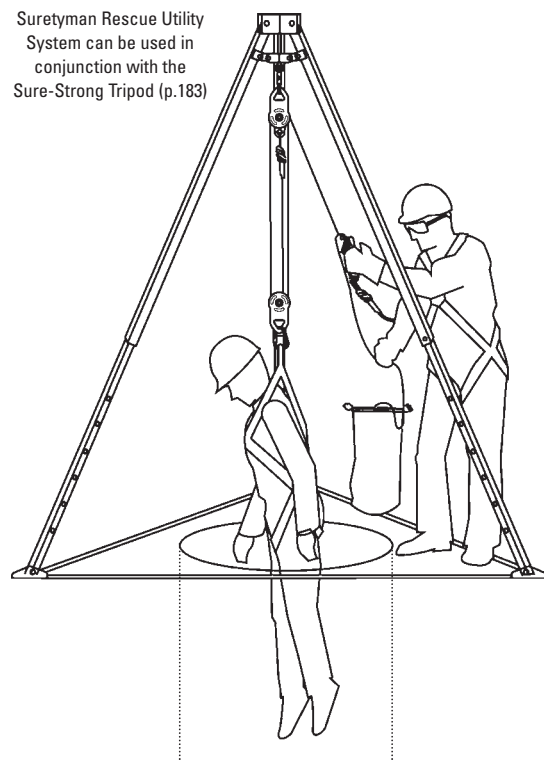

Suretyman Rescue Utility System
Part No. SRS15200

Storage Bag

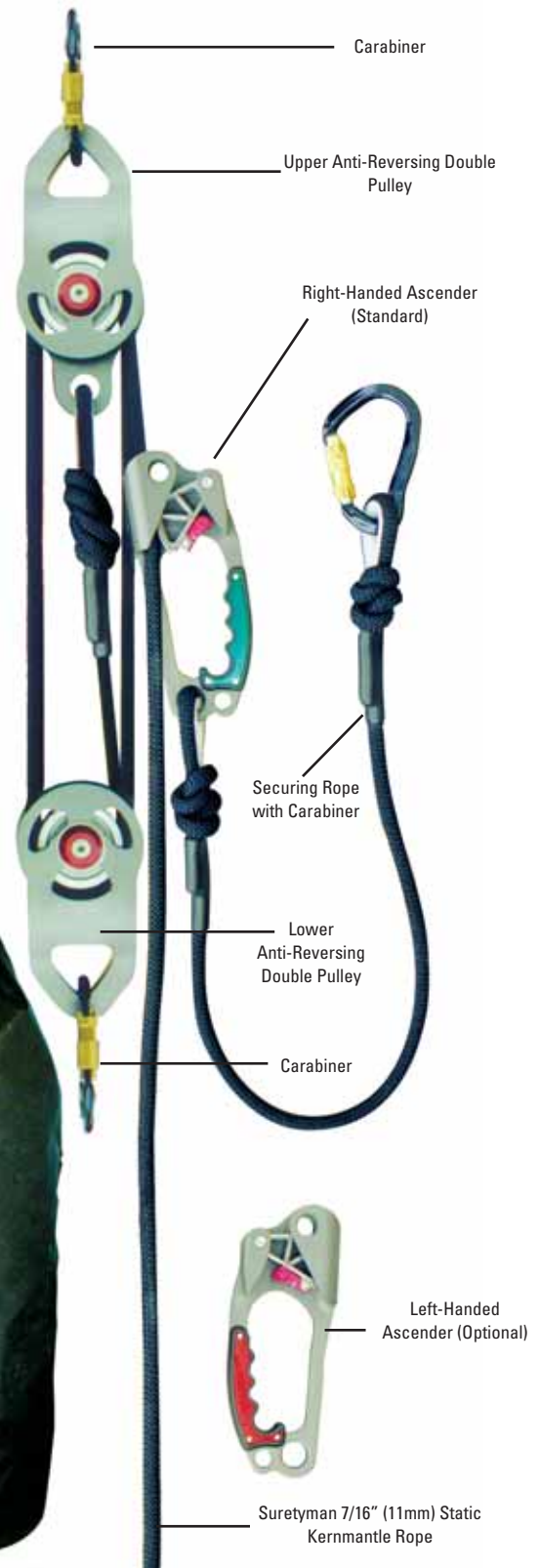

Basic High Angle Rescue Kits

The Basic High Angle Rescue Kits were designed for the Fire Department planning to assemble a high angle rescue team. A complete high angle rescue system consists of two kits: a Belay System Kit, and a Raising/Lowering System Kit.

The Belay system kit includes:

- 3 large "D" shaped rescue carabiners (P/N SRCC641) - NFPA approved Class G
- 200-ft (61m) 1/2" rope, orange and white (P/N - SRP504860SL) - NFPA approved
- 33-ft (10m) 9mm accessory cord (P/N - SRP500900) for making load-release hitch
- 65" (1.65m) 8mm accessory cord & 53" (1.35m) accessory cord (P/N - SRP500860) make-up the tandem Prusiks
- 6-ft (1.8m) Suretyman anchorage sling (P/N - SFP2267406)
- #3 rope bag, orange (P/N - SRB430301)

The Raising/Lowering System includes:

- 6 large "D" shaped rescue carabiners (P/N - SRCA641) - NFPA approved Class G
- Stealth rigging plate (P/N - SRSPR5990)
- 200-ft (61m) 1/2" rope, red (P/N - SRP504863SL) - NFPA approved
- 33-ft (10m) 9mm accessory cord (P/N - SRP500900) for making load-release hitch
- 65" (1.65m) 8mm accessory cord & 53" (1.35m) accessory cord (P/N - SRP500860) make-up the tandem Prusiks
- 53" (1.35m) 8mm accessory cord (P/N - SRP500860) for creating the Prusik for connecting the raising system
- 2 Single Pulleys, 4" (100mm) (P/N - SPPU8710) - Prusik minding pulleys
- Brake Bar Rack (P/N SRS14001) - lowering device is NFPA approved
- 6-ft (1.8m) Suretyman anchorage sling (P/N - SFP2267406)
- #3 rope bag, black (P/N - SRB430305)



Part No.	Description
10030023	Belay System Kit
10030024	Raising/Lowering System Kit

Fall Protection

Emergency Rescue Bag System

The Emergency Rescue Bag System is designed for rescue on electrical and communication towers. Developed for use in restrictive environments, this extremely lightweight system was primarily designed for tower rescue; however, the system can be used to perform rescues on almost any vertical structure. The Emergency Rescue Bag System consists of a pre-rigged lowering System that comes in a variety of lengths. The users of this product must receive training by an approved trainer.

Part No.	Description
SRS323150	Emergency Rescue Bag System, 150-ft (45 m) working length
SRS323300	Emergency Rescue Bag System, 300-ft (90 m) working length

PLEASE NOTE:

Due to a 2:1 mechanical advantage, the user should order the Emergency Rescue Bag System with twice the length of rope necessary for their application. For example, the SRS323150 uses 300' of rope to achieve a 150' working length. The maximum system available provides a 400' working length with 800' of rope.

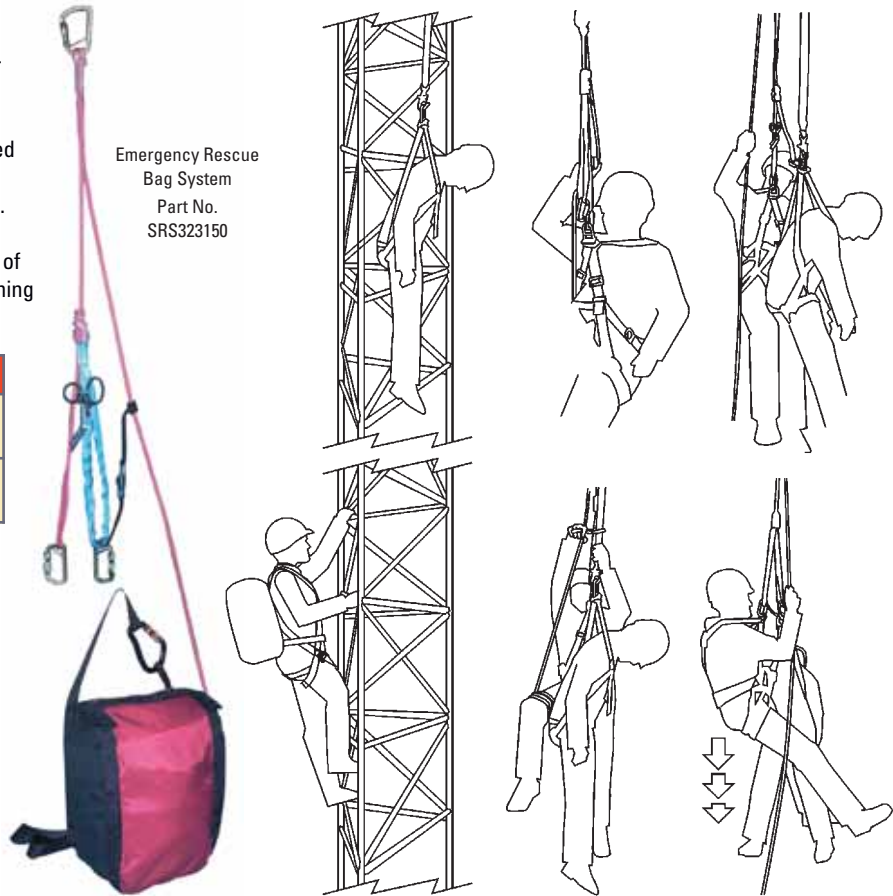

General Accessories

Hands-off™ Chisel Grip

The Hands-Off Chisel Grip keeps hands away from the point of contact. The Hands-Off Chisel Grip is ergonomically designed to match the specific shape of the human hand for a comfortable and firm grip. Additional features of this modern design include:

- Permits faster, safer, more accurate work.
- Easy adjustment to hold a variety of chisels and stakes up to 1" in diameter.
- Vibration-absorbing handle.
- Eases awkward hand positioning.
- Economical.
- Spark resistant.

Part No.	Description
10040018	Hands-Off Chisel Grip



Ergonomic Tool Holders

- Holds wrenches, chisels, etc.
- Vibration-absorbing design
- Attach to broom handles and mops for better grip
- Eases awkward hand positioning

Part No.	Description
507005	Tool Holder, 18"
507006	Tool Holder, spark resistant, 18"



MSA Custom Solutions

Every business is unique, and MSA recognizes that YOUR Fall Protection systems need to be custom-designed and installed to meet YOUR needs.

To help you, we have carefully selected and trained specially qualified contractors, who can personally work with YOU to deliver exactly the services your hazardous situations demand.

These MSA Fall Protection System Integrators are independent organizations throughout North America whose local specialists can provide one or more customized MSA Fall Protection solutions for your business. Your MSA System Integrators will combine their experience and knowledge of practical applications with MSA Fall Protection products to meet your specific needs for any industry, including forestry, construction, oil & gas, petrochemical, mining, manufacturing, utilities, entertainment, and transportation.

Whether you choose complete turnkey services or individual services, you'll receive experienced application and design, fabrication, and installation of whatever MSA Fall Protection systems you need.



Engineering Services

Registered professional engineers will visit your site to analyze and determine the scope of work. Then they will design and draft engineering drawings, and later, follow up with a construction site review to ensure that your Fall Protection system has been installed as designed.

Fabrication

Knowledgeable fabricators will build whatever structural components are required to support your primary MSA Fall Protection system, from simply connecting brackets that attach to your building columns or beams, to assembling complete free-standing support structures. You can trust that your fabricated components will comply with all applicable governing codes and standards.

Installation

Factory-trained and certified installation technicians will execute the design specifications and carry out the manufacturer's instructions. Technicians can also inspect and re-certify an existing MSA Fall Protection system.

Training

High-quality training programs at a reasonable cost will be tailored to the unique issues of your industry and installation. MSA's commitment to increasing demands for technical training in Fall Protection, post-fall retrieval, and rescue will be fulfilled at your facility.

Why Choose MSA Custom Solutions?

- You get the broadest product range, to ensure the best possible fall hazard solution for your specific application.
- MSA System Integrators work directly for you and are responsive to your project requirements.
- MSA System Integrators offer cost-effective services direct to you, the MSA customer.
- You will benefit from dedicated regional System Integrators as well as nationally prominent organizations that specialize in particular industry applications.

How?

It's easy! To receive your quotation from MSA CUSTOM SOLUTIONS:

1. Contact your local MSA distributor, MSA Sales Associate, or call our MSA Customer Service at 1-800-672-2222.
2. Your request will be forwarded to the MSA System Integrator, who will contact you about your project's specific requirements.
3. You will receive a written estimate for your system.

For more information call MSA Customer Service Center at 1-800-672-2222 and request the Custom Solutions Catalog (Bulletin #2300-100)

Fall Protection

Sure-Rail™ Horizontal Lifeline

The Sure-Rail system is a rigid rail horizontal lifeline system typically used in areas when there is limited clearance below the working surface. The Sure-Rail system is available in many standard configurations, but can also be customized to fit your application. The Sure-Rail system provides:

- Ease of movement (smooth trolley action)
- Little or no deflection in the rail limits fall distance and fall arrest forces on the body
- Support for up to 4 workers on the system simultaneously.
- Meets all applicable OSHA regulations

The Sure-Rail horizontal rail system is installed by attachment to intermediate support members that act to stabilize the rail during normal flex and movement of the building structure. The intermediate supports are fabricated from hollow structural shapes (HSS). The HSS supports are connected to the rail by welded tabs at five-foot (1.5 m) intervals. The design of the HSS supports are the responsibility of a qualified engineer familiar with the project and manufacturer's requirements.



Sure-Rail Trolley

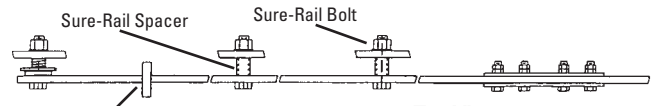
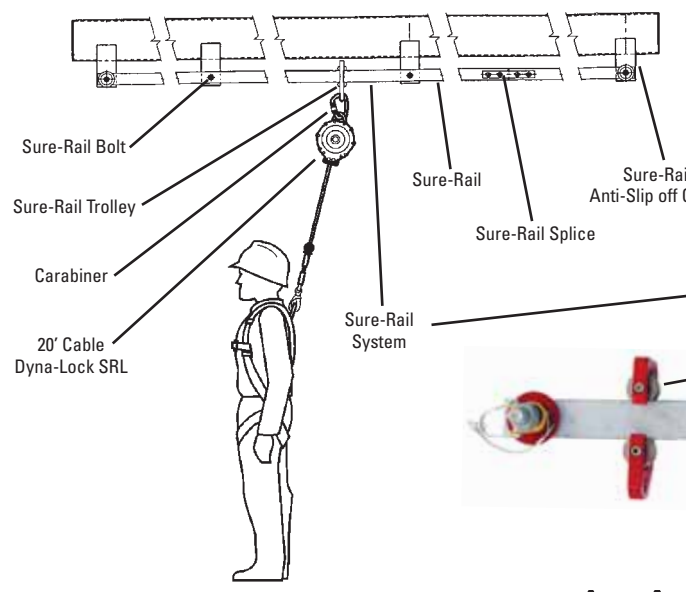

Top View



Side View

Sure-Rail is an engineered system and must be designed, installed, and used under the supervision of a qualified structural engineer, as required by US Federal OSHA and Canadian Provincial regulations.

Latchways Mansafe® Horizontal Lifeline

The Latchways ManSafe Horizontal Lifeline systems are designed to operate horizontally, around corners, and up or down inclines to offer continuous worker protection regardless of the building type or structure.

ManSafe Horizontal Lifeline features include:

- Unsurpassed system flexibility
- Ability to support up to 6 workers per lifeline
- Unique Latchways Transfastener rotates freely through intermediate supports to enable hands-free operation

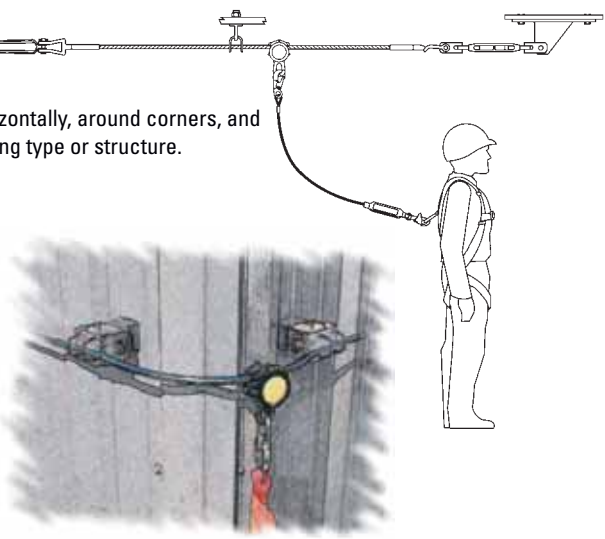

SafeRidge section with traveling eyebolt and endstop.



Saferidge™ System

The patented Saferidge system is designed to provide fall protection on sloped roofs. This unique product combines a fall protection system with the waterproof and venting characteristics of a traditional roof ridge section. Its low profile and unobtrusive appearance can accommodate a wide variety of roof profiles. Advantages of the Saferidge system are:

- Can be installed on new or existing buildings
- Can be installed quickly and easily by your personnel
- Cost-effective – provides a safety system and apex weather proofing in one product
- Accommodates up to 4 workers per system



A complete system consists of the saferidge section, endstops, traveling eyebolt, a full body harness, and a rope grab.

Please call 1-800-672-2222 and let us help you specify the system that will meet your needs.

**HANDS-ON,
COMPREHENSIVE
COURSES**

Learn from the Experts

MSA offers the following Fall Protection training courses:

Fundamentals of Safety At Heights

Topics include:

- Fall hazard recognition
- Basic fall prevention and protection principles
- Selection, application, and use of fall protection systems
- Review of applicable, industry-related standards

Competent Person for Equipment Inspection

Topics include:

- Proper equipment cleaning & storage
- Formal inspection procedure & documentation process
- Review of applicable, industry-related standards

Safety At Heights Program Management & Rescue Planning

Topics include:

- Round-table discussion of fall protection issues
- Writing or reviewing of a current, up-to-date fall protection program or policy
- Planning for an effective and swift rescue
- Selection and use of manufactured rescue systems

Competent Person for Safety At Heights

Topics include:

- Combines Fundamentals, Equipment Inspection, and Management & Rescue courses

Tower Climbing Safety & Rescue

Topics include:

- Selection & application of fall protection systems
- Basic fall protection principles
- Review of applicable, industry-related standards
- Meets both Bechtel and American Tower's current training requirements for tower climbers

New!

Industrial Rescue

Topics include:

- Review of applicable, industry-related standards
- High angle rescue techniques
- Selection, application, and use of rescue systems; such as Raising/Lowering
- Manufactured rescue systems versus rope access rescue systems
- NFPA-approved rope access courses available

New!

Additional Courses

- Confined Space Entry and Retrieval
- Fall Protection & Rescue for Railway Bridges
- Competent Person Refresher
- Competent Person Train-The-Trainer

MSA has also designed many types of custom training courses and interactive training programs for a wide range of industries including:

- Mining Industry
- Automotive Industry
- Railroad Industry
- Utilities Industry
- Telecommunications Industry

With MSA, you have the experts to help you find the best solution for your Safety At Heights training needs.

Registration Information

We invite you to attend our next training session, which will prove to be a comprehensive and valuable experience. For registration information, please contact the MSA Customer Service Center by phone (1-800-672-2222) or by fax (1-800-967-0398), or log onto our web site at www.MSAnet.com.



Hands-on Training for proper fit of a harness at an off-site customer facility.

**Training Centers
Butler, PA
Englewood, CO**

Students simulate falls in Training Structure at the Denver Facility.



**Let us train you
at your facility!**