

FIRE HELMETS CATALOG

2007 – 2008



Cairns
Leather
Helmets



pgs 4 & 7

Cairns
Traditional
Helmets



pgs 5-7

Cairns
Modern
Helmets



pgs 8-9

Wildland T
Helmets



page 17

ClearCommand
HCS
Communication
System



pg 20

Eye, Face
and Hearing
Protection



pgs 13, 18-19

Cairns Fronts
and Accessories



pgs 10-16

Cairns Front
Order Forms and
Replacement Parts



pgs 21-22

Cairns Gifts



pgs 23-24



Top 10 Reasons to Choose Cairns®

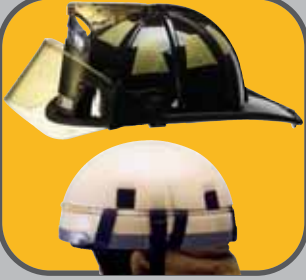

1 Tube-Lock System

This component is instrumental in assisting in absorbing the shock of an impact. This unique design is found only on Cairns helmets. It is part of our complete shock-absorbing system.



2 Shell Release System

A patented safety system only found on Cairns helmets. This design provides an extra margin of safety and protection for the user. Another innovative design from the leader in fire helmets.



3 Crush-Zone Technology

Unique feature designed into our brass front holders. Hollow brass front holders are engineered to help absorb an impact. Front holder is also light, reducing overall helmet weight and providing a better balanced feel.



4 Thermal Protection

Every Cairns helmet provides the extra protection of a thermal impact cap. A Cairns helmet with an impact cap is 66% cooler than a fire helmet that does not have a thermal impact cap. Protect an important part of your body from heat.



5 Impact Protection

Only Cairns offers the most complete system for absorbing an impact. Components work with each other to provide the optimum balance of performance and price. The complete system involves the helmet shell, impact cap, tube-lock and suspension straps.



6 Quality

Cairns helmets are known for their quality from design to manufacture. Compare and "feel" the difference of our 100% handcrafted leather helmets to the durable hardware, and components used on all our fire helmets.

7 User-Friendly

Routine maintenance is easy and fast with Cairns helmets, from easy-to-remove headband liners, to the use of minimal parts in helmet construction.

8 Selection

Cairns offers the most complete line of fire helmets – from leathers to composites to thermoplastic. Just ask for your favorite style.

9 Warranty

Cairns supports our product with a 5-year shell replacement warranty and additional lifetime coverage on components. We lead the way with this warranty.

10 Heritage

Since 1836 Cairns has been designing and manufacturing quality fire helmets. No other helmet manufacturer has our experience and history in fire service.

At Cairns, safety is our tradition. So choose Cairns for the ultimate reason – YOUR safety!

Cairns® Fire Helmets

Through-color shell material to hide minor chips and scratches is available on thermoplastic and fiberglass helmet shells.

Unique shock-absorbing tube. No other helmets provide this type of impact protection.

High-temperature, high-impact, glass-filled, fire-retardant polymer will not corrode or conduct heat or electricity.

High-temperature foam liner for increased thermal and impact protection, combined with a patented shell-release system.

High-temperature, high-impact, glass-filled, fire-retardant, polymer wing protectors add extra reinforcement at the faceshield's weakest point.

High-temperature Nomex chinstrap with quick release and postman's slide enhances performance, safety, and fit.

Velcro stowage for extra chinstrap material.

High-temperature edge trim with a metal core will not melt, drip or burn and adds extra impact protection to the helmet's edge.



Other Features

Patented Shell Release System

Fiberglass*, Kevlar and 660 Models Only

Reduce the chance of neck injury with a shell that is designed to release from the impact cap in the event that it would become lodged during a fall. Although the outer shell releases, the impact cap and earlaps are designed to stay on the user's head for continued impact and thermal protection. Meets NFPA 1971, Rev. 2007, 80 lbs. minimum for release requirement.

* Does not include HP3



Headband System

Excludes Leather Models

Cairns headband features:

- Three-position, rear-ratchet height adjustment to ensure a secure, comfortable fit for all head sizes between 6³/₈ and 8³/₈ (on Model 880, fit is between 5⁵/₈ and 7³/₈ inches).
- An adjustable front headband allows perfect fit between the helmet and a SCBA mask without lifting the helmet or exposing the forehead.



A Few Words About Helmet Performance

Cairns Fire Helmets are designed and manufactured to be durable. All of our leather, thermoplastic, fiberglass, and Kevlar helmets exceed industry standards for heat, impact, and penetration protection. Cairns offers the most diverse line in the industry, so you can choose the helmet that is best for your application.

Leather

Models N5A and N6A

Top-grain steer hide shell, layered with a high-performance thermal impact cap, skillfully hand-tooled by MSA Cairns craftsmen. The only 100% true leather helmet.



Kevlar

Models 1000 and 990

Fiberglass-reinforced Kevlar shell provides maximum thermal, impact, and penetration protection. Available in both modern and traditional styles.



Fiberglass

Models 1010, 1044, 660C, 664 and HP3

Exclusive, Dura-Glas® chip-resistant, through-color, high-performance, high-heat-resistant, compression-molded, fiberglass composite shell. Available in both modern and traditional styles.



Thermoplastic

Models 360S, 660 and 880

Through-color thermoplastic shell combines toughness and durability with NFPA performance. Available in both modern and traditional styles.



All Cairns® Kevlar, Fiberglass, Thermoplastic and Leather N6A Fire Helmets are approved to NFPA 1971-2007. The Leather N5A is OSHA approved.

Traditional Helmets



Performance blend of 2 layers of ballistic-grade Kevlar and fiberglass composite.

Classic™ 1000:

Unmatched performance for extreme conditions.



Tough, through-color, Dura-Glas™ fiberglass composite shell resists chipping and cracking.

Cairns® 1010:

The market leader, unparalleled balance and comfort.



Cairns® 1044:

Rugged design for everyday durability.

The Classic 1000, Cairns 1010 and Cairns 1044 Fire Helmets offer the following features and benefits:

- Market-leading 5-year shell replacement warranty.
- Non-corroding, high-temperature-resistant, faceshield/goggle hardware.
- Rugged, high-temperature edge will not melt or drip.
- Easy front headband adjustment for proper SCBA mask fit.
- Simple rear ratchet height adjustment to fit all head sizes.
- Headband (6 3/8 to 8 3/8) fits a wide variety of head sizes.
- Durable helmet hanger fits on large hooks and resists bending.
- Minimal parts for lower service cost and easier maintenance.
- Exclusive shell release system for an extra margin of safety.
- Unique tube-lock system absorbs the shock of an impact.

Pre-Assembled Helmet Part Numbers

The most popular Cairns styles, which are built to stock and more readily available, can be ordered with a Cairns part number. To designate a helmet color, add a **W** (white), **B** (Black), **R** (Red), **Y** (Yellow), **O** (Orange), **C** (Blue) or **G** (Green) after the part number.*

Classic 1000 Standard Helmets

1000FS	Standard Configuration: includes Standard Flannel Cushion Liner, Nomex Earlap, 6" Front Holder & 4" Tuffshield
1000GS	Standard Configuration: includes Standard Flannel Cushion Liner, Nomex Earlap, 6" Front Holder and Cairns Goggle System
1000XS	Standard Configuration: includes Standard Flannel Cushion Liner, Nomex Earlap, 6" Front Holder and ESS Goggle System
1000FD	Deluxe Configuration: includes Leather Cushion Liner, Flannel Crown Pad, PBI/Kevlar Earlap, Carved Brass Eagle 6" Front Holder & 4" Tuffshield
1000GD	Deluxe Configuration: includes Leather Cushion Liner, Flannel Crown Pad, PBI/Kevlar Earlap, Carved Brass Eagle 6" Front Holder & Cairns Goggle System
1000XD	Deluxe Configuration: includes Leather Cushion Liner, Flannel Crown Pad, PBI/Kevlar Earlap, Carved Brass Eagle 6" Front Holder & ESS Goggle System

Cairns 1010 Standard Helmets

1010FS	Standard Configuration: includes Standard Flannel Cushion Liner, Nomex Earlap, 6" Front Holder & 4" Tuffshield
1010GS	Standard Configuration: includes Standard Flannel Cushion Liner, Nomex Earlap, 6" Front Holder and Cairns Goggle System
1010XS	Standard Configuration: includes Standard Flannel Cushion Liner, Nomex Earlap, 6" Front Holder and ESS Goggle System
1010FD	Deluxe Configuration: includes Leather Cushion Liner, Flannel Crown Pad, PBI/Kevlar Earlap, Carved Brass Eagle 6" Front Holder & 4" Tuffshield
1010GD	Deluxe Configuration: includes Leather Cushion Liner, Flannel Crown Pad, PBI/Kevlar Earlap, Carved Brass Eagle 6" Front Holder & Cairns Goggle System
1010XD	Deluxe Configuration: includes Leather Cushion Liner, Flannel Crown Pad, PBI/Kevlar Earlap, Carved Brass Eagle 6" Front Holder & ESS Goggle System

Classic 1044 Standard Helmets

1044FS	Standard Configuration: includes Standard Flannel Cushion Liner, Nomex Earlap, 6" Front Holder & 4" Tuffshield
1044GS	Standard Configuration: includes Standard Flannel Cushion Liner, Nomex Earlap, 6" Front Holder and Cairns Goggle System
1044XS	Standard Configuration: includes Standard Flannel Cushion Liner, Nomex Earlap, 6" Front Holder and ESS Goggle System
1044FD	Deluxe Configuration: includes Leather Cushion Liner, Flannel Crown Pad, PBI/Kevlar Earlap, Carved Brass Eagle 6" Front Holder & 4" Tuffshield
1044GD	Deluxe Configuration: includes Leather Cushion Liner, Flannel Crown Pad, PBI/Kevlar Earlap, Carved Brass Eagle 6" Front Holder & Cairns Goggle System
1044XD	Deluxe Configuration: includes Leather Cushion Liner, Flannel Crown Pad, PBI/Kevlar Earlap, Carved Brass Eagle 6" Front Holder & ESS Goggle System

* Orange, Blue and Green Helmet colors not available for the Cairns 1044 Helmet.

Defender® Visor for Cairns 1010 and 1044 Helmets

new



The Defender Visor for Cairns 1010 and 1044 Helmets offers the following features and benefits:

- Available on both the Cairns 1010 and Cairns 1044 Fire Helmets
- Retractable eyewear system that's ready when you need it
- Available with a new helmet or as user-upgrade kit
- Quick-disconnect for fast lens change-out without the use of tools
- Never lose or misplace your goggles again
- Optically correct lens eliminates peripheral distortion

patent pending

The new **Defender® Visor** for MSA Cairns 1010 and 1044 Traditional Helmets offers eye protection from dust, dirt, and grit. Sleek and attractive construction allows fast, easy raising and lowering of your visor even with gloved hands. This visor's exclusive integral design is retractable for the ultimate in compact convenience. Standard clear and amber Tuffshield visor options are NFPA-compliant.

New Cairns 1010 and 1044 helmet assemblies incorporating the Defender Visor may be ordered through the Traditional Helmets Assemble-To-Order Matrix. A user-installable upgrade kit (includes new impact cap) lets you install the Defender Visor in existing Cairns 1010 or 1044 Helmets yourself.

If you're in the market for a new Cairns 1010 or 1044 Helmet or if you've thought about

replacing your existing impact cap, consider the streamlined advantage of the new NFPA-compliant MSA Defender Visor. Cairns 1010 and 1044 Traditional Helmets offer the perfect combination of durability and performance in a lightweight, high-performance design. Cairns HELMETS once again has incorporated the latest technological advances that firefighters come to expect from the leader.

Standard 1010 Defender Configurations

1010DS	Includes Standard Flannel Cushion Liner, Yellow Nomex Earlap, Silk-Screened 6" Eagle Front Holder and Clear Defender Visor
1010DD	Includes Leather Cushion Liner, Flannel Crown Pad, PBI/Kevlar Earlap, Carved 6" Eagle Front Holder and Clear Defender Visor
1010TS	Includes Standard Flannel Cushion Liner, Yellow Nomex Earlap, Silk-Screened 6" Eagle Front Holder and Tuffshield Defender Visor
1010TD	Includes Leather Cushion Liner, Flannel Crown Pad, PBI/Kevlar Earlap, Carved 6" Eagle Front Holder and Tuffshield Defender Visor

Standard 1044 Defender Configurations

1044DS	Includes Standard Flannel Cushion Liner, Yellow Nomex Earlap, Silk-Screened 6" Eagle Front Holder and Clear Defender Visor
1044DD	Includes Leather Cushion Liner, Flannel Crown Pad, PBI/Kevlar Earlap, Carved 6" Eagle Front Holder and Clear Defender Visor
1044TS	Includes Standard Flannel Cushion Liner, Yellow Nomex Earlap, Silk-Screened 6" Eagle Front Holder and Tuffshield Defender Visor
1044TD	Includes Leather Cushion Liner, Flannel Crown Pad, PBI/Kevlar Earlap, Carved 6" Eagle Front Holder and Tuffshield Defender Visor



Defender Visor in deployed position



Defender Visor in stowed position



Defender Visor color variety

Modern Helmets



Metro 660C®:
Most popular

NFPA-approved, durable fiberglass composite.



Phoenix 660®:

- Dependable, through-color, high-temperature thermoplastic shell.



Invader 664™:

- Rugged, through-color DuraGlas™ fiberglass composite shell.

Intruder 990®:

- Extreme protection, includes 3-layers of Kevlar composite for cut and penetration resistance.



Structural 360S®:

- Lightest structural fire helmet in Cairns line.
- Well-balanced construction for all-day comfort.
- Tough thermoplastic shell for everyday durability.

All Cairns Fire Helmets Listed Here Include the Following Features:

- Market-leading 5-year shell replacement warranty.
- Non-corroding, high-temperature-resistant, faceshield/goggle hardware.
- Rugged, high-temperature edge will not melt or drip.
- Easy front headband adjustment for proper SCBA mask fit.
- Simple rear ratchet height adjustment to fit all head sizes.
- Headband (6 3/8 to 8 3/8) fits a wide variety of head sizes.
- Durable helmet hanger fits on large hooks and resists bending.
- Minimal parts for lower service cost and easier maintenance.

Shell Release System

- Cairns-exclusive system provides an extra margin of safety - demand it!
- Water-based foam for resistance to high heat and flame.

Impact Cap Performance

- Part of a complete helmet system.
- Provides increased thermal and impact protection.
- Tube-lock system, instrumental in absorbing the shock of an impact.

The Metro 660C, Invader 664, Phoenix 660 and Intruder 990 Helmets all feature the Shell Release System.

Pre-Assembled Helmet Part Numbers

The most popular Cairns styles, which are built to stock and more readily available, can be ordered with a standard Cairns part number. To designate a helmet color, add a **W** (white), **B** (Black), **R** (Red), **Y** (Yellow), **O** (Orange), **C** (Blue) or **G** (Green) after the part number.*

Metro 660C Standard Helmets

660CFS	Standard Configuration: includes Standard Flannel Cushion Liner, Nomex Earlap & 4" Standard Faceshield
660CGS	Standard Configuration: includes Standard Flannel Cushion Liner, Nomex Earlap & Cairns Goggle System
660CXS	Standard Configuration: includes Standard Flannel Cushion Liner, Nomex Earlap & ESS Goggle System
660CFD	Deluxe Configuration: includes Leather Cushion Liner, Flannel Crown Pad, PBI/Kevlar Earlap & 4" Tuffshield
660CGD	Deluxe Configuration: includes Leather Cushion Liner, Flannel Crown Pad, PBI/Kevlar Earlap & Cairns Goggle System with Extra Lens
660CXD	Deluxe Configuration: includes Leather Cushion Liner, Flannel Crown Pad, PBI/Kevlar Earlap & ESS Goggle System

Invader 664 Standard Helmets

664FS	Standard Configuration: includes Economy Flannel Cushion Liner, Nomex Earlap & 4" Standard Faceshield
664GS	Standard Configuration: includes Economy Flannel Cushion Liner, Nomex Earlap & Cairns Goggle System
664XS	Standard Configuration: includes Economy Flannel Cushion Liner, Nomex Earlap & ESS Goggle System
664FD	Deluxe Configuration: includes Leather Cushion Liner, Flannel Crown Pad, PBI/Kevlar Earlap & 4" Tuffshield
664GD	Deluxe Configuration: includes Leather Cushion Liner, Flannel Crown Pad, PBI/Kevlar Earlap & Cairns Goggle System with Extra Lens
664XD	Deluxe Configuration: includes Leather Cushion Liner, Flannel Crown Pad, PBI/Kevlar Earlap & ESS Goggle System

* Orange, Blue and Green Helmet Colors not available for Invader 664 Helmet

Structural 360S Standard Helmets

360SFS	Standard Configuration: includes Economy Flannel Cushion Liner, Nomex Earlap & 4" Standard Faceshield
360SGS	Standard Configuration: includes Economy Flannel Cushion Liner, Nomex Earlap & Cairns Goggle System
360SXS	Standard Configuration: includes Economy Flannel Cushion Liner, Nomex Earlap & ESS Goggle System

* Green Helmet Color not available for Structural 360S Helmet

Rescue Helmets



Commando® HP3:

- Low-profile design is ideal for EMS and rescue operations.
- Full foam impact cap used for increased impact protection.
- Durable fiberglass shell resists cracking and chipping.



Rescue 360R:

- Lightweight, low-profile performance
- Through-color, thermoplastic shell

All Cairns Fire Helmets Listed Here Include the Following Features:

- Market-leading 5-year shell replacement warranty.
- Non-corroding, high-temperature-resistant, faceshield/goggle hardware.
- Rugged, high-temperature edge will not melt or drip.
- Easy front headband adjustment for proper SCBA mask fit.
- Simple rear ratchet height adjustment to fit all head sizes.
- Headband (6 3/8 to 8 3/8) fits a wide variety of head sizes.
- Durable helmet hanger fits on large hooks and resists bending.
- Minimal parts for lower service cost and easier maintenance.

The Assemble-to-Order (ATO) System

The ATO system is easy to use, allowing you to order the right configuration to fit your needs. The ATO system allows you to “build” your own helmet by creating a feature-specific part number. Each character of an ATO part number represents a specific component, so the entire number describes the finished helmet built exactly to your specifications.

Note: A number or letter must be selected for each category. The ATO system is only used to order complete helmets. Spare parts, additional components, etc., must be ordered by specific part number.

Model	Color	Eye Protection	Headband Liners	Earlaps	Chinstrap	Trim Type	Trim Color ^x	Trim Shape
1 990 Intruder	1 Black	0 None*	1 Economy Flannel	1 Yellow Nomex	1 Nomex with Quick Release	0 None*	0 Standard (Lime/ Yellow)	0 Standard
2 660C Metro	2 Red	1 4" Tuffshield	2 Standard Flannel	2 Yellow Nomex with Underchin Extension	2 Nomex with Quick Release & Postman's Slide	1 Glo Flex	1 Lime/Yellow	1 Tetrabar
3 660 Phoenix	3 Blue†	2 Cairns ESS Goggles	3 Deluxe Leather with Crown Pad	3 PBI/Kevlar	3 3" longer Nomex with Quick Release & Postman's Slide (360 Only)	2 Reflexite (Standard)	2 Red/Orange	2 Bar
5 HP3	4 White	3 Cairns Goggles		4 PBI/Kevlar with Underchin Extension	4 Nomex with Postman's Slide (Not available on HP3)	3 Scotchlite	3 Blue	3 Diamond
6 Commando	5 Yellow	4 ESS Innerzone 3 Goggles		5 Bloodborne Pathogen Resistant	6 6" longer Nomex with Postman's Slide		4 White	4 Triple Trim
6 360 Structural	6 Orange‡	5 ESS Innerzone 2 Goggles		6 Yellow Nomex Winter Hood	7 3-Point with Quick Release (HP3 only)			
7 360 Structural without Edge Bead	7 Green††	6 ESS Innerzone 1 Goggles		7 PBI Winter Hood				
A Invader 664		7 4" Standard Faceshield		8 CFR Aluminized Bonnet with PBI/Kevlar Shroud & Nomex Earlap				
B Rescue 360R		8 6" Standard Faceshield		A Black Nomex				
		9 4" Gold-Coated Faceshield**						
		A 6" Gold-Coated Faceshield						
		B ESS Striketeam XTO Goggle**						

* Not NFPA approved
 † Not available on 360, 660 Phoenix
 ‡ Not available on Invader 664
 ** Available only on 360 and HP3
 x Not all colors available in all types and shapes



Faceshields not available on Rescue 360R Helmets.

Cairns Accessories

Standard Fronts

Made with your choice of high-gloss patent leather or dull-finish genuine leather reinforced with a high-temperature, shrink-resistant back layer and sewn with high-temperature, fire-retardant Nomex thread.

The Choice Is Yours!

Standard fronts offer over 27 million possible configurations! Design your own standard front by choosing from the options and then indicating your preferences by calling 1-877-MSA-FIRE to place your order.

Legend

(AG) Attached Graphics = Choice of raised or sunken numbers, sunken fleur-de-lis, metal badges and decals.

(PG) Printed Graphics = Choice of printed graphic symbol or number.

(NG) No Graphics

Top Layer

- Available in low-gloss 100% natural leather or high-gloss patent leather
- Both leathers available in your choice of 8 colors: white, red, black, blue, yellow, green, orange or gold leaf

Print Layer

- Available in 8 colors of high-temperature nylon: white, red, black, blue, yellow, green, orange or gold foil
- Also available in reflective Scotchlite™ (white only)



Lettering

- ½ tall, except on Mini Fronts
- Maximum of 4 lines with up to 14 characters per line
- Available in 8 colors: white, red, black, blue, yellow, green, orange or gold foil
- Also available in reflective Scotchlite™ (white only)

Graphics

- Choose from: attached raised numbers, attached sunken numbers, printed numbers and letters, printed graphics, attached graphic decals or attached metal ornaments (shown)

Accountability Systems

- Improve department accountability with simple numeric identification inserts
- Meets NFPA 1971-2007
- High-temperature, fire-resistant hook-and-loop attachment for easy placement and removal
- Available in all front piece color choices or in white reflective Scotchlite™ for higher visibility



#AS006 1 ½" x 2 ½"



#AS007 3 ¾" x 1 ¼"

6" Passport Accountability System

This system consists of three removable patches: 1 for the front itself and one for each side of the helmet



#62 Frame with 3 Inserts
#60 Frame only



#61 One Insert only

FDNY 6" Front

This system consists of a removable pinned insert and frame.

- Available with sunken, raised or printed numbers only.
- If front and insert colors are different, order the frame and insert separately.



#42 Frame and Insert
#43 Frame only



#44 Frame and Insert
#45 Frame only



#46 Frame and Insert
#47 Frame only
#48 Insert only

Passport 4", 5" and 6" Fronts

This system consists of a removable hook-and-loop insert and frame.

- Available with printed numbers and letters.
- 5" fronts for new 880 Tradition Helmet only



#49 Frame and Insert
#50 Frame only
#51 Insert only



#55 Frame and Insert
#56 Frame only



#52 Frame and Insert
#53 Frame only
#54 Insert only



#58 Frame and Insert
#59 Frame only
#57 Insert only

Reflective Shapes and Numbers



Glo-Flex



Scotchlite



Reflexite

Scotchlite Colors: Lime/Yellow, Red/Orange*





Scotchlite Tetrahedron Triple Trim Colors: Lime/Yellow, Red/Orange

Reflexite Colors: Lime/Yellow, Red/Orange*

Glo-Flex Color: Lime/Yellow*

* Available on OSHA helmets only.

Shapes

Shape	Reflexite	Scotchlite	Glo-Flex
Tetrahedron 	RP20P	SP20P	GP20YP
Diamond 	RP12P	SP12P	GP22YP
Tetra Bar 	RP17P	SP17P	GP17YP
Bar 1" x 4" 	RP16P	SP16P	GP16YP
Tetrahedron Triple Trim (R/O)		10062655	—
Tetrahedron Triple Trim (L/Y)		10062656	—

Numbers

Size	Material	Part No.
1"	Reflexite	RP100P
	Scotchlite	SP100P
1 ¼"	Scotchlite	SP125P
2"	Reflexite	RP200P
	Scotchlite	SP200P
2 ¼"	Scotchlite	SP225P

8" PARADE FRONTS

For use on G5A presentation leather helmet (Parade-style Eagle required)



6" FRONTS (for use on all traditional helmets)

5" FRONTS (for use on 880 Tradition fire helmet only)

Note: The styles depicted below are shown on 6-inch fronts, but may be ordered for both 6-inch and 5-inch fronts. A sample 5-inch front is shown at right.



4" FRONTS

For use on modern helmets

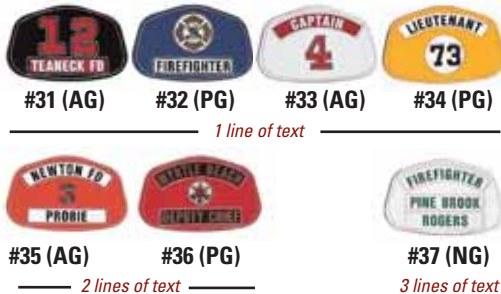

3" MINI FRONTS

For keychain and mini helmet gift items



FRONT PIECE HOLDERS



1 Silk-Screened Eagle	Leathers (1010, 1000, 1044)	M9P
	880 Tradition (6" Front)	10049738
	880 Tradition (5" Front)	10049736
2 Carved Brass Eagle	Leathers (1010, 1000, 1044)	M8P
	880 Tradition (6" Front)	10065952
3 Maltese Cross	Leathers (1010, 1000, 1044)	M6P
	880 Tradition (6" Front)	10049739
	880 Tradition (5" Front)	10049737
4 Carved Parade Eagle	Parade-style (8" Front)	M7P
5 Brass Beaver	(6" Front)	10071258

GRAPHIC CHOICES FOR STANDARD FRONTS

Unless otherwise noted, all graphics are available as your choice of: color-printed graphic, attached graphic decal, 14K gold badge or chrome badge. Badges are available only in choices A-K. To discuss your custom artwork or logo application needs, please call 1-877-MSA-FIRE.

BADGES

available in graphic choices A-K

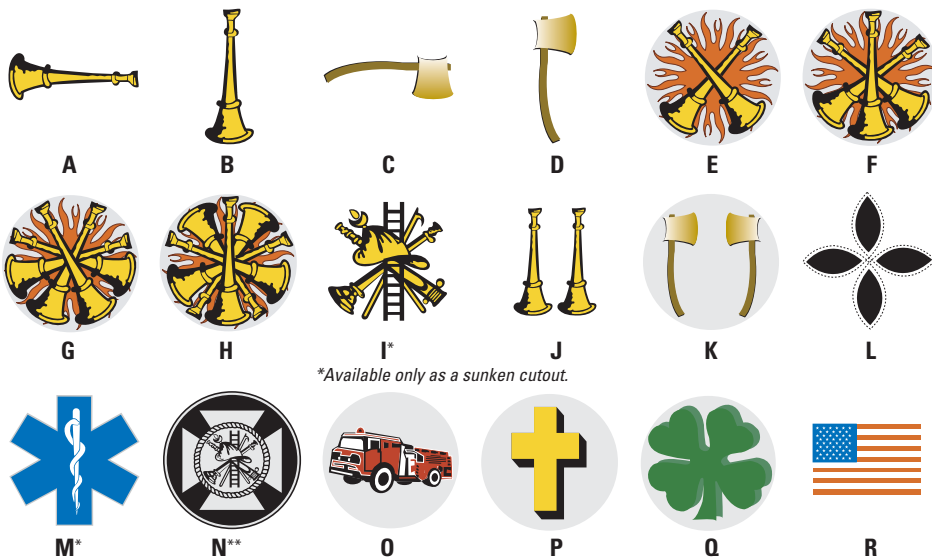

*Available only as a sunken cutout.

* EMS: Available in printed format only.

** Available in tin or as graphic decal. Not available on #35.

Hand-Painted Gold Leaf Fronts

- 24K gold leaf hand-applied to a leather front.
- Hand-painted lettering and graphics have an elegant, traditional look that is especially suitable for presentation helmets.
- Protective clear coat adds durability.
- Quality hand-painting takes time. Please allow 2-3 months.

STANDARD 8" GOLD LEAF

Optional Text: Chief, Commissioner, Chaplain or Captain



Optional Text: Honorary Chief or Chief "Name"

STANDARD 6" GOLD LEAF



STANDARD 4" GOLD LEAF



STANDARD LOGOS

Seven stock logos are available. Please call 1-877-MSA-FIRE to discuss your custom artwork or logo applications.

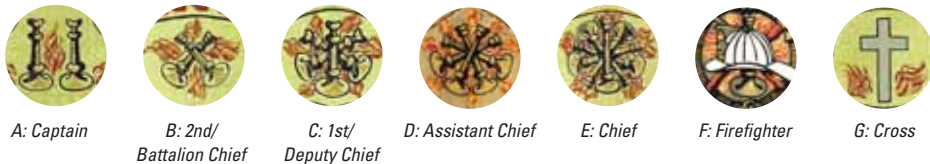

Printed Gold Leaf Fronts

- Printed, hand-drawn artwork on 23K gold background in your choice of three styles.
- High-temperature materials are stable up to 500° F.
- Standard designs available in 2-3 weeks. Custom designs are available at an additional charge.

Ordering is Easy!

1. Choose the background you want: 23K satin gold leaf, 23K turned gold leaf or white with gold accents.
2. Choose the design you want: classic scrolls, classic banners or flaming scroll.
3. Choose the number of lines of text you want from 1-4.



Please call 1-877-MSA-FIRE to discuss your custom artwork or logo applications.

STANDARD 8" PRINTED GOLD LEAF



STANDARD 6" PRINTED GOLD LEAF



STANDARD 4" PRINTED GOLD LEAF



STANDARD LOGOS Nine stock logos are available. For custom logos, call 1-877-MSA-FIRE.



Hearing Protection

HPE Muff (NRR – 27dB)

Designed specifically for very high noise levels, the powerful Muff/Cap Model is ideal for airfields, power plants and other areas with intense noise. The HPE Muff/Cap Model provides the highest-rated protection available for low-frequency environments. A padded headband and super-soft ear cushions guarantee all-day comfort while ensuring full-time protection.

HPE 10061271

EXC Muff (NRR – 24dB)

The ear muff is so comfortable that you always want to wear it. Unique injection molded inserts provide excellent attenuation and maximum space for the ears inside the cup. Headband model offers force adjustment for individual fit. The helmet-mounted version has a spring design that offers low-pressure tension and a high level of comfort.

EXC 10061229



FormFit™ Disposable Foam Ear Plugs

For users who prefer to dispose of their plugs after each use, the FormFit plug is the answer. Easy to use and affordable, FormFit ear plugs offer very aggressive noise reduction while being very comfortable to wear. Available in corded and uncorded versions, in dispenser boxes of 200 pair.

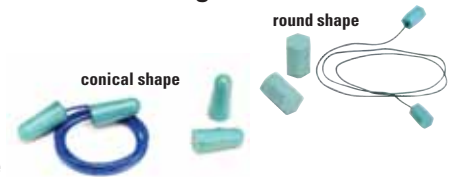

Conical-Shaped Ear Plugs (NRR-29dB)

FormFit Disposable Urethane Foam Ear Plugs (non-corded)
Dispenser Box (suitable for wall hanging)
of 200 individually packaged pairs
10051348

FormFit Disposable Urethane Foam Ear Plugs (corded)
Dispenser Box of 200 individually packaged pairs
10051347

Round Ear Plugs (NRR-31dB)

FormFit Disposable Urethane Foam Ear Plugs (non-corded)
Dispenser Box of 200 individually packaged pairs
10009333

FormFit Disposable Urethane Foam Ear Plugs (corded)
Dispenser Box of 200 individually packaged pairs
10009332

Decals & Title Tapes

All decals and title tapes are available in either vinyl or reflective Scotchlite™. Decal choices are shown below. Custom decals also available.

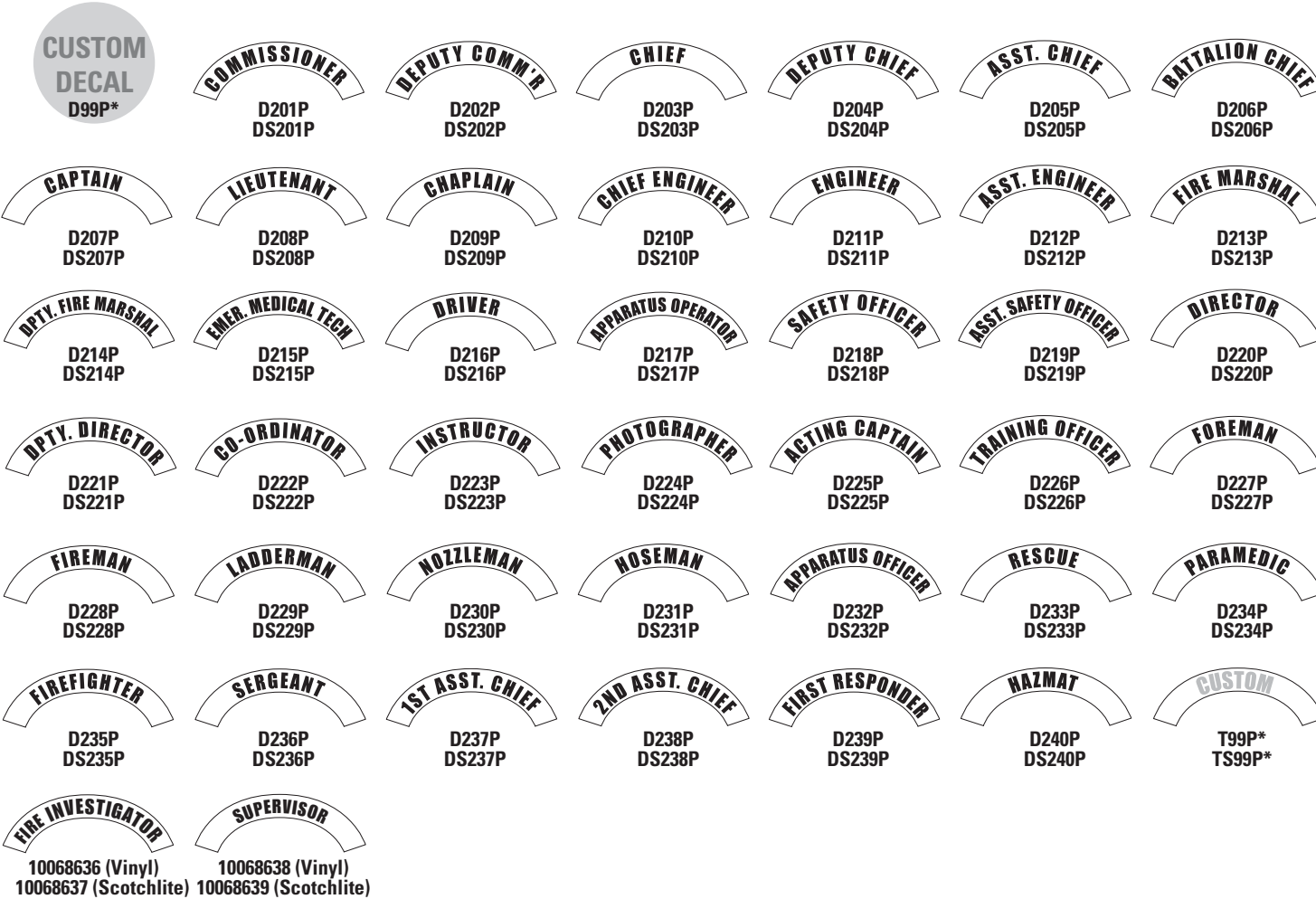
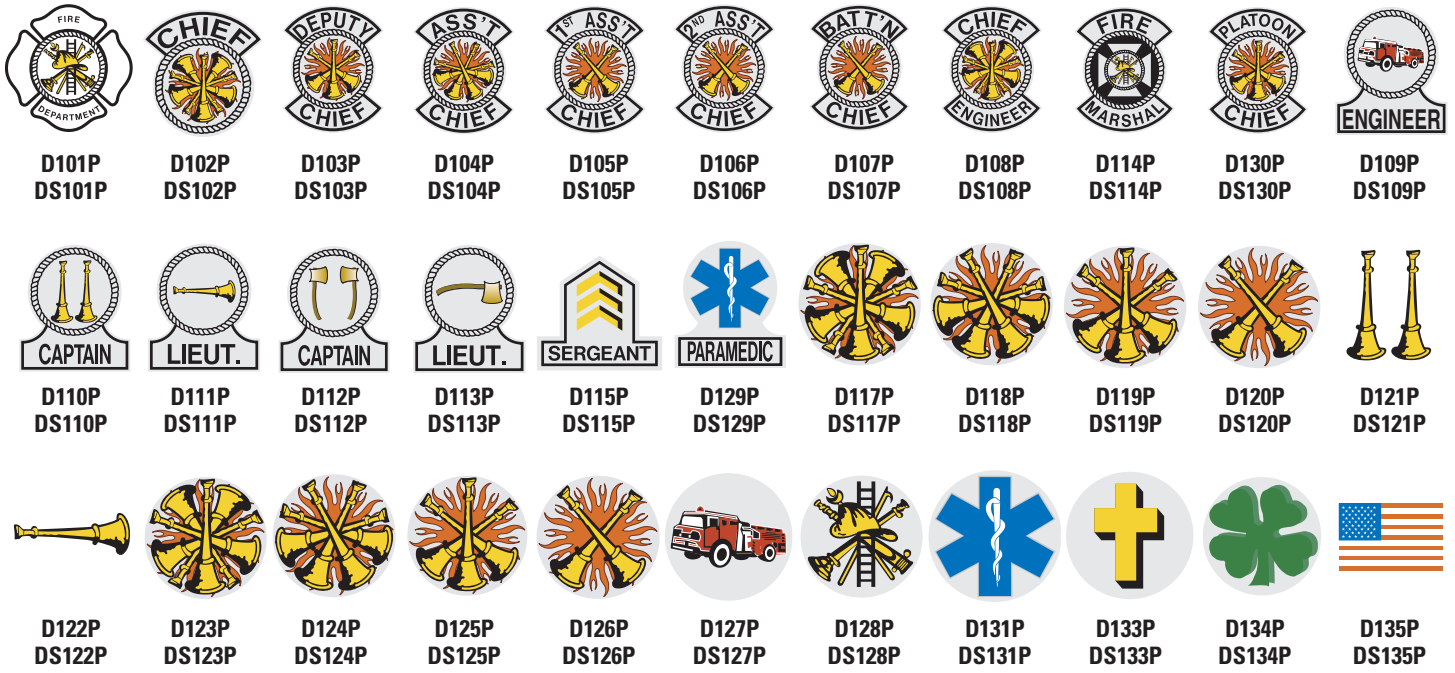

10068636 (Vinyl) 10068638 (Vinyl)
10068637 (Scotchlite) 10068639 (Scotchlite)

* 50 Unit Minimum Required for Custom Decals



Build your own Front at MSAFire.com

Creating your own front is easy! Visit MSAFire.com to build and see your custom front online. E-mail your order to your nearest MSA authorized distributor.

Standard Fronts

Ordering Instructions

Please copy and complete a separate form for each type of front ordered. Give the completed form(s) to your sales representative or fax them to 800-967-0398.

Fronts other than those that can be ordered given the choices below are considered custom fronts. To discuss your custom artwork or logo application needs, please call 1-877-MSA-FIRE or speak with your sales representative.

Company:	_____
Contact:	_____
Phone:	_____
PO #:	_____
<i>For office use only below this line</i>	
SO#:	_____
Shop #:	_____

Standard Fronts

Enter your choices in the boxes to the right of each section.

Total Quantity:

1. Style Option

Enter style number from **10 to 59**, or from **150 to 161**

<input type="text"/>	<input type="text"/>	<input type="text"/>
----------------------	----------------------	----------------------

2. Shipping Option

L – Loose or **A** – Attached

3. Attachment Option

Punch front(-s) or attach to: **L** – Leather Helmet
P – Plastic Helmet or **K** – Mini Front Key Chain
V – Hook and Loop Attachment (for 4" fronts only)
N – No holes needed

4. Front Material

L – Genuine Leather
P – High-Gloss Patent Leather

5. Front Color Option

Choose one color: **B** – Black, **W** – White,
R – Red, **Y** – Yellow, **O** – Orange, **C** – Blue,
G – Green, **N** – Natural/Brown or **K** – Gold (patent only)

6. Insert Color Option

Choose one color: **B** – Black, **W** – White,
R – Red, **Y** – Yellow, **O** – Orange, **C** – Blue,
G – Green, **N** – Natural/Brown or **K** – Gold (patent only)

7. Panel Color Option

Choose one color: **B** – Black, **W** – White,
R – Red, **Y** – Yellow, **O** – Orange, **C** – Blue, **G** – Green,
K – Gold or **S** – Reflective White Scotchlite™

8. Panel Text Color Option

Choose one color: **B** – Black, **W** – White,
R – Red, **Y** – Yellow, **O** – Orange, **C** – Blue, **G** – Green,
K – Gold or **N** – No printed text

9. Graphic Option

For attached graphics (AG):

S – Sunken Numbers (not available on 4" or Passport fronts)
R – Raised Sewn Numbers (not available on Passport inserts)
K – 14K Gold Badge, **C** – Chrome Badge or **T** – Tin Emblem
F – Fleur-de-lis (same as panel color) or **D** – Graphic Decal

For printed graphics (PG):

P – Printed Numbers, **G** – Printed Graphics
or **N** – No Graphics

10. Color of Large Centered Numbers

Size determined by style chosen (not available on gold leaf)
Choose one color: **B** – Black, **W** – White, **R** – Red,
Y – Yellow, **O** – Orange, **C** – Blue, **G** – Green, **K** – Gold,
S – Reflective White Scotchlite™ or **N** – No numbers

11. Graphic Ornament Option

Enter choice from **A** to **R**.

12. Text Font

Choose one text style:

A FULL BLOCK ACCT.	F CASLON ADBOLD	<input type="text"/>
B RAPHAEL ACCT.	G DEMIAN BOLD ACCT.	
C ALPHA MEDIUM	H ACADEMY ENGRAVED	
D COPPER GOTHIC	I BREEZE SCRIPT	
E GOUDY BOLD ACCT.	J CLARENDON MEDIUM	

13. Text

Fill in the appropriate lines of text for your front style up to 14 characters per line. Spaces and punctuation marks each count as one character. Include centered numbers as one line (4 for 6" and 8" fronts; 3 for 4"). Fill in top to bottom.

Standard Fronts

Line 1	<input type="text"/>	<input type="text"/>	<input type="text"/>	<input type="text"/>	<input type="text"/>	<input type="text"/>	<input type="text"/>	<input type="text"/>	<input type="text"/>	<input type="text"/>	<input type="text"/>	<input type="text"/>	<input type="text"/>	<input type="text"/>	<input type="text"/>	<input type="text"/>	<input type="text"/>	<input type="text"/>	<input type="text"/>
Line 2	<input type="text"/>	<input type="text"/>	<input type="text"/>	<input type="text"/>	<input type="text"/>	<input type="text"/>	<input type="text"/>	<input type="text"/>	<input type="text"/>	<input type="text"/>	<input type="text"/>	<input type="text"/>	<input type="text"/>	<input type="text"/>	<input type="text"/>	<input type="text"/>	<input type="text"/>	<input type="text"/>	<input type="text"/>
Line 3	<input type="text"/>	<input type="text"/>	<input type="text"/>	<input type="text"/>	<input type="text"/>	<input type="text"/>	<input type="text"/>	<input type="text"/>	<input type="text"/>	<input type="text"/>	<input type="text"/>	<input type="text"/>	<input type="text"/>	<input type="text"/>	<input type="text"/>	<input type="text"/>	<input type="text"/>	<input type="text"/>	<input type="text"/>
Line 4	<input type="text"/>	<input type="text"/>	<input type="text"/>	<input type="text"/>	<input type="text"/>	<input type="text"/>	<input type="text"/>	<input type="text"/>	<input type="text"/>	<input type="text"/>	<input type="text"/>	<input type="text"/>	<input type="text"/>	<input type="text"/>	<input type="text"/>	<input type="text"/>	<input type="text"/>	<input type="text"/>	<input type="text"/>

ORDERING FORM



Wildland® T Fire Helmets

The Wildland T Firefighters' Helmet from MSA provides excellent protection for workers who fight fires in forests, fields, and woodlands. Both Wildland T hat and cap models can be equipped with a choice of Nomex ear/neck protectors or Nomex ear/neck/throat protectors. The helmets' new ultra-lightweight thermoplastic construction ensures optimum comfort during extended periods of firefighting in the outdoors. They are SEI-certified and meet or exceed all applicable requirements of ANSI Standard Z89.1 (Class E) 1997 and NFPA-1977-1998. For more details, ask for Bulletin 0606-15-MC.

Certified NFPA-compliant.

Third-party certified by:



Wildland T Cap with chinstrap



Wildland T full-brimmed hat with chinstrap

Wildland T Helmet Assemblies

Color	Wildland T Cap w/ Fas-Trac Suspension	Wildland T Hat w/ Fas-Trac Suspension
Yellow	809902	809892
White	809903	809893
Red	809904	809894
Orange	809906	809896
Blue	809905	809895

Replacement Suspensions

Fas-Trac Suspension for cap or hat (6V-8)	473333
---	--------

Wildland T Accessories

Nomex Liners

Nomex ear/neck/throat protector with flame-retardant cotton lining (certified compliant to NFPA 1977-1998)	10028777
Nomex ear/neck/throat protector	10028853
Nomex ear/neck protector with flame-retardant cotton lining	10028778
Nomex ear/neck protector, flame-retardant cotton lining and throat strap	10028779

Goggles and Retainers

InnerZone Three firefighters' goggle	10032882
Goggle retainer for cap	459458
Goggle retainer for hat	449895

Chinstrap

Nomex chinstrap with nylon hooks (attaches to the shell)	10003127
--	----------

Spectacles

Sierra™ protective eyewear, indoor-outdoor mirrored, two-tone temple, light gold lens, very lightweight, UV-400 protection	10018663
Sierra protective eyewear, clear wraparound lens with anti-fog coating	697505
Clearview® protective eyewear, fit over prescription glasses, integrated side shields, clear lens	697502

Hearing Protection

EXC Muff	10061229
----------	----------

Terri Sweatband

Custom Terri-Band sweatband (pkg. of 10)	696688
--	--------

Medical Information Carrier

Put your medical information in your helmet (pkg. of 10)	10013393
--	----------

Faceshield Frame and Visors

Defender faceshield frame	10021615
Metal foldback faceshield frame for cap	488160
Metal foldback faceshield frame for hat	488159
Visor, polycarbonate, clear (formed) 8" x 16" x .060"	488132
Visor, wire screen with aluminum edge, 8" x 17", 20 mesh	457409



Wildland T Cap with NFPA-compliant Nomex ear/neck/throat protector and InnerZone Three Goggle



Wildland T Cap with Nomex ear and neck protector and InnerZone Three Goggle



Wildland T Hat with goggle retainer and firefighters' goggle



Wildland T Cap with Nomex ear and neck protector with throat strap



Wildland T Fire Helmets are available in 5 different colors

Goggles, Faceshields and Proximity Systems for Cairns Fire Helmets



Cairns Goggle

"Military Look," non-vented eye protection that mounts to helmets for easy access. NFPA/ANSI/OSHA approved.

Faceshields

The Cairns 4" Standard Faceshield is standard on all Modern Helmets. (ASTM-D648 melting temperature is 325°F.).



The Cairns 4" Tuffshield, offering superior thermal and scratch resistance, is standard on all Traditional and Deluxe Configuration Helmets. (ASTM-D648 melting temperature is 345°F.).

Other faceshield options include a 4" or 6" CFR Faceshield and an extra-long 4" or 6" Gold Coated Faceshield, made with a heat-resistant polycarbonate lens and coated on the outside with 24K gold for ultra-radiant heat protection.

All Cairns faceshields come supplied with wing protectors for extra face protection. Wing protectors are made of the same fire-proven material found in Cairns' faceshield hardware to provide additional strength at high temperatures.



Bourkes

The original easy-flip Bourkes are available on all Traditional and Leather Helmets. Use for cosmetic purposes only. Provides no eye or face protection.

NFPA Eye Protection

NFPA Goggle System & Hardware	S501P
NFPA Replacement Goggle	S503P
NFPA Replacement Goggle Lens	S506P
4" Tuffshield w/ Wing Protectors	S905P
4" Standard Faceshield w/ Wing Protectors	10037315
6" Standard Faceshield w/ Wing Protectors	S806CP
4" Gold-Coated Faceshield w/ Wing Protectors	S601GP
6" Gold-Coated Faceshield w/ Wing Protectors	S606GP

Bourkes

Bourkes Kit	S10KP
-------------	-------

Crash Fire Rescue (CFR) Proximity System

- Easy to don and doff, this CFR System is compliant with NFPA 1976-2000.
- Designed and approved for use with the Metro 660C, Invader 664, Intruder 990, Cairns 1010, Cairns 1044 and Classic 1000 Fire Helmets, it will not interfere with the SCBA while in use.
- Components consist of an aluminized PBI/Kevlar layer, vapor barrier and inner layer.



Modern Helmet Shown

CFR Proximity System Consists Of:

Bonnet for 660C and 664	10041993
Bonnet for 1010 and 1044	10041992
Shroud for Helmets	10041994
6" Gold-Coated Faceshield	S606G

NFPA Eye Protection is certified as a component on all NFPA-compliant Cairns Helmets. Cairns' NFPA Goggles and Faceshields offer the following features and benefits:

- High-temperature materials are stable up to 500° F.
- Flame-retardant.
- Easy donning and doffing while wearing gloves.

Cairns' NFPA Goggles and Faceshields both offer the following features and benefits:

- Ballistic-grade lens protects against impacts.
- Anti-fog coating on both sides of the lens to ensure visibility.
- Superior anti-scratch coating on both sides of the lens for a longer life.
- Easy lens replacement.

Accessories for Defender Visor

Defender Replacement Lens Assembly

Lens Assembly, Clear, Defender	10077117
Lens, Assembly, Amber Tuffshield, Defender	10077118
Lens, Assembly, Smoke, Defender	10077119
Lens, Assembly, Mirrored, Defender	10077120

Cairns ESS Firefighters' Goggles



MSA's InnerZone series of NFPA-compliant firefighters' goggles are certified by an independent test lab to meet the performance requirements of the NFPA Standard 1971-2007, including the test for exposure to 500° F for 5 minutes.

We offer four styles of ESS goggles:

The **InnerZone One** model attaches to structural helmets. A unique two-piece strap and mounting bracket system interfaces with all structural helmets.

The **InnerZone Two** model has a snap-on/snap-off attachment to structural helmets. The low-profile post design works with all structural firefighting helmets.

The **InnerZone Three** Goggle has a wraparound strap that attaches to the back of the helmet with two adhesive-backed Velcro tabs.

The **ESS Goggle System** has a wraparound strap that attaches to the back of the helmet with a D-Ring fastener.

NFPA Eye Protection

InnerZone One Goggle	S548P
InnerZone Two Goggle	S549P
InnerZone Three Goggle	10032882
ESS Goggle System	S550P
ESS Goggle Tear-Off Lens Covers	S555P
ESS Goggle Replacement Lens	S556P
Cairns ESS Stealth Sleeve	10059535
ESS One and Two Replacement Strap Kit	10059814
ESS Goggle System Replacement Strap Kit	10064534
ESS Strikedown XTO Goggle (non-NFPA)	10068733
Cairns Fire Helmet Bag (Holds four helmets)	10059084

Protective Eyewear for Emergency Services

Aurora™ Protective Eyewear

- Offers complete wrap-around protection
- Available in clear, gray, and amber anti-fog replaceable lenses
- Soft tip straight back temples with vertical ratchet adjustment
- New "Easy-Fit" adjustable nose bridge
- Combines safety with style
- OSHA Eye Protection—certified to be worn with or without NFPA approved protection and meets ANSI Z87.1



Pyrenees™ Protective Eyewear

- Dual injection soft tip temples
- Full side protection
- Translucent gray frames
- Dual lens design
- Available in clear, gray and amber shades
- OSHA Eye Protection—certified to be worn with or without NFPA-approved protection and meets or exceeds ANSI Z87.1



Alpine™ Protective Eyewear

- Lightweight
- Comfortable to wear
- Anti-fog lens
- Available in clear, gray and amber lens
- OSHA Eye Protection—certified to be worn with or without NFPA-approved protection and meets ANSI Z87.1



Arctic™ Elite Protective Eyewear

- Soft tip temples
- Lightweight and low-profile
- Padded nose bridge
- OSHA Eye Protection — certified to be worn with or without NFPA-approved protection and meets ANSI Z87.1



Sierra™ Protective Eyewear

- Full eye protection
- Integrated side shields
- Anti-fog lens (on some models)
- Vented brow guard
- Tuff-Stuff™ scratch-resistant lens
- Adjustable temples
- Teal green, black, or red/white/blue
- Clear, gray, or amber lens nylon frame available
- OSHA Eye Protection—certified to be worn with or without NFPA-approved protection and meets ANSI Z87.1



Tradewind™ Protective Eyewear

- Indoor-outdoor mirrored, light gold or clear lens
- Tuff-Stuff™ scratch-resistant lens
- Adjustable temples
- Brow protection
- Integrated side shields
- UV-400 protection (mirrored lens only)
- OSHA Eye Protection—certified to be worn with or without NFPA-approved protection and meets ANSI Z87.1



Aurora Protective Eyewear

Clear Anti-Fog lens	Gray Anti-Fog Lens	Amber Anti-Fog Lens
10026005	10026006	10026007

Pyrenees Protective Eyewear

Clear Anti-Fog lens	Gray Anti-Fog Lens	Amber Anti-Fog Lens
10033716	10033717	10033740

Alpine Protective Eyewear

Clear Anti-Fog lens	Gray Anti-Fog Lens	Amber Anti-Fog Lens
10041819	10041821	10041822

Arctic Elite Protective Eyewear

Clear anti-fog lens	10038845
Gray anti-fog lens	10038846

Sierra Protective Eyewear

Teal frame with clear anti-fog lens	697505
Black frame with amber lens	10012841
Red/white/blue frame with clear anti-fog lens	10012843
Red/white/blue frame with gray anti-fog lens	10012845

Tradewind Protective Eyewear

Two-tone temple, light gold lens	697506
All black temples, clear lens	10002545

ClearCommand® HCS Helmet Communication System

The ClearCommand Helmet Communication System from MSA is a state-of-the-art radio interface device which significantly improves the user's ability to receive and send messages even in loud ambient-noise environments. It goes wherever you go. The system consists of a helmet-mounted microphone and ear speaker assembly that weighs 5.3 ounces and easily snaps onto the user's fire helmet or industrial-style helmet's ratchet suspension. The helmet mic/ear speaker assembly connects to a lapel microphone or optional stand-alone PTT (push-to-talk) unit. The lapel microphone and PTT are permanently fitted with a connector for attachment to the specific radio of choice.

Features & Benefits

- Incorporates a "noise-eliminating" bone-conduction voice transmitter that virtually eliminates high ambient noise levels.
- Custom user-fitted ear speaker brings all incoming communication directly to the user's ear. No need to lift your lapel mic up to your ear to hear transmission.
- Easily snaps onto the ratchet suspension of fire helmets or industrial-style helmets (Wildland). The unit can be easily transferred to other users, and no tools are required for removal or installation.
- Can be used over the top of facepiece head harnesses, hoods and liners without losing the quality of the transmission.
- The bone-conduction microphone is made of soft silicone material, which makes it comfortable to wear, with no pressure points.
- The helmet microphone assembly can be reversed on the helmet suspension to position the ear speaker on either ear.
- The helmet mic system, when used with the lapel mic or PTT, is powered by the battery from the radio. No need to replace or re-charge dry cells.
- Special connectors suitable for most common radios are available for the lapel microphone and PTT, which allows users to adapt the system to their existing radios.
- The helmet mic is NFPA-certified which allows its use while fighting fires.
- Intrinsic safety approvals allow the use of the helmet communication system in hazardous environments.
- The stand-alone PTT unit is designed for use under hazardous material suits. The large button makes it easy for the user to depress and communicate.
- The helmet mic incorporates a cable keeper which allows for storage of the cable when it's not connected to the lapel mic or PTT.

The ClearCommand Helmet Communication System also offers a plug-in truck communication adapter that can be used by firefighters, along with their helmet microphone assembly, on the way to a fire scene or other incident. Once the firefighter arrives at the scene, the truck system cable is unplugged from the helmet microphone, and the helmet microphone cable end is connected to the user's lapel mic or PTT. The user of the Helmet Communication System has uninterrupted communication from the time the alarm sounds until the incident is over.

For more complete information, see Bulletin 3639-01-MC.



Helmet Microphone Assembly (includes Custom Fitted Flannel Headband Liner)	10042902
Lapel Mic Kits for Radio Interface*	
Maxon SP120, SP130, SP140	10042908
Motorola HT600, MT1000, MTX820, MTX900, Radius P200 & P500	10042909
Motorola HT1000, JEDI, MT2000, MTS2000, MTX838, MT839, MTX8000, MTX9000	10042903
Motorola Astro and Saber	10042904
Motorola Radius GP300, P110, SP50, LTS2000, Spirit-III, GTX, SP21	10042905
Motorola STX, MX800, MX840	10042912
GE Ericsson PCS, PC2005	10042906
GE Ericsson MRK, LPE-200, Prism, PX 126T	10042907
Stand-Alone PTT Kits for Radio Interface*	
Maxon SP120, SP130, SP140	10045667
Motorola HT600, MT1000, MTX820, MTX900, Radius P200 & P500	10045668
Motorola HT1000, JEDI, MT2000, MTS2000, MTX838, MT839, MTX8000, MTX9000	10045662
Motorola Astro and Saber	10045663
Motorola Radius GP300, P110, SP50, LTS2000, Spirit-III, GTX, SP21	10045664
Motorola STX, MX800, MX840	10045669
GE Ericsson PCS, PC2005	10045665
GE Ericsson MRK, LPE-200, Prism, PX 126T	10045666

Truck System	
Nexus Adapter, D. Clarke	10045732
Phonejack Adapter, D. Clarke	10045731
Parts and Accessories	
Remote Finger PTT	10046574
Dust Cover	10046087
Guard Ring, Tall	10046123
Guard Ring, Short	10046122
Belt Clip Assy, Standard	10046089
Belt Clip Assy, Clothes Pin Type	10046120
O-Ring, Single Pin Connector	10046121
Flannel Head Band Liner	10045778

*If your specific radio is not listed above, please contact MSA Customer Service at 1-877-MSA-FIRE.

Replacement Parts for Cairns Fire Helmets

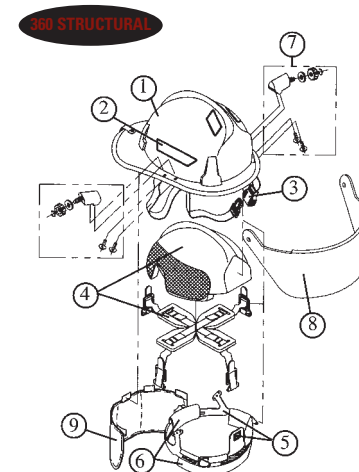
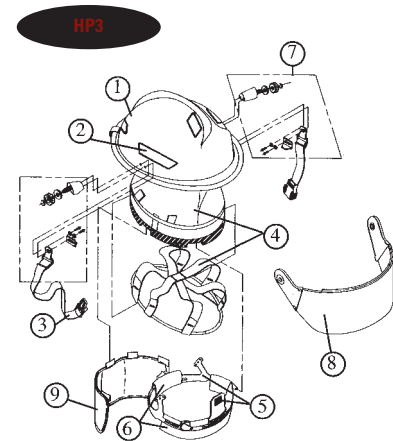
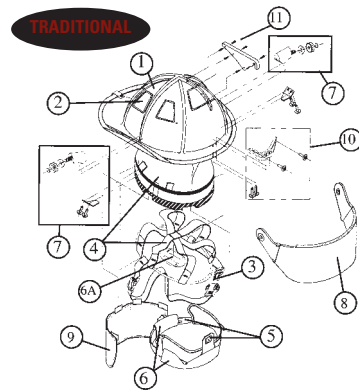
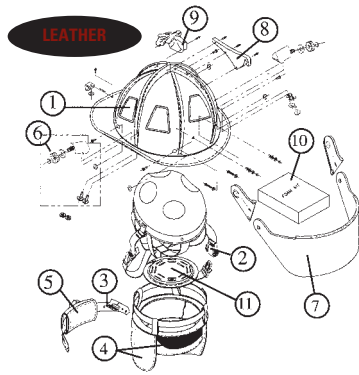

These original equipment replacement parts can be used to maintain or upgrade helmets under NFPA regulations.

Leather

Description	Replacement P/N
1. Reflexite Tetra- Lime/Yellow Scotchlite Tetra- Lime/Yellow	RP20YP SP20YP
2. Nomex Chinstrap w/ QRB & Postman Slide Nomex Chinstrap w/ QRB	C893P C892P
3. Ratchet Headband System	RBP
4. Leather/Sateen Cushion Liner w/ Nomex Earlap Leather/Sateen Cushion Liner w/ PBI/Kevlar Earlap	L5RP L59RP
5. Leather Ratchet Pad	LRPP
6. Faceshield Hardware	S918P
7. 4" Tuffshield, w/ wing protectors Goggle System & Hardware** Replacement Goggle** Replacement Goggle Lens** Cairns ESS Goggle** Replacement Lens** Bourkes	S905P S501P S503P S506P S550P S556P S10KP*
8. Silk Screened Eagle 6" Front Holder Carved Brass Eagle 6" Front Holder	M9P M8P
9. Brass Crown Piece	M10P
10. Foam Adjustment Kit	M560P
11. Foam Crown Pad	FCPP

* Use of these items meets OSHA only, not NFPA. **Not Shown

Commando HP3

Description	Replacement P/N
1. Helmet Shell Complete - See Helmet Shell ATO (pg. 20)	
2. Reflexite Tetra Bars—Lime/Yellow Scotchlite Tetra Bars—Lime/Yellow	RT18YP ST18YP
3. Nomex Chinstrap w/ QRB & Postman Slide Nomex Chinstrap w/ QRB	C892P C893P
4. Impact Cap, Overhead Suspension, Nomex Chinstrap w/ QRB & Postman Slide, RHB, Nomex Earlap & Std. Flannel Liner	M603P
5. Ratchet Headband System	RHBP
6. Headband & Ratchet Liner —Economy Flannel —Standard Flannel —Deluxe Leather	LK27P LK28P LK29P
7. Faceshield Hardware	S620P
8. 4" Standard Faceshield 4" Standard Faceshield w/o wing protectors 6" Standard Faceshield w/ wing protectors 4" Tuffshield w/ wing protectors	10037315P S802AP S806CP S905P
8. Goggle System & Hardware Replacement Goggle Replacement Goggle Lens Cairns ESS Goggle Cairns ESS Goggle Replacement Lens	S501P** S503P** S506P** S550P** S550P** S556P**
9. Nomex Earlap PBI/Kevlar Earlap	655XP L955P

**Not Shown

Traditional Classic 1000, Cairns 1010 and Cairns 1044

Description	Replacement P/N
1. Helmet Shell Complete - See Helmet Shell ATO (pg. 20)	
2. Reflexite Tetra—Lime/Yellow Scotchlite Tetra—Lime/Yellow	RP20YP SP20YP
3. Nomex Chinstrap w/ QRB & Postman Slide Nomex Chinstrap w/ QRB	C922P C923P
4. Impact Cap, Overhead Suspension, Chinstrap w/ QRB & Postman Slide, RHB, Nomex Earlap & Std. Flannel Liner	M604P
5. Ratchet Headband System	RHBP
6. Headband & Ratchet Liner—Economy Flannel Headband & Ratchet Liner—Standard Flannel Headband & Ratchet Liner—Deluxe Leather	LK27P LK28P LK29P
6A. Flannel Crown Pad—included in Deluxe Model	
7. Faceshield Hardware	S918P
8. 4" Tuffshield w/ wing protectors 4" Faceshield w/ wing protectors 6" Faceshield w/ wing protectors Goggle System & Hardware Replacement Goggle Replacement Goggle Lens Cairns ESS Goggle Cairns ESS Goggle Replacement Lens Bourkes & Hardware	S905P 10037315* S806CP* S501P** S503P** S506P** S550P** S556P** S10KP*
9. Nomex Earlap PBI/Kevlar Earlap	L655XP L955P
10. Front Mounting Bracket	M16P
11. Silk Screened Eagle 6" Front Holder Carved Brass Eagle 6" Front Holder	M9P M8P

* Use of these items meets OSHA only, not NFPA. **Not Shown

Structural 360

Description	Replacement P/N
1. Helmet Shell Complete - See Helmet Shell ATO (pg. 20)	
2. Reflexite Tetra Bars—Lime Yellow Scotchlite Tetra Bars—Lime Yellow	RT17YP ST17YP
3. Nomex Chinstrap w/ QRB Nomex Chinstrap w/ QRB & Postman Slide	C892P C893P
4. Impact Cap w/ Overhead Suspension, Chinstrap w/ QRB, RHB, Nomex Earlap, & Economy Flannel Liner	M802P
5. Ratchet Headband System	RHBP
6. Headband & Ratchet Liner —Economy Flannel —Standard Flannel —Deluxe Leather	LK27P LK28P LK29P
7. Faceshield Hardware	S912P
8. 4" Std. Faceshield, w/o Wing Protectors 4" Std. Faceshield, w/ Wing Protectors 6" Std. Faceshield, w/ Wing Protectors 4" Tuffshield, w/o Wing Protectors 4" Tuffshield, w/ Wing Protectors Goggle System & Hardware Replacement Goggle Replacement Goggle Lens Cairns ESS Goggle Cairns ESS Goggle Replacement Lens	S802AP 10037315P S806CP S901P S905P S501P** S503P** S506P** S550P** S556P**
9. Nomex Earlap PBI/Kevlar Earlap	L655XP L955P

**Not Shown

Cairns Gifts



A Cairns 880 Tradition T-Shirt
Ash gray T-shirt with Cairns logo on front and 880 helmet with "The Tradition Continues" slogan on back.

B Cairns Long-Sleeve Woven Shirt
Stylish Cutter & Buck french blue, 100% combed cotton dress shirt. Complete with Cairns logo on front.

C Cairns Classic Polo Shirt
A cotton/poly blend easy care jersey knit polo, full cut and side seamed. Black with red tipping.

D Cairns Classic Polo Shirt
A cotton/poly blend easy care jersey knit polo, full cut and side seamed. Gray with black tipping.

E Cairns Classic Polo Shirt
A peruvian pima cotton Ever-Dri polo. High performance, breathable, moisture-wicking, and wrinkle free. Pewter color.

F Cairns Twill Microfiber Jacket
A 100% peached soft twill microfiber teflon finished black outer shell with pewter piping. Features water and wind resistant polyester mesh lining.

G Cairns Cap
Top-quality Richardson Cap. 100% unstructured black chino with Cairns logo on front.

H Cairns Swisscard Quattro by Swiss Army
The Swiss Army Swisscard features a 4-headed screwdriver bit, letter opener, straight pin, nail file with screwdriver, tweezers, toothpick, ball point pen, and metric/inch ruler, all ingeniously cased in a credit card size black case.

I Cairns 1/2 Liter Stainless Steel Thermos
Double-wall 17 ounce thermos.

J Cairns Stainless Steel Travel Mug
16 ounce double-wall thermal break travel mug.

K Cairns Retractable Gel RT Rollerball Pen
Papermate Retractable Gel Roller RT is true writing experience. Featuring a black translucent barrel, rubber grip, chrome clip, medium point with easy flow, long lasting black ink.

L Cairns Titleist DT Solo Golf Balls
DT Solo features non-cut cover with exceptional softness & feel of the club and around the green.

Order Cairns Gifts Online at MSAFire.com

Click on "Cairns Helmets" and then "Cairns Gear" to order.

Cairns Gifts

N "Leather Forever" Keychain

A pewter replica of a traditional Cairns leather helmet with the "Leather Forever" logo engraved on the underside of the helmet's brim.



O Leather Bucket

Replica of an authentic fire bucket used in the early 1800s. Available as a plain bucket or as a wine cooler bucket (comes with a cover and liner). Approximately 13" x 8".



P Authentic Presentation Helmet

Replica of a turn-of-the-century helmet. For display only. G5A and G64 Leather models. 880 presentation helmet also available.



Q Giant Front Piece

Can be mounted to a wall for presentation.

R Mini Leather Helmets

A scaled-down version of our traditional New Yorker Helmet. Perfect for your mantelpiece, promotions, awards and retirements. Approximately 7 1/4" x 5 5/8" x 4".



S Mini Front Keychains

Unique gift idea, personalized for your needs.

Items shown here not available online. Please order by calling MSA Fire Service Customer Service at 1-877-MSA-FIRE.

Additional Cairns Information

Warranty

Contact the MSA Fire Service Customer Service at 1-877-MSA FIRE or refer to Bulletin No. 3600-09-MC for complete information.

WARNING

Wearing protective equipment without proper training in firefighting techniques, or without knowledge of the proper selection, use and care of protective equipment could result in serious personal injury, or death.

Note: This Bulletin contains only a general description of the products shown. While uses and performance capabilities are described, under no circumstances shall the products be used by untrained or unqualified individuals and not until the product instructions including any warnings or cautions provided have been thoroughly read and understood. Only they contain the complete and detailed information concerning proper use and care of these products.



Bulletin 3600-01-MC
March 2007

©MSA 2007 Printed in U.S.A.

Corporate Headquarters:
P.O. Box 426
Pittsburgh, PA 15230 USA
e-mail info@MSAFire.com
www.MSAFire.com

Fire Customer Service:
Phone 1-877-MSA-FIRE
Fax 1-800-967-0398

MSA International:
Phone (412) 967-3354
Fax (412) 967-3451

MSA Canada:
Phone 800-MSA-2222
Fax 905-238-4151

MSA Mexico:
Phone 52-55 21 22 5770
Fax 52-55 5359 4330

