

MSA Transporter Kit

part no.
10017089

for Port Aire installation

Slide Transporter under Port Aire, ensure Port Aire's carrier is flush against Transporter.

Note

The two brackets that will hold Transporter to the Port Aire are the same.

Turn the top bracket, so the largest slot is facing the top of Transporter.

With the tabs of the bracket on the outside of the Transporter main supports, push the bracket tabs over the Transporter supports and slide the bracket up under the cross support of the Transporter.

Line up the hole in bracket with the hole in the Port Aire carrier.

Place the lock washer on the bolt and insert the bolt and lock washer through the bracket into the Port Aire carrier, tighten finger tight.

Turn the bottom bracket so the largest slot is facing the wheels of the Transporter.

Push the bracket on the Transporter's main supports with the tabs on the outside of the supports.

Slide the bracket (up or down) until the holes of bracket and Port Aire's carrier are aligned.

Insert bolt and lock washer through bracket into Port Aire's carrier until finger tight.

Use a socket to tighten the bolts into the Port Aire carrier. Do not over tighten.

Ensure the Transporter is secured to the Port Aire carrier.

Inspect the bolts for tightness once a month.

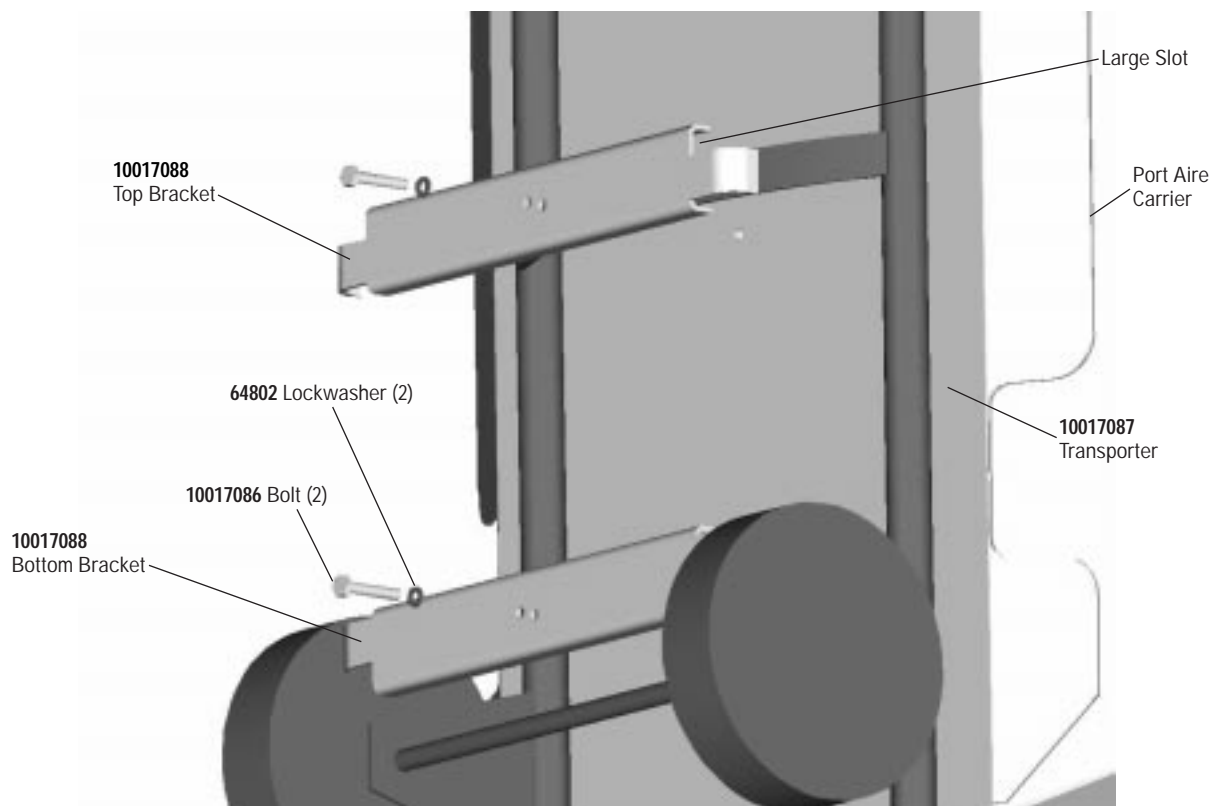

Manufactured by
MINE SAFETY APPLIANCES COMPANY
PITTSBURGH, PENNSYLVANIA, U.S.A. 15230

TAL 999 (L) Rev. 0 © MSA 1999 Prnt. Spec. 10000005196 (A) Mat. 10017252
Doc. 10000006472