

Quick-Fill™ Coupling Replacement Instructions

instructions

⚠ WARNING

Be sure that the cylinder valve is closed and that all pressure has been relieved from the system prior to removing the Quick-Fill Coupling.

1. Placing a 1" open-end wrench (or socket and ratchet) on the Quick-Fill coupling wrench flats, remove the Quick-Fill coupling from the Quick-Fill fitting by turning the wrench counterclockwise.
2. Be sure that the sintered bronze filter (P/N 485574) does not fall out of the Quick-Fill fitting, or get damaged in any way.
3. Apply a thin film of Christo Lube® lubricant to the O-ring of the new Quick-Fill coupling.
4. Be sure that the sintered bronze filter is seated flat at the bottom of the Quick-Fill fitting bore prior to threading the new coupling into the fitting.
5. Hand tighten the coupling, being careful not to cross thread it as it is installed.
6. Using a torque wrench, tighten the coupling to 70-75 lbs. NOTE: you can use the ft. lb. torque wrench with a 1" deep-well socket.
7. Check for leaks using the following procedure:

On the Belt Mounted Apparatus:

- a. Open the Air Mask cylinder valve, fully pressurizing the Regulator Audi-Larm assembly.
- b. Place palm of hand over the regulator outlet firmly to block it leak tight.
- c. Open the regulator mainline valve handwheel fully. The regulator gauge should indicate the pressure in the cylinder.
- d. Close the cylinder valve and watch the pressure gauge on the regulator. There should be no drop in pressure if the equipment is leak tight. If there is noticeable deflection of the needle, check the Quick-Fill coupling for leaks (using Snoop leak detector) and correct before proceeding.
- e. Be sure that the cylinder valve is fully closed, that all pressure is relieved from the system, and that the mainline valve is fully closed.
- f. The Air Mask is now ready for service.

On the MMR Apparatus:

- a. Open the cylinder valve fully.
- b. The remote gauge should indicate the pressure in the cylinder.
- c. Close the cylinder valve and watch the remote gauge. There should be no drop in pressure if the equipment is leak tight. If there is noticeable deflection of the needle, check the Quick-Fill components for leaks (using Snoop leak detector) and correct before proceeding.
- d. Be sure the cylinder valve is fully closed; relieve all pressure from the system by opening the bypass.
- e. After all pressure is relieved from the system, close the bypass fully.
- f. The Air Mask is now ready for service.

8. Install a new dust cover onto the male Quick-Fill coupling.
9. Read and be sure that you fully understand the instructions for operating the Quick-Fill System prior to use. These instructions are detailed in the Quick-Fill System Instruction Manual P/N 487965.

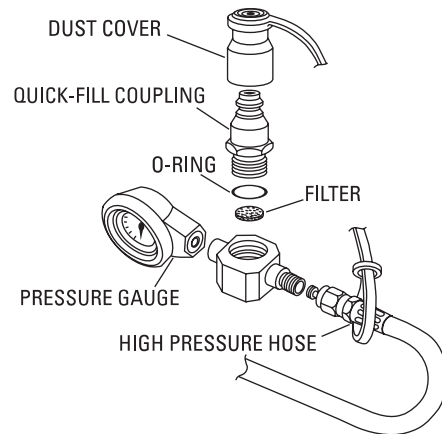

**MMR Apparatus
Shoulder Strap Quick-Fill**

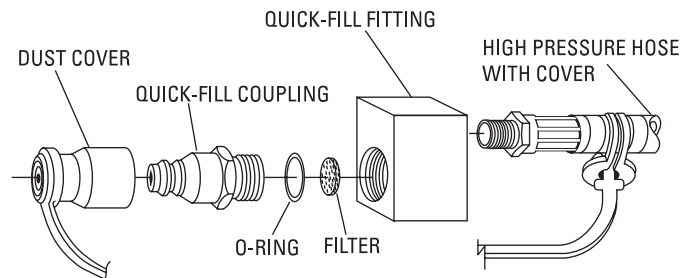

**MMR Apparatus
Belt Mounted Quick-Fill**

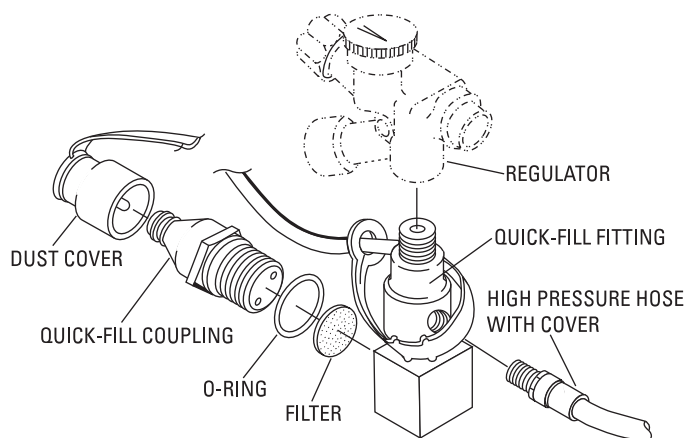

Belt Mounted Apparatus

For More Information, call 1-800-MSA-2222 or Visit Our Website at www.MSAnet.com



MINE SAFETY APPLIANCES COMPANY
PITTSBURGH, PENNSYLVANIA, U.S.A. 15230